

MICROFILMED

PLAT AND RECORD

Of a Survey on Section 34 T 2 R 11 E. of the 4 P. M. in Plymouth Township

Rock County, Wisconsin, made November the 21, 22 & 24 1873

I hereby certify that the following is a correct record of said survey as made by me.

COUNTY BUILDING
CITY OF JANESVILLE

(Signed) Edward Ruger
R. H. B.

County Surveyor.

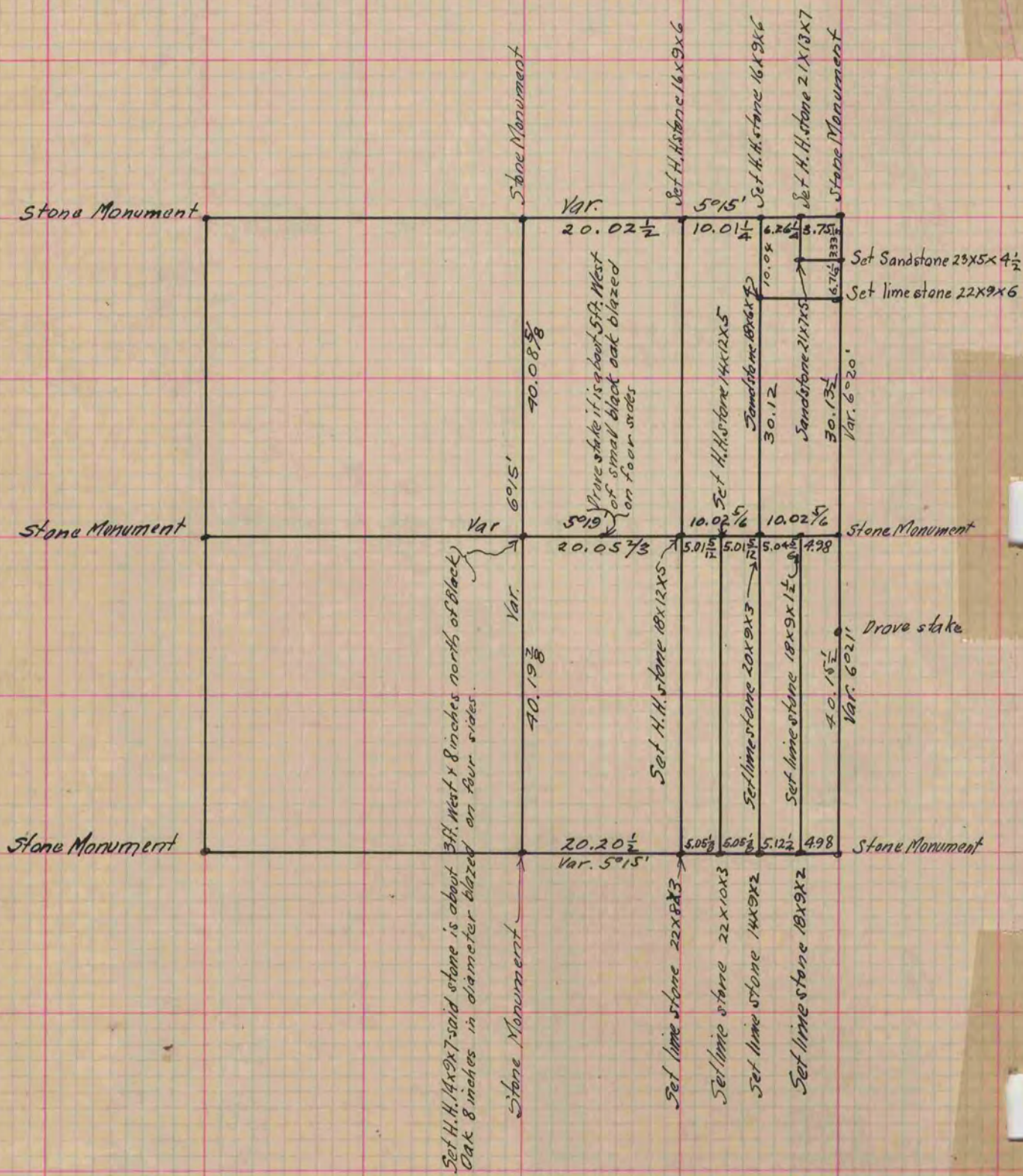

Copied from page 72 Vol. 2 Original County Surveyors Record