

MICROFILMED

PLAT AND RECORD

COUNTY BUILDING
CITY OF JANESVILLE

Of a Survey on Section 3 T 2 R 12 E. of the 4 P. M. in Rock Township

Rock County, Wisconsin, made September the 1865

I hereby certify that the following is a correct record of said survey as made by me.

(Signed) J. D. Locke
R. H. B. County Surveyor.

and Br. 0. S. 18° E 50 (That bears the Government Mark)
and old stake. Set hard head 16x11x7" and surrounded
by 5 hard heads

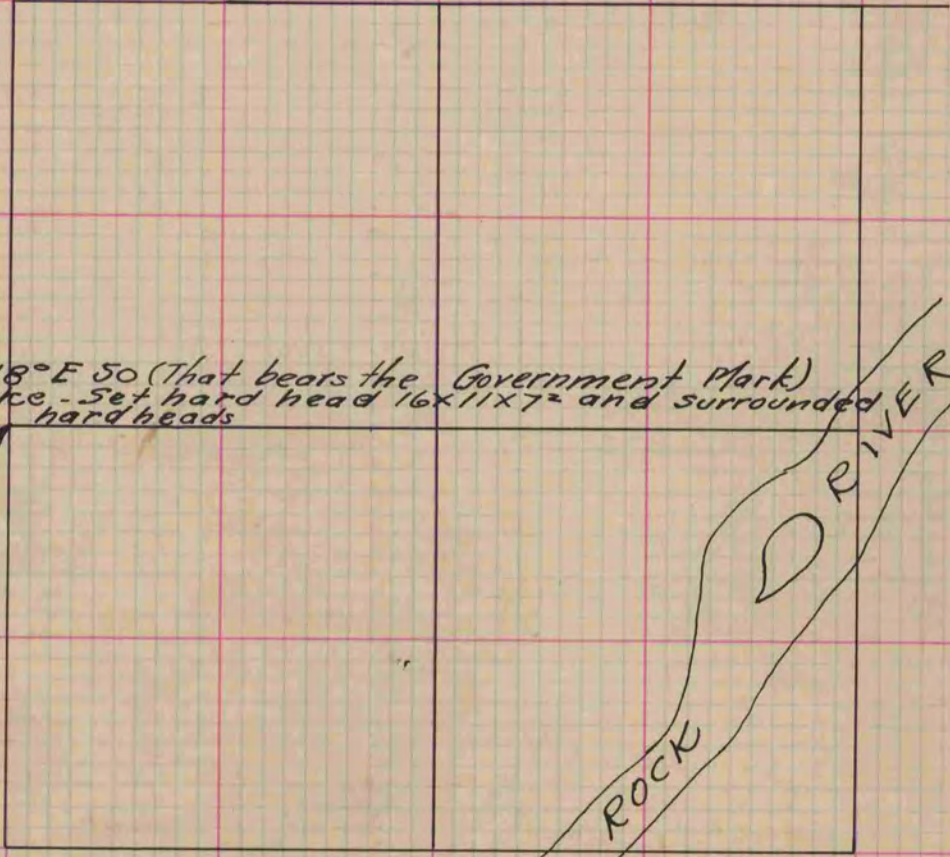

Copied from Page 222 Vol. 1. Original County Surveyors Record