

# PLAT AND RECORD

455

VOL. 6

Of a Survey on Section 8, 9, 17, 18 T 2 R 11 E. of the 4 P. M. in PLYMOUTH Township

Rock County, Wisconsin, ~~the~~ MAY the 19 19 2000

I hereby certify that the following is a correct record of said survey as made by me.

COUNTY BUILDING  
CITY OF JANESVILLE

*Donald Barnes*

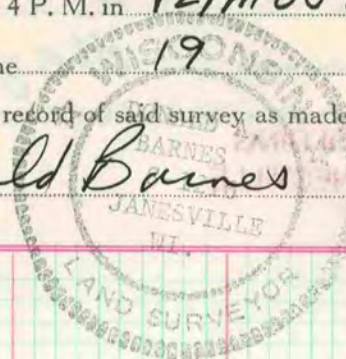

County Surveyor.

