

CITY OF JANESVILLE
COUNTY BUILDING

PLAT AND RECORD

CITY OF JANESVILLE
COUNTY BUILDING

565

VOL. 5

Of a Survey on Section **5** T. **2** R. **11** E. of the 4 P. M. in **PLYMOUTH** Township

Rock County, Wisconsin, made **MARCH** the **6** 19**80**

I hereby certify that the following is a correct record of said survey, as made by me.

Ronald A. Barnes

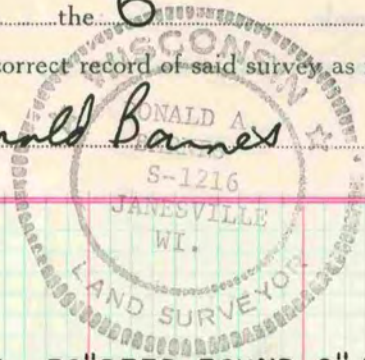

County Surveyor.

NE COR
SEC. 5

FOUND 3/8" 18" IRON PIN, 30" DEEP FOUND 2" IP.
SET ALUM MON.

MICROFILMED