

# PLAT AND RECORD

145

VOL. 6

Of a Survey on Section <sup>1920</sup> 21, 22 T. 2 R. 14 E. of the 4 P. M. in BRADFORD Township  
Rock County, Wisconsin, made MARCH 19th 1981

I hereby certify that the following is a correct record of said survey as made by me.

COUNTY BUILDING  
CITY OF JANESVILLE

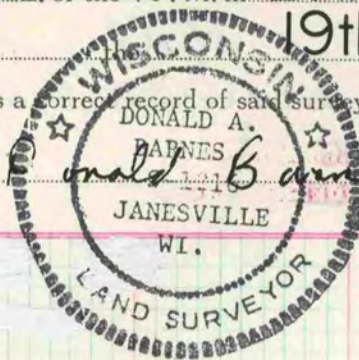

County Surveyor.

S 1/4 SEC 22

FOUND CONC MON WITH BRASS CAP 1 1/2' ABOVE GROUND

SW COR SEC 21

FOUND 1" x 8" IRON PIPE REPLACED. SET ALUM MON ON TOP OF  
LARGE HARDHEAD

x  
x x x

LARSON



ROAD

S 1/4 COR SEC 20

FOUND 1" x 24" IRON PIPE SURROUNDED BY HARDHEADS. REPLACED  
WITH ALUM MON. AT CENTER LINE OF ROAD.

W 1/4 COR SEC 19

REPLACED 1" x 6" IRON PIPE. SET ALUM MON ON TOP OF CUT STONE.

N 1/4 COR SEC 19

REPLACED 1" IRON PIPE WITH ALUM MON

MICROFILMED