

PLAT AND RECORD

141

VOL. 6

Of a Survey on Section **31, 34** T. **1** R. **14** E. of the 4 P. M. in **CLINTON** Township
Rock County, Wisconsin, made **MARCH** 18 19 **81**

I hereby certify that the following is a correct record of said survey as made by me.

COUNTY BUILDING
CITY OF JANESVILLE



County Surveyor.

NE 1/4 COR SEC 8
FD PK AS PREVIOUSLY SET ALUM MON FD 1X24 IRON ROD REPLACED WITH

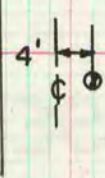

MICROFILMED

SE COR SEC 29

FD RR SIKE & 6' OFFSET SPIKES SET ALUM MON

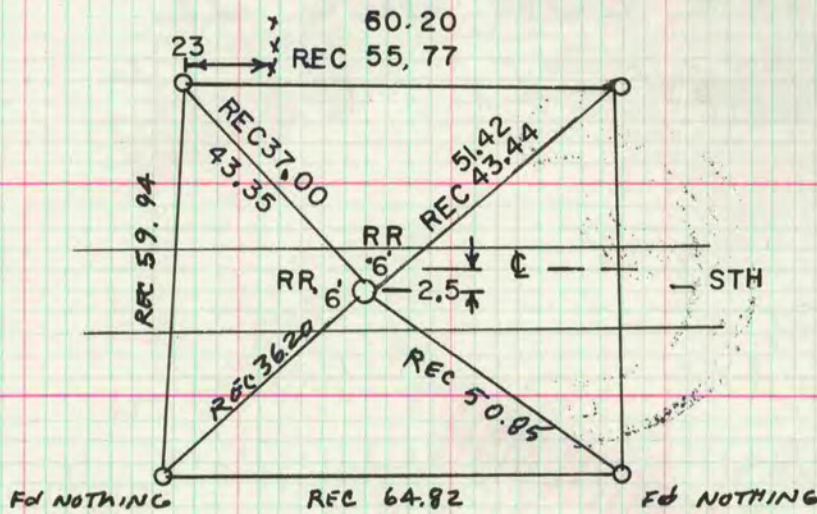

SW COR SEC 34

FD RR SPIKE & STONE OF RECORD 1' DEEP REPLACED WITH ALUM MON

W 1/4 COR SEC 31

REPLACED 1" X 24" IRON ROD WITH ALUM MON

SE COR SEC 31

FD NAIL SET ALUM MON

