

MICROFILMED

PLAT AND RECORD

Of a Survey on Section 13 T 3 R 13 E. of the 4 P. M. in Harmony Township
Rock County, Wisconsin, made May the 7th 1861

I hereby certify that the following is a correct record of said survey as made by me.

(Signed) Edward Roger
R.H.B.

County Surveyor.

COUNTY BUILDING
CITY OF JANESVILLE

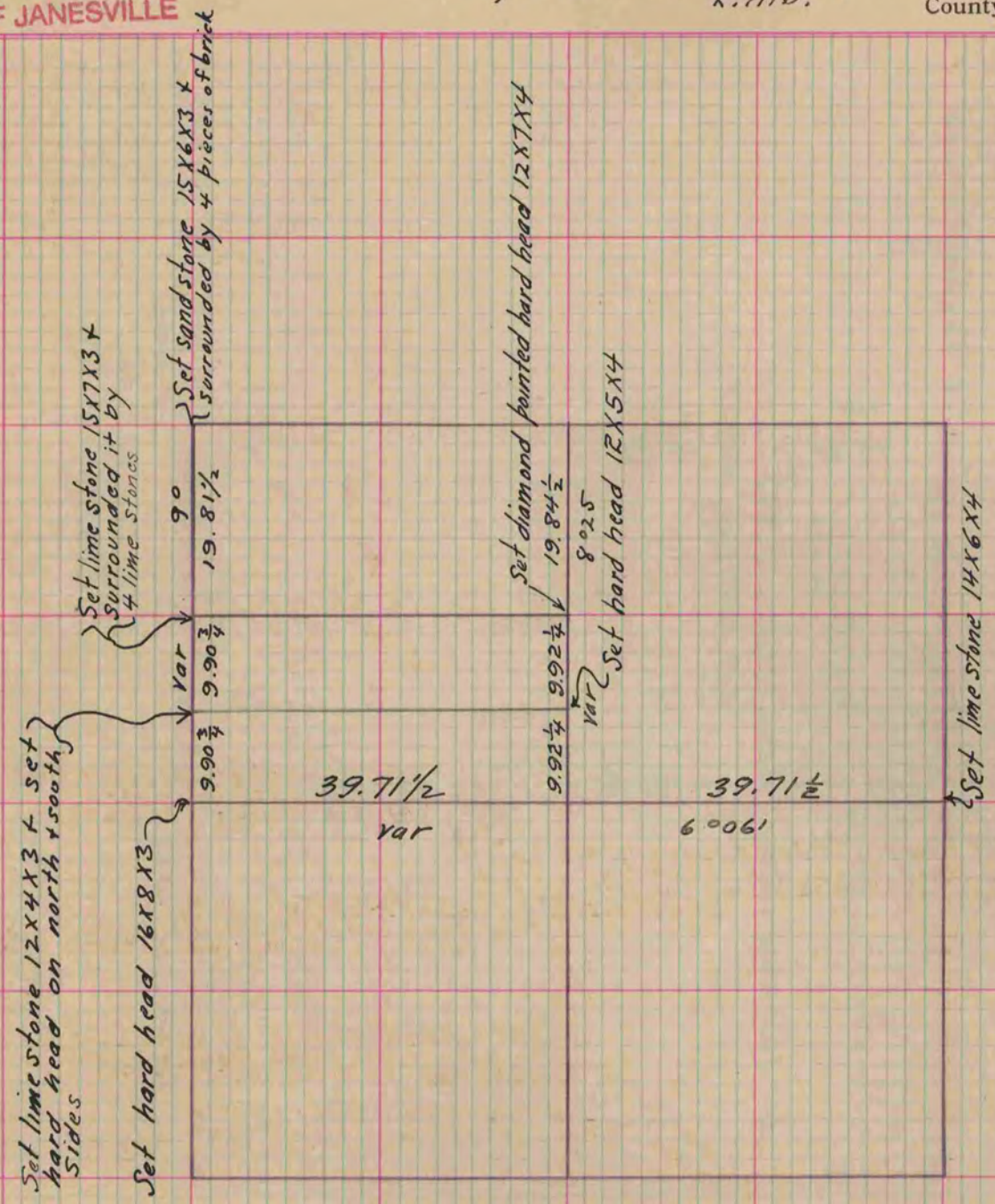

Copied from Page 173 Vol. One Original County Surveyors Record