

PLAT AND RECORD

225

VOL. 6

Of a Survey on Section 14 T 2 R 12 E. of the 4 P. M. Township

Rock County, Wisconsin, made NOV the 19 81

I hereby certify that the following is a correct record of said survey as made by me.

COUNTY BUILDING
CITY OF JAMESVILLE



County Surveyor.

E 1/4 COR SEC 14

Fd BRASS DISK IN PUMT

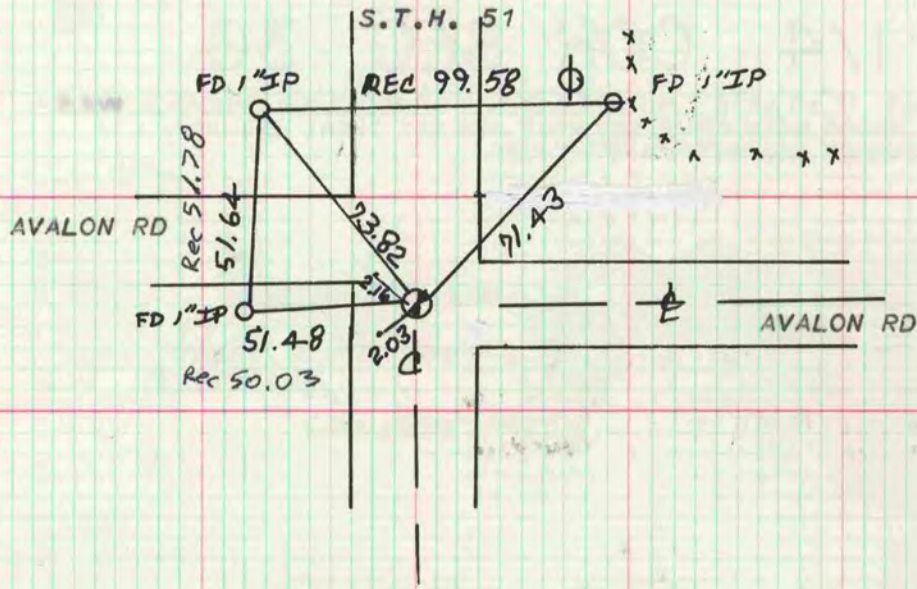

MICROFILMED