

PLAT AND RECORD

MICROFILMED

Of a Survey on Section 26 T 3 R 12 E. of the 4 P. M. in Janesville Township
Rock County, Wisconsin, made May the 3, 4 & 5 1877

I hereby certify that the following is a correct record of said survey as made by me.

COUNTY BUILDING
CITY OF JANESVILLE

(Signed) Edward Ruger
R. H. B. County Surveyor.

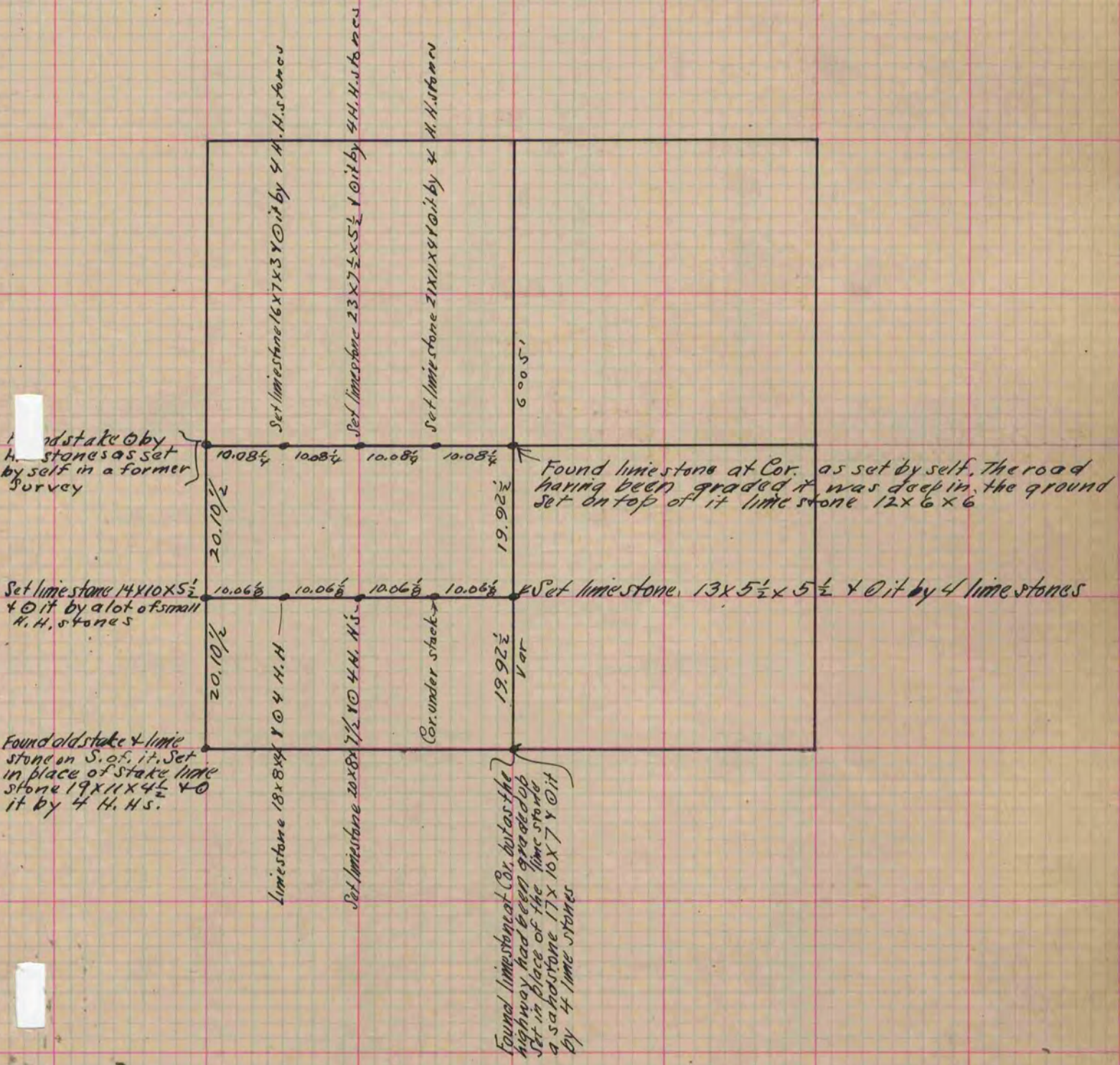

Copied from page 179 Vol. 2. Original County Surveyors Record