

Of a Survey on Section 5 12 T 3 R 12 E. of the 4 P. M. in JANESVILLE Township

Rock County, Wisconsin, made OCTOBER the 5 1977

I hereby certify that the following is a correct record of said survey as made by me.

COUNTY BUILDING  
CITY OF JANESVILLE

*Donald Barnes*

County Surveyor.



NW COR. SEC. 12 T. 3 R. 12 E.

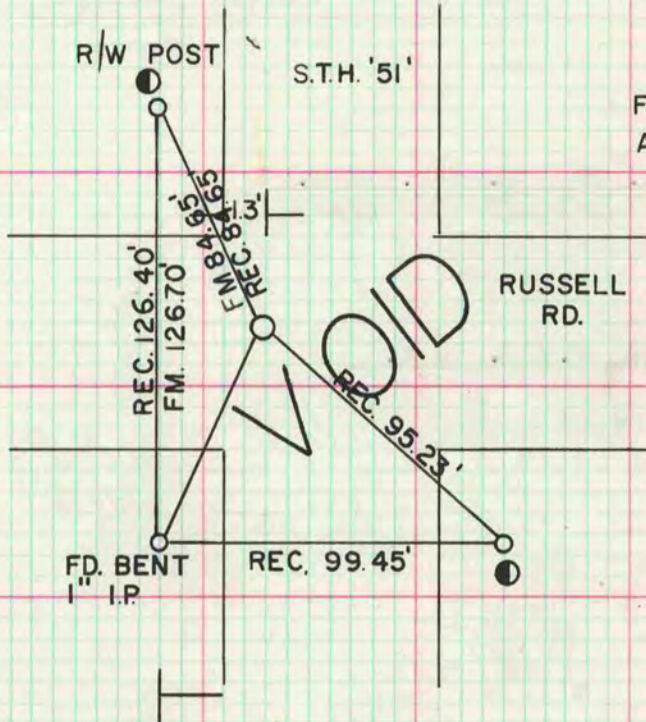

WI/4 COR SEC 12

FOUND 1/4" IP HORIZONTALLY WITHIN A FOOT OF LINE OF A LINE BETWEEN THE SW & NW COR SEC 12. APPROXIMATELY 6' EAST OF EAST EDGE OF PVMT. & 2647 FROM NW COR

NW COR SEC 12

FOUND BRASS PLUG

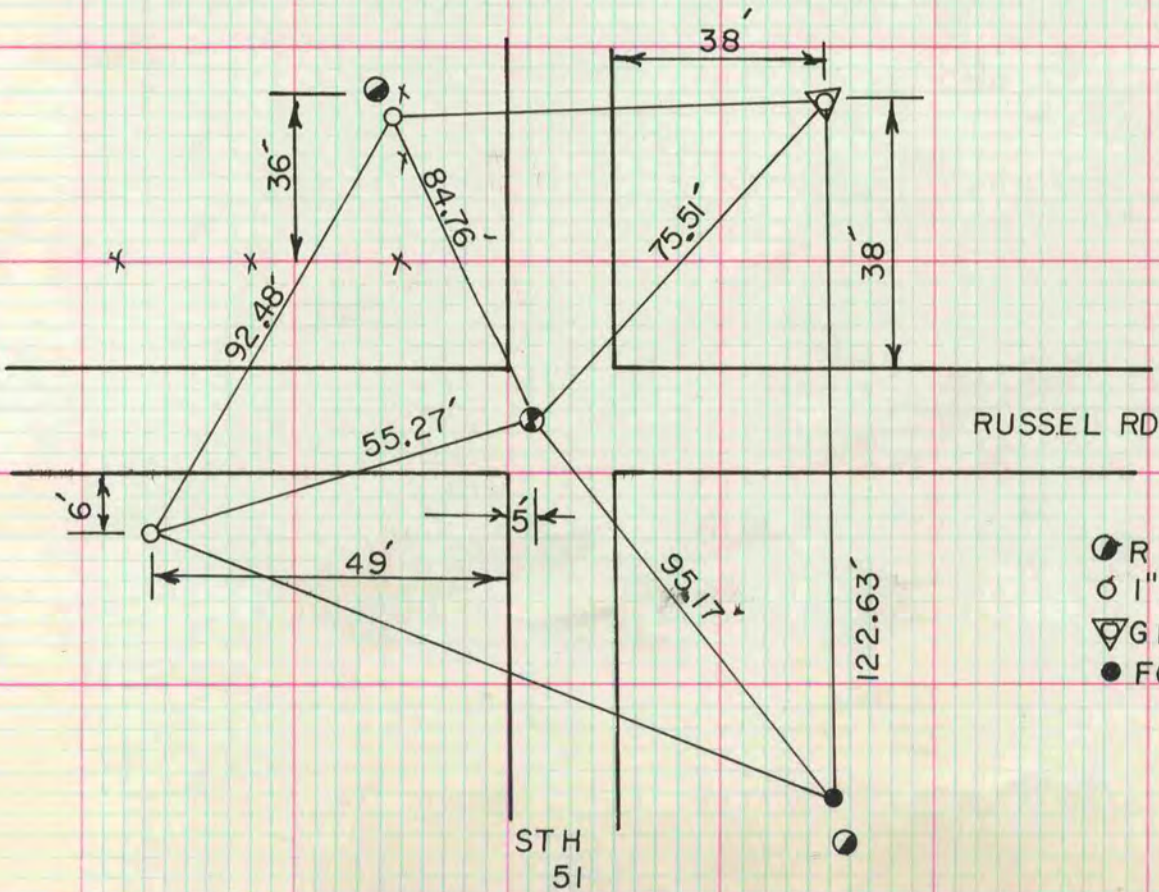

- R/W POST
- 1" X 24 IP
- ▽ GI MON WITH CAP
- FOUND 1" IP

MICROFILMED