

PLAT AND RECORD

Of a Survey on Section 19 T 2 R 10 E. of the 4 P. M. in Spring Valley Township

Rock County, Wisconsin, made June the 28th + 29th 1869

I hereby certify that the following is a correct record of said survey as made by me.

(Signed) R. K. Lee
RKL

ROCK COUNTY SURVEYOR
Dep. County Surveyor.

COUNTY BUILDING
IN CITY OF BELOIT

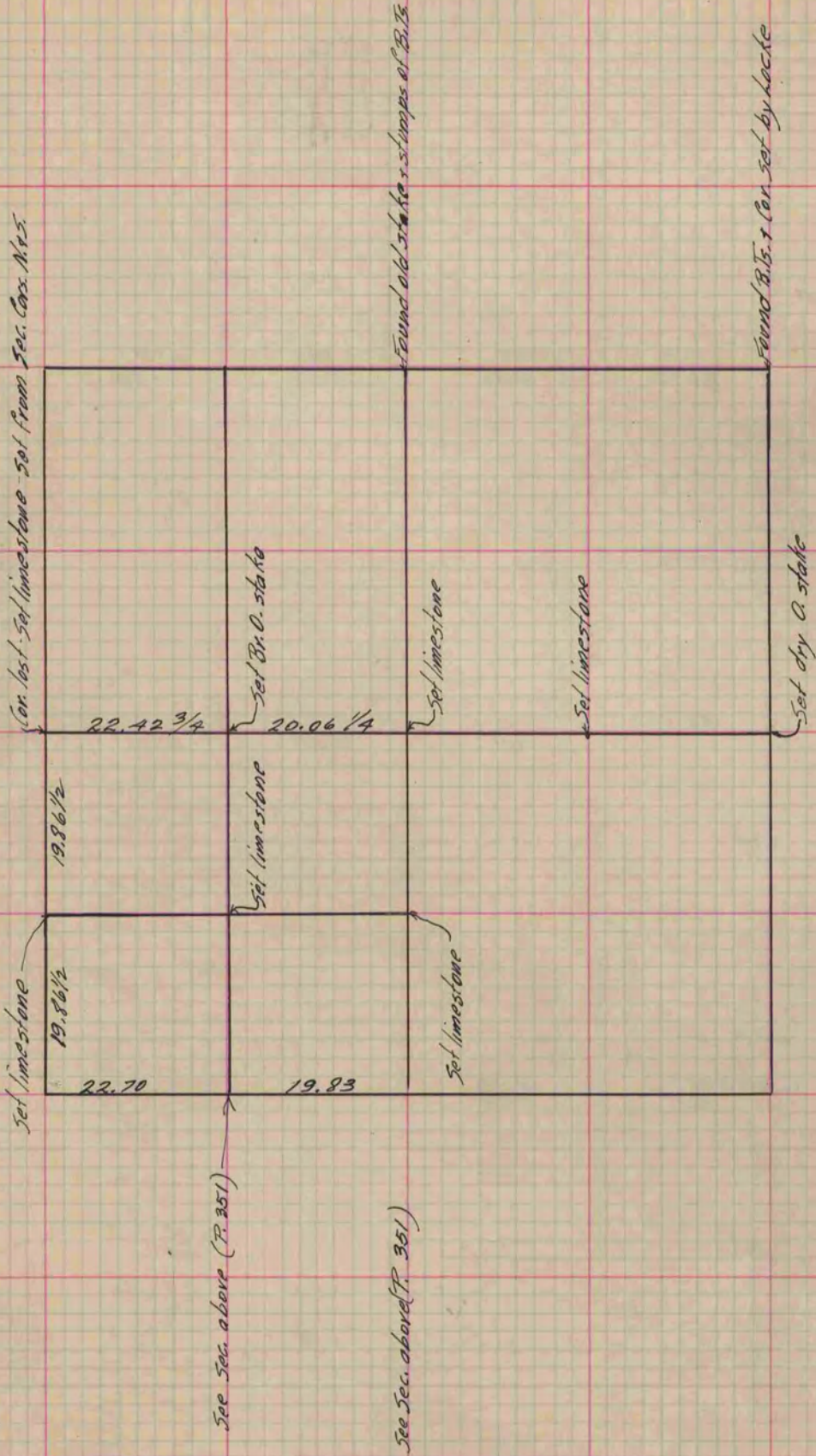

Copied from P. 283 Vol. 1 County Surveyor's Record.