

# PLAT AND RECORD

Of a Survey on Section 13 T 1 R 14 E. of the 4 P. M. in Clinton Township

Rock County, Wisconsin, made June the 29<sup>th</sup> & 29<sup>th</sup> 1867

I hereby certify that the following is a correct record of said survey as made by me.

COUNTY BUILDING  
IN CITY OF БЕЛОIT

(Signed) R. M. Lee  
RMB

Dep. County Surveyor.

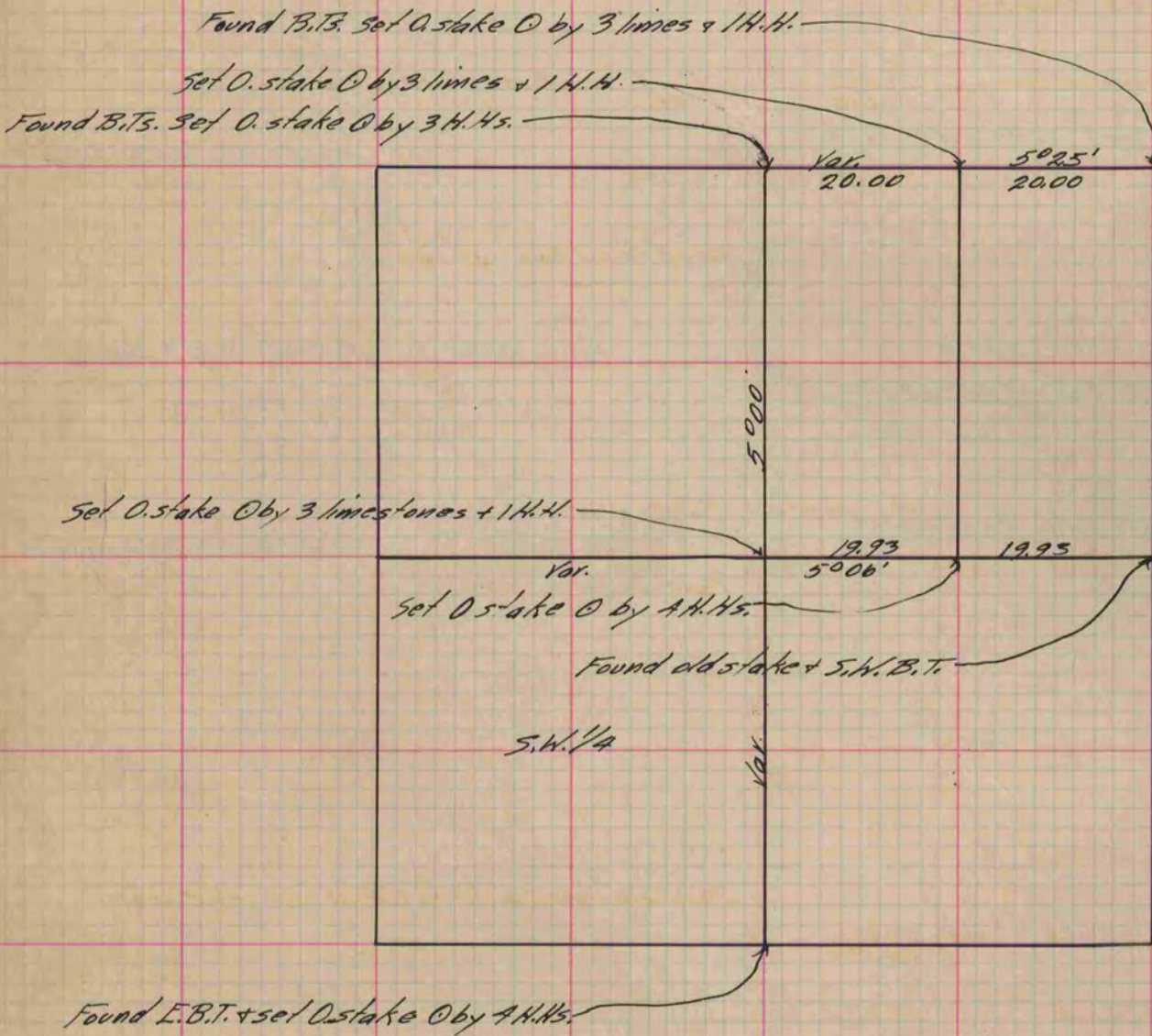

Copied from P. 272 Vol. 1 County Surveyor's Record.