

# PLAT AND RECORD

Of a Survey on Section 21 T 2 R 13 E. of the 4 P. M. in LaPrairie Township

Rock County, Wisconsin, made April the 17 1878

I hereby certify that the following is a correct record of said survey as made by me.

**COUNTY BUILDING  
IN CITY OF БЕЛОIT**

(Signed) *Edward Ruger*  
*ERB*

County Surveyor.

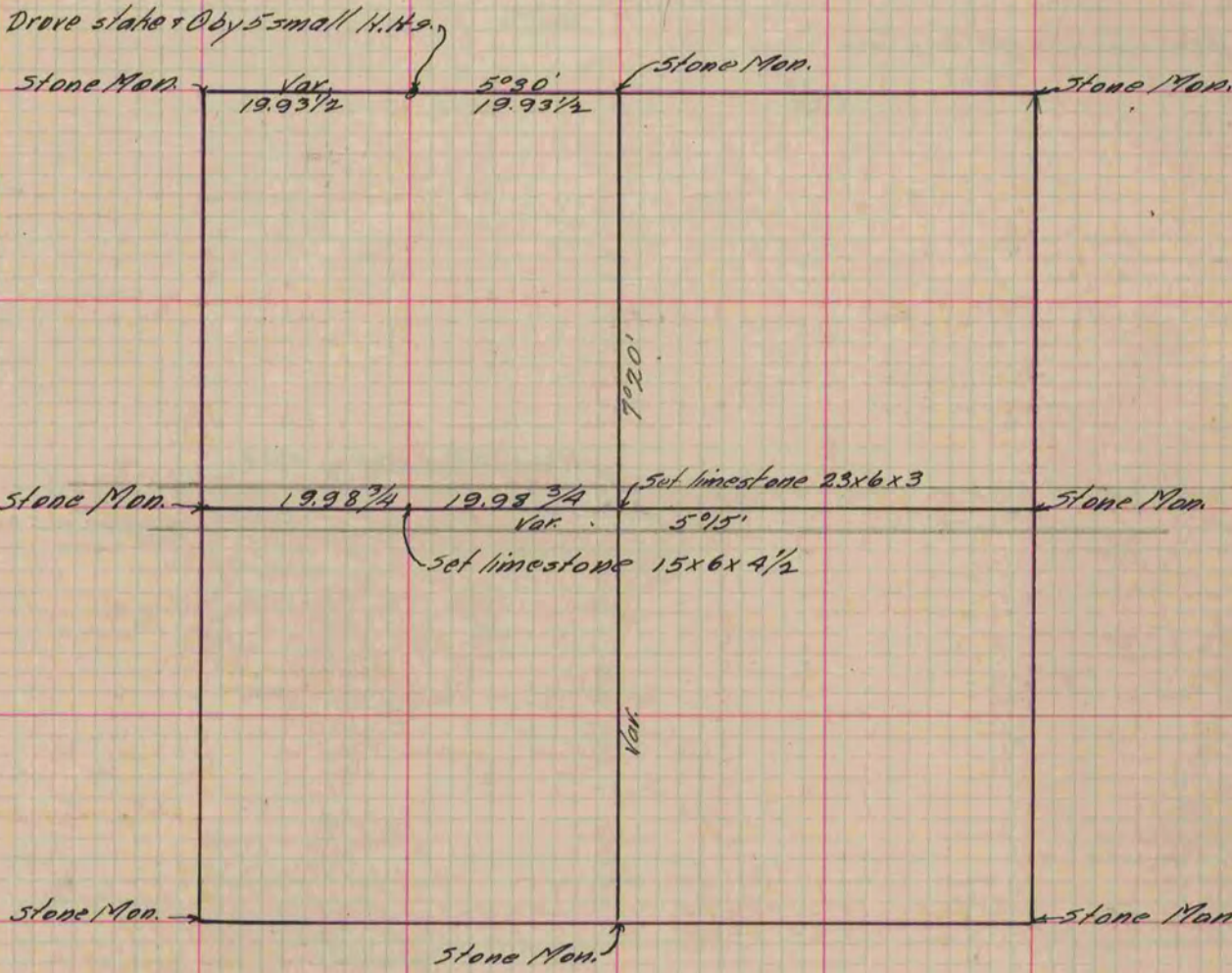

*Copied from P. 199 Vol. 2 County Surveyor's Record.*