

# PLAT AND RECORD

Of a Survey on Section 15 T 3 R 12 E. of the 4 P. M. in Janesville Township  
 Rock County, Wisconsin, made April the 21<sup>st</sup> + 22<sup>nd</sup> 1859

I hereby certify that the following is a correct record of said survey as made by me.

COUNTY BUILDING  
 IN CITY OF BELOIT

(Signed) Edward Ruger.  
*ERM*

County Surveyor.

A Record and Plat of a Survey of a Road running along the North line of Section 15 in Township No. 3 North, of Range No. 12 East of the 4<sup>th</sup> Principle Meridian. Said Road is one chain wide lying 50 links on either side of said Sec. line. For the courses of Said Road, see Variations marked on the lines.

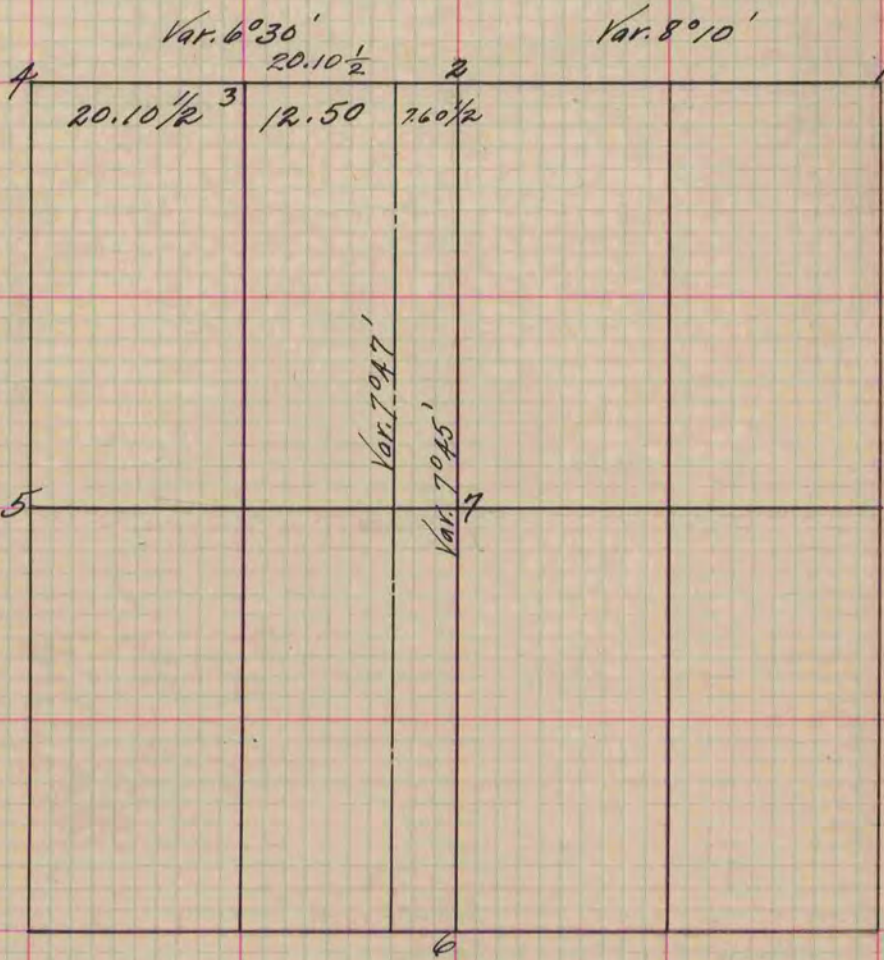

- Fig. 1 Old witness trees cut down took new one Black & N. 2°25' W. 36 Var. 8°10'  
 Surrounded Post by 5 small hard heads.
- " 2 Put in Post by old witness trees, surrounded post by 4 hard heads
  - " 3 Found post which was correct with stone South.
  - " 4 Put in post by old witness trees.
  - " 5 Old witness trees disagreed, put in post by averaging error. Surrounded post by 4 hard heads.
  - " 6 Put in by old witness trees.
  - " 7 It being only necessary to run the North & S. line through the Centre of the section, for the work under Consideration did not put in post at Center of Section.

Copied from Page 110 Vol. one Original County Surveyor's Record.