

PLAT AND RECORD

Of a Survey on Section 22 T 4 R 11 E. of the 4 P. M. in Porter Township

Rock County, Wisconsin, made April the 9 1878

I hereby certify that the following is a correct record of said survey as made by me.

COUNTY BUILDING
IN CITY OF БЕЛОИТ

(Signed) Edward Poyer

County Surveyor.

Found Cor. set by Locke. Drove new stake in place of old one set
it by A.H.Hs.

Found 2 H.H.s. one on top of the other
& remains of old stake under them set
H.H. 2.2x10x8 & O.I. by A.H.Hs.

Set H.H. 1.6x10x5 O.I. by 3 H.Hs.

Drove stake O.I. by 2 H.Hs. 2.4x1.5 & lime stone

Found J.F.B.T. stump of 3 H.H. 1.6x10x8 on top of lime
stone laid that remains of old stake under stones. Replaced stake
& stones

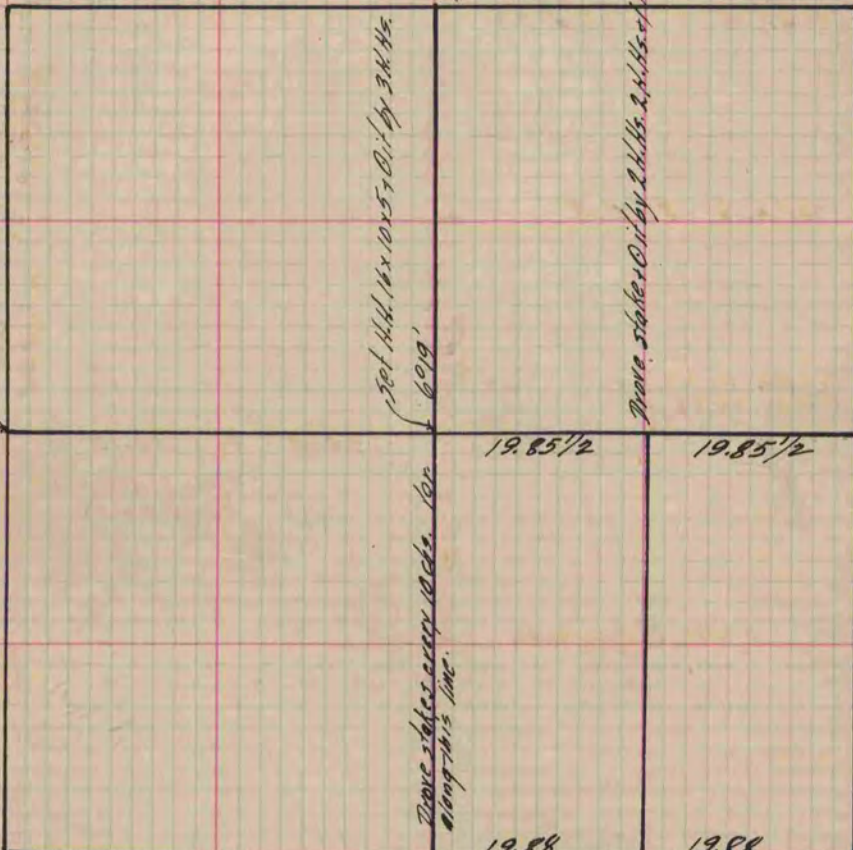

Drove stakes every 100 ft. for
along this line.

Found old stake also found N.W. B.T.
N.E. B.T. post. Drove stake O.I. by
A small H.H.s.

Drove stake and H. Kan. by 5 stakes

Found lime stone on Cor. 12x8x4
remains of old stake under it also
found N.E. B.T. stump of 3 H.H. 1.6x10x8
stake replaced stone.

Copied from P. 195 Vol. 2 County Surveyor's Record.