

U.S. PUBLIC LAND SURVEY MONUMENT RECORD

For Public Land Survey Corners in
EULTON TWP. T. 4 N., R. 12 E.

For Miscellaneous Corners within
 Sec. _____, T. _____ N., R. _____ E.

CORNER CODE INDEX

	1	2	3	4	5	6	7	8	9	10	11	12	13	14	15	16	17	18	19	20	21	22	23	24	25
A																									
B																									
C	6			5	◆	4			3											2					
D																									
E																									
F																									
G	7			8					9											10					
H																									
J																									
K																									
L	18			17					16											15					
M																									
N																									
O																									
P	19			20					21											22					
Q																									
R																									
S																									
T	30			29					28											27					
U																									
V																									
W																									
X	31			32					33											34					
Y																									
Z																									

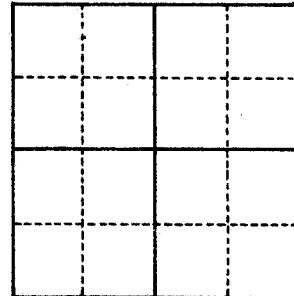

1. Above code numbers are positioned Meander, Claim, or Fractional corners of the section.
2. Township corner code numbers shall be applied to the corners of above typical section.

PLACE MONUMENT SYMBOL (◆) AT PROPER LOCATION ON ABOVE INDEX

EXAMPLE

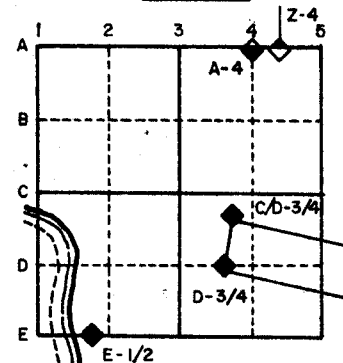

IF AVAILABLE STATE PLANE COORDINATES

North (Y) 307,489.66 Eleve. (Z) _____
 East (X) 2,243,514.57 Zone _____
 Hor. Datum _____ Vert. Datum _____

RECORD COORDINATES

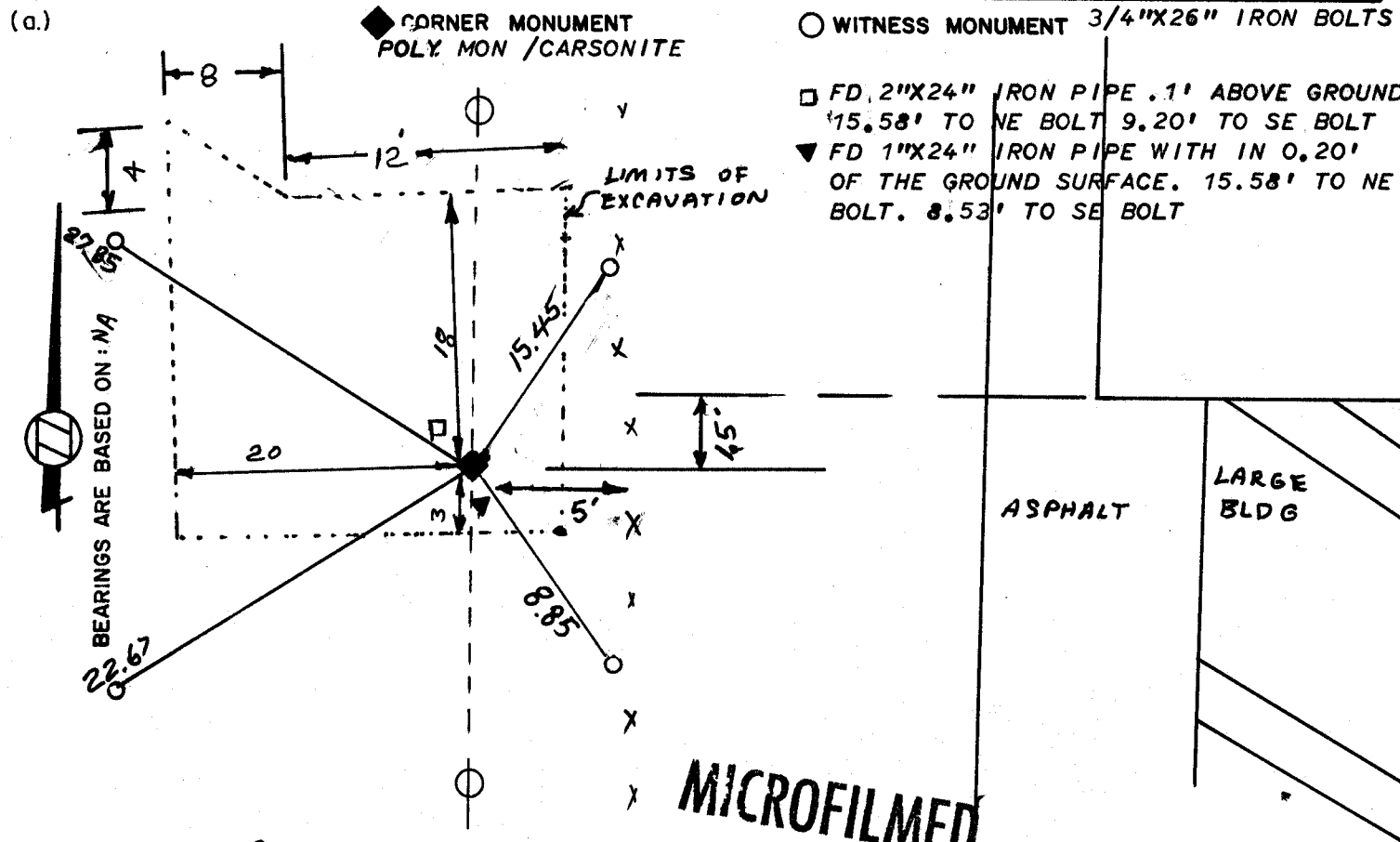

FIELD BOOK 2 PAGE # 44, 47

MICROFILMED

SHOW A PLAN VIEW DRAWING DEPICTING THE CORNER MONUMENT AND SURROUNDING PHYSICAL FEATURES, INCLUDING THE EXCAVATION AREA AND DEPTH. THE CORNER MONUMENT SHALL HAVE THE FOLLOWING CHARACTERISTICS: 1) HAVE AT LEAST TWO PREDETERMINED BREAK-OFF POINTS. 2) IF BROKEN, LEAVE A PERMANENTLY MAGNETIZED REMNANT AT THE ORIGINAL POINT. 3) MUST BE EXTENDABLE. 4) THE CAP IS INSCRIBED: ROCK COUNTY SURVEY MONUMENT - PENALTY FOR DISTURBING MARKER. 5) OR AN EXISTING CUT LIMESTONE. AN IRON PIPE 1 1/2" x 4" (MINIMUM) MAY BE USED IN AREAS WHERE GROUND WATER IS WITHIN ONE FOOT OF THE SURFACE. IF THE CORNER IS OCCUPIED BY AN IMPROVEMENT (MANHOLE, BURIED CABLE, ETC.) ANY DURABLE, DISTINCT MONUMENT MAY BE USED. CORNERS SHALL BE REFERENCED WITH AT LEAST 4 DURABLE WITNESS MONUMENTS. WITNESS MONUMENTS SHALL BE MADE OF CONCRETE, NATURAL STONE, IRON OR OTHER EQUALLY DURABLE MATERIAL, EXCEPT WOOD. DESCRIBE THE CORNER AND THE WITNESS MONUMENTS.

CORNER CODE : C 9

(b.) Describe any record evidence, monument evidence, occupational evidence, testimonial evidence or any other material evidence you considered, and whether the monument was found or placed.

1. April 1834 HARRISON SET THE ORIGINAL GOVERNMENT CORNER POST & 2 BT
3. May 29, 1883 ED RUGER FOUND REMAINS OF OLD STAKE AND REMAINS OF BOTH BTs PUT FLAT HH IN DEEP, OVER OLD STAKE & PUT ON TOP OF IT HH 19"X11"X8" @ BY 4 HH.
4. 1966 BATTERMAN JR. FOUND PIPE.
5. 1970s SANDSNES FOUND PIPE & ESTABLISHED STATE PLANE COORDINATES.
6. JULY 1983. I DUG THE HOLE AS SHOWN 9' DEEP, & FOUND the 2 iron pipes AS SHOWN. AT ABOUT 7' DEEP I FOUND NATURAL SOIL. AT 7' DEEP I ALSO FOUND A 3/4"X3' SHAFT WITH A 4" DIA DISK ON TOP. I REMOVED THIS AND RESET A POLY MONUMENT AT GRADE LEVEL.

(c.) Was the corner restored through acceptance of (1) an obliterated evidence location, or, (2) a found perpetuated location?

I ACCEPTED THE SHAFT AND PERPETUATED THIS LOCATION.

(d.) Describe any material discrepancy between the location of the corner as restored or reestablished and the location of that corner as previously restored or reestablished by distance and direction. Show the discrepancy on the plan view drawing under (a), above. Show the distances between the corner as previously restored or reestablished and (1) the corner as restored or reestablished, and (2) to at least 4 of the witness monuments shown on the drawing in (a), above.

I COULD NOT FIND ANY RECORD EVIDENCE ABOUT HOW OR WHO SET THE 3 FOUND MONUMENTS. I ACCEPTED THE SHAFT BECAUSE IT WAS IN VIRGIN SOIL AND APPEARED TO BE THE OLDEST. SEE COUNTY SURVEY RECORDS VOL 6 PAGE 303. I REDUG FOR THE CORNER BECAUSE OF THE DISCREPANCY WITH THE DISTANCE FROM THE SE COR SEC 5 TO THE E1/16th CORNER OF THE SE 1/4 SEC 5 & THE DISTANCE FROM THIS 1/16th CORNER TO THE E1/4 COR SEC 5. THERE IS A SIMILIAR DISCREPANCY BETWEEN THE S1/4 COR, 1/16th COR., AND THE INTERSECTION OF THE QUARTER LINES.

(e.) Was the corner reestablished through lost corner proportionate methods? If so, show the method, including the directions and distances to other public land survey corners used as evidence or used for proportioning in determining the corner location.

NO

I, Donald Barnes, hereby certify that the corner points as identified by the corner code index were, in a field survey on JULY 14, 1983, established, re-established, monumented, re-monumented recovered or restored as expressed below and in conformance with the regulations and rules as required in the current manual of survey instructions of the United States Department of Interior, Bureau of Land Management.

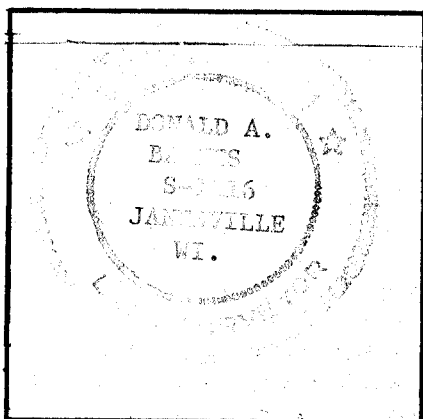

COUNTY SURVEYOR FILING DATA

Date of Computer Entry _____

Date Received _____

Date Microfilmed OCT 15 1984

Treasurer's Receipt No. _____

Number of Included Sheets _____

AFFIX YOUR LAND SURVEYOR SEAL.

C9