

Paper weight-110# (minimum)

Black nonfading ink required

U.S. PUBLIC LAND SURVEY MONUMENT RECORD

For Public Land Survey Corners In:

WI ADMINISTRATIVE CODE A-E 7.08 REQUIREMENT

T. 4 N. R. 12 E. 4th P.M.

REV 10/23/2004

USMONREC.DWG

CORNER CODE INDEX

1	2	3	4	5	6	7	8	9	10	11	12	13	14	15	16	17	18	19	20	21	22	23	24	25	
A																									A
B																									B
C		6																							C
D						5																			D
E																									E
F																									F
G																									G
H																									H
J																									J
K																									K
L																									L
M																									M
N																									N
O																									O
P																									P
Q																									Q
R																									R
S																									S
T																									T
U																									U
V																									V
W																									W
X																									X
Y																									Y
Z																									Z

FULTON TWP

ROCK COUNTY WI

IF AVAILABLE
ROCK COUNTY COORDINATES PREFERRED

North _____ Elev. _____

East _____

Hor. Datum _____ Vert. Datum _____

LATITUDE _____ ELLIPS. HT. _____

LONGITUDE _____

NAD83(91) _____ NETWORK ADJ. YR _____

GPS (X) _____ TRAVERSE (X) _____

BASED ON THE FOLLOWING CONTROL:

PLACE MONUMENT SYMBOL AT PROPER LOCATION ON ABOVE INDEX

CORNER MONUMENT

WITNESS MONUMENT

BEARINGS ARE BASED ON: _____

FIELD BOOK _____ PAGE # _____

SHEET 1 OF 3

SHOW A PLAN VIEW DRAWING DEPICTING THE CORNER MONUMENT AND SURROUNDING PHYSICAL FEATURES, INCLUDING THE EXCAVATION AREA AND DEPTH.

PLANNING & ZONING COMMITTEE ADOPTED THIS FORM ON 12/2/1982

CORNER CODE E-13

FU527^

(B) Describe any record evidence, monument evidence, occupational evidence, testimonial evidence or any other material evidence you considered, and whether the monument was found or placed.

- 1834 (MAR/APR) HARRISON NORTH BET SECS 3 & 4
1554.3 RED O. 12
2640 QUARTER SEC. CORNER {W.O. 10 S72E 52.8' RED O 12
S25W 163.68' W.O. 10 RED O 12} MARKED
4290 BROOK 9.9' E
5305.74 INT. NORTH B DY 145.2' E OF P {BURR O 18 S48W
116.82' W.O. 12 S37E 98.34' LAND ?? SAME
- 1834 (MAR/APR) HARRISON EAST ON RAND BET. 4 & 9
1372.8 ENTERED MARSH
2640 TEMPY 1/4 SEC COR IN MARSH
5082 ? MARSH
5332.8 INT. EAST BDY 18.48' NORTH OF POST
WEST COR WEST
2666.4 QUARTER SEC COR. BURR OAK 12 S5W 248 NO
OTHER
NEAR.
5332.8 SEC COR.
- 1834 (MAR/APR) HARRISON EAST ON RAND BET. 3 & 10
247.5 TRAIL & WAGGON ROAD NE
1551 BROOK 11.88' CRS SOUTH
2640 TEMPY 1/4 SEC COR.
4603.5 TRAIL CRS NE
5247 INT. E BDY 31.02' N OF POST LAND ROLLING 2ND
RATE WITH TIMBER OF BURR & W.O. UNDERGROWTH
? & ? & WEEDS
COR. WEST
2623.5 QUARTER SEC CORNER {W.O. 18 N45E 24.42' W.O.
18 S5E 70.62'
5247 INT. SEC COR.
- 1834 (MAR/APR) HARRISON ORIG. SURVEYOR.
NORTH BETWEEN SECS 9 & 10
377.52 RED OAK 12
2640 TO A HICKORY 10 INCHES IN DIAMETER IN WHICH
ESTABLISHED QUARTER SEC COR.
3498 TRAIL CRS N.E.
3664.98 RED OAK 8
3994.98 TRAIL NE & ROAD
5016 TRAIL N.E.
5280 COR TO SECS 3, 4, 9, 10
- 1854 BURDICK "VILLAGE OF EDGERTON" BK 2 PG 45 CALLS FOR
CORNER BUT STATES NOTHING ABOUT IT. FROM CORNER N1-
15W ALONG THE SECTION LINE WHICH IS THE WEST R/W LINE
OF ALBION ST., CALLS FOR THE EAST LINE OF THE NE 1/4 OF
SEC 9 AS NO-45? IN VARIATION OF NEEDLE 8E, 98.34 FROM
CORNER TO THE NORTH LINE OF BLOCK 1.
- 1857 MILLER BK 3 PG 20 "SWITHS ADDITION TO EDGERTON" CALLS
FOR STONE.
- 1881 LEE VOL 2 PG 324 & 1001 FD PIECES OF T R.R. RAIL AT COR &
WHERE STUMPS OF BTS HAD BEEN DUG UP. VAR 6-27
2596.11' TO S 1/4 COR SEC 3
- 18?? RUGER VOL 5 PG 431 "RUGER'S FIELD BOOK R-K PG 144.
CALLS FOR 5332.80 TO NW COR SEC 9; BURR OAK 10 S55E 8;
BURR OAK 12 N30E 32; BURR OAK 18 S13W 32; & BURR OAK
18" ?20? 42
- 1882 RUGER VOL 2 PG 390 & 1032 PIECE OF RR BAR. VAR 6-30 TO
S 1/4 COR SEC 4
- 1931 SUNNY VOL 3 PG 197 STATES NOTHING ABOUT MON. BUT
CALLS FOR 2640.66 TO W 1/4 COR SEC 10 WITH A LOT OF
CALLS TO POINTS PARALLEL TO THE SEC LINE.
- 1944 SUNNY #3375 CULTON'S 3RD ADD. USED COR BUT STATES
NOTHING ABOUT MON.
- 1970 WEIR #2082 STATES NOTHING ABOUT MON. SHOWS ON
NORTH SIDE OF LAWTON ST & WEST OF MAIN ST.

SHEET 1 OF 3

CORNER CODE E-13

David Barnes

May 6, 2008

FU527

- 1978 SANDSNES VOL 5 PG 447 PROVIDED THE FOLLOWING:
304,954.09; 2,248,993.19
- 1978 WEIR #1014 STATES NOTHING ABOUT MON. 304,954.09;
2,248,993.19
- 1978 SANDSNES #1033,1103,1120&6581 AIR PHOTO GROUND
CONTROL
- 1979 WEIR BK 30 PG 21 WALKER'S ADD. FD ROCK COUNTY MON.
- 1980 SANDSNES #2146 ASSESSORS PLAT DL 253,255,256
- 1984 BARNES VOL 6 PG 326 304,954.09; 2,248,993.19 N1-36-33W
2651.98 TO W 1/4 COR SEC 3, N89-47-50E 2586.2X TO S 1/4
COR SEC 3
- 1985 SANDSNES #13758 & 13759 SUB STATES NOTHING ABOUT
MON. 2694.72 TO N 1/4 COR SEC 9 & ANGLE 87-58-34 @ NE
COR SEC 9 FROM N/S 1/4 LINE TO N 1/4 COR SEC 9
- 1985 SANDSNES CSM VOL 12 PG 35 FD ALUM.
- 1986 WEIR CSM VOL 12 PG 389 ALUM. MON.
- 1987 LEE #12791 STATES NOTHING ABOUT MON. 2649.75 TO E 1/4
COR SEC 4
- 1990 SANDSNES #1621 WALKER'S ADD STATES NOTHING ABOUT
MON.
- 1992 RADL CSM VOL 15 PG 463 ALUM. MON. IN BUILDING ON
NORTH SIDE OF LAWTON ST. 2694.77 TO N 1/4 COR SEC 9
- 1993 NORTHROP CSM VOL 16 PG 457 ALUM. MON. 2694.97 TO S 1/4
COR SEC 4
- 1995 NORTHROP #5826 ORIGINAL PLAT FD ALUM. MON. 2650.2 TO
E 1/4 COR SEC 4.
- 1998 WEIR CSM VOL 21 PG 306 ALUM. 304,954.09; 2,248,993.19
- 1999 FAVORITE CSM VOL 22 PG 249 ALUM. MON. 304,954.087;
2,248,993.190
- 2004 COMBS CSM 27-205 ALUM 2649.80 TO E 1/4 COR SEC 4

FOUND ALUM. MON. IN ROUND CUT HOLE IN CONCRETE FLOOR OF BUILDING.

C) Was the corner restored through acceptance of (1) an obliterated evidence location, or, (2) a found perpetuated location?

ACCEPTED FD ALUM. MON.

D) Describe any material discrepancy between the location of the corner as restored or reestablished and the location of that corner as previously restored or reestablished by distance and direction. Show the discrepancy on the plan view drawing under (a), above. Show the distances between the corner as previously restored or reestablished and (1) the corner as restored or reestablished, and (2) to at least 4 of the witness monuments shown on the drawing in (a), above.

(E) Was the corner reestablished through lost corner proportionate methods? If so, show the method, including the directions and distances to other public land survey corners used as evidence or used for proportioning the corner location.

I, **Donald Barnes**, hereby certify that the corner location as identified by the corner code index was determined by me under my direction and control and that this U.S. Public Land Survey Monument Record is correct and complete to the best of my knowledge and belief.

Seal

Donald Barnes
Emboss

May 6, 2008

SHEET 2 OF 3

CORNER CODE **E-13**

A.E. 7.08 REQUIREMENT

1854 VAR OF NEEDLE 8E
1854 N1-15W
N00-57-35W 2649.77
SECTION LINE

NE COR
SEC 9
FULTON TWP
T4N R12E

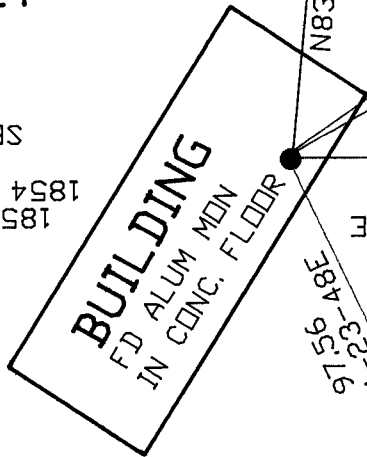

HSE #107
FD 3/4" PIN

HSE #13

FD 1/2" PIPE
S55-54-09E 52.62
FD 3/4" PIN

S7-28-41E 187.04

3/4X24 REROD /CAP
6.9 NE OF 2' HIGH PIPE
9.5' SE OF SE COR CONC. PAD

N34-51-28E 224.42

3/4X24 REROD/CAP
5.6 NORTH OF NORTH RAIL,
10.6 WEST OF WEST FACE OF DEPOT

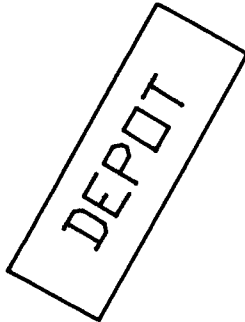

N

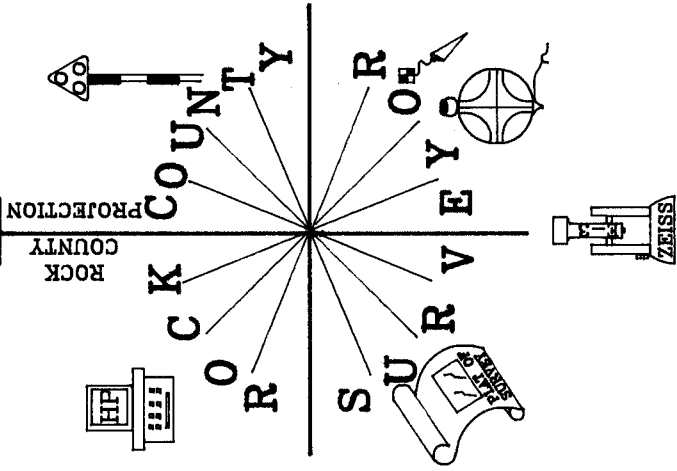

MAIN ST
W. LAWTON ST

OBSERVATION SHEETS 787 & 902

Dwight Barnes
EMBOSSSED SEAL

May 6, 2008

SHEET 3 OF 3

E-13