

PLAT AND RECORD

Of a Survey on Section / T 3 R 10 E. of the 4 P. M. in *Magnolia* Township

Rock County, Wisconsin, made *August* the *1855*

I hereby certify that the following is a correct record of said survey as made by me.

COUNTY BUILDING
IN CITY OF BELOIT

(Signed) *Joseph Church*
JCB

County Surveyor.

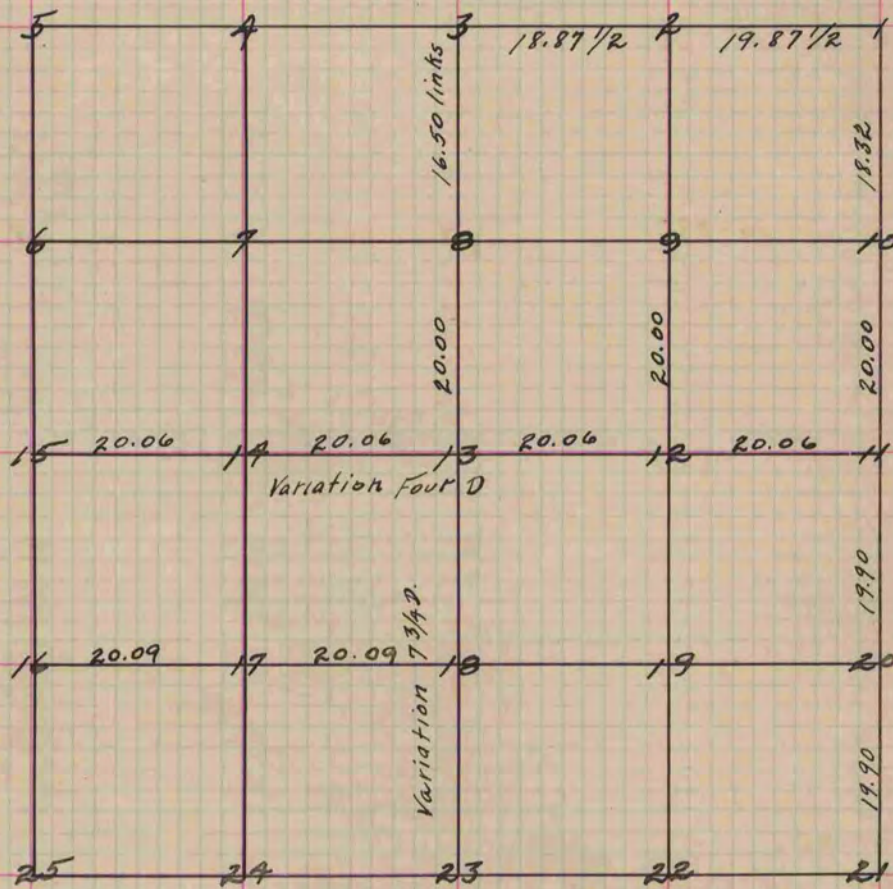

- Fig. 13 Br. O. 14 S. 29 1/2 E. 128 Br. O. 12 N. 60 E. 135
- Fig. 12 " " 18 N. 1 1/2 E. 2010 Br. O. 12 S. 82 W. 141
- Fig. 18 Br. O. 14 N. 45 3/4 E. 14
- " 16 Br. O. 12 N. 14 1/2 E. 222 Br. O. 14 N. 64 E. 43.
- Fig. 2 Post and Stone.
- " 3 " " " .
- " 8 " " " .
- " 10 " " " .

Copied from Page 48 Vol. 1 Original County Surveyors Record.