

PLAT AND RECORD

Of a Survey on Section 9 T 2 R 10 E. of the 4 P. M. in Spring Valley Township

Rock County, Wisconsin, made June the 13th & 14th 1855

I hereby certify that the following is a correct record of said survey as made by me.

COUNTY BUILDING
IN CITY OF БЕЛОIT

(Signed) Joseph Church

County Surveyor.

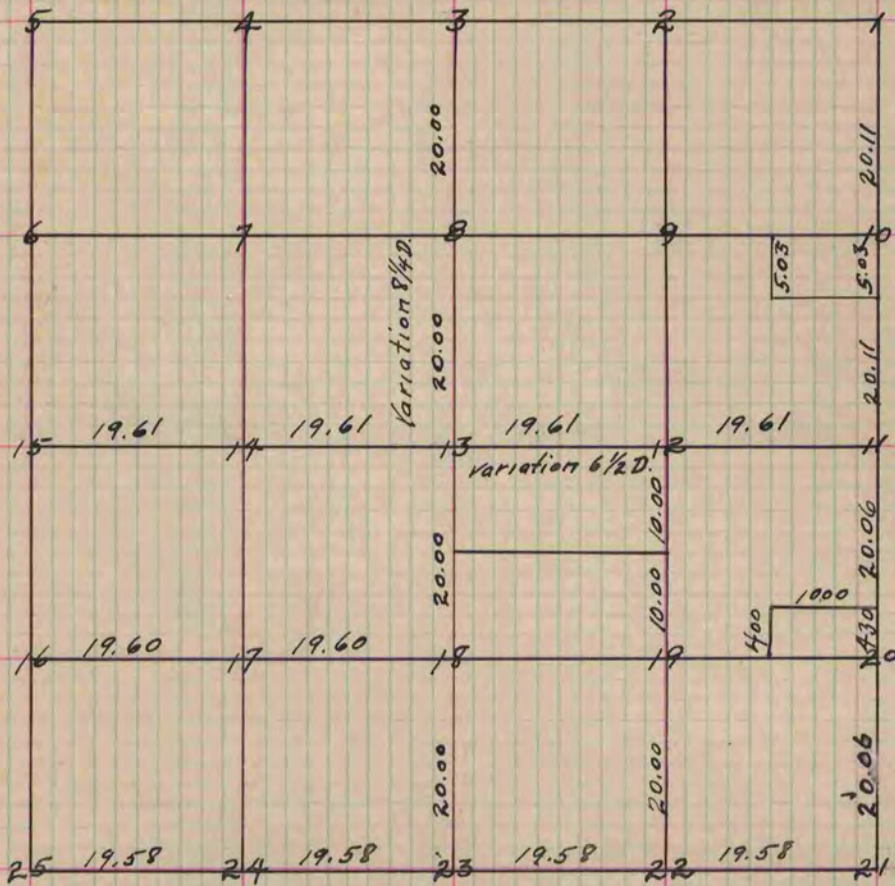

- Fig. 23 Bur. O. 12 N. 13 1/2 W. 507 links.
14 S. 4 1/2 E. 511 links.
- Fig. 8 Bur. O. 20 S. 72 1/2 E. 19 " .
18 S. 84 W. 77
- Fig. 13 Bur. O. 18 S. 19 1/4 W. 77 " .
14 S. 61 W. 47 1/2 "
- Fig. 14 Bur. O. 20 N. 36 W. 149 " .
20 S. 35 1/2 W. 135 "
- Fig. 17 " " 14 S. 71 1/2 W. 46 " .
15 S. 82 1/2 E. 34 " .
- Fig. 18 " " 14 S. 1 1/2 W. 48 " .
14 N. 18 E. 81 " .

- Fig. 22 Br. O. 20 N. 54 W. 188
18 S. 33 1/2 N. 35
- Fig. 12 " " 12 N. 34 W. 53
20 S. 25 E. 107 1/2
- Fig. 19 Br. O. 14 S. 68 1/2 E. 52
14 N. 83 E. 40
- Fig. 20 24 S. 55 W. 52
10 N. 81 1/2 E. 57
- Fig. 9 14 N. 26 1/2 W. 27 1/2
16 S. 74 E. 36

The above Survey was made Feb. 13th 1856.
(Signed) Joseph Church, County Surveyor

Copied from Page 45 Vol. 1 Original County Surveyors Record.