

U.S. PUBLIC LAND SURVEY MONUMENT RECORD

For Public Land Survey Corners in:

WI ADMINISTRATIVE CODE A-E 7.08 REQUIREMENT

T. 1 N., R. 11 E

CORNER CODE INDEX

A	1	2	3	4	5	6	7	8	9	10	11	12	13	14	15	16	17	18	19	20	21	22	23	24	25
B	6																								
C		5																							
D			4																						
E				3																					
F					2																				
G						1																			
H	7																								
I		8																							
J			9																						
K				10																					
L					11																				
M						12																			
N							13																		
O								14																	
P									15																
Q										16															
R											17														
S												18													
T													19												
U														20											
V															21										
W																22									
X																	23								
Y																		24							
Z																			25						

NEWARK TWP

ROCK COUNTY WI

IF AVAILABLE
ROCK COUNTY COORDINATES PREFERRED

North _____ Elev. _____

East _____

Hor. Datum _____ Vert. Datum _____

LATITUDE _____ ELLIPS. HT. _____

LONGITUDE _____

GPS (X) _____ TRAVERSE (X) _____

BASED ON THE FOLLOWING CONTROL:

PLACE MONUMENT SYMBOL AT PROPER LOCATION ON ABOVE INDEX

CORNER MONUMENT

WITNESS MONUMENT

(a)

BEARINGS ARE BASED ON:

FIELD BOOK _____ PAGE # _____

SHEET _____ OF _____

SHOW A PLAN VIEW DRAWING DEPICTING THE CORNER MONUMENT AND SURROUNDING PHYSICAL FEATURES, INCLUDING THE EXCAVATION AREA AND DEPTH.

PLANNING & ZONING COMMITTEE ADOPTED THE ABOVE FORM ON 12/2/1982

CORNER CODE V 13

ne607

(B) Describe any record evidence, monument evidence, occupational evidence, testimonial evidence or any other material evidence you considered, and whether the monument was found or placed.

1834 MILLER
2415.6 BUR OAK 12 IN DIA
2640 SET 1/4 SEC. POST B.O 18 S67E 16.5'
BUR OAK 12 N58W 132.66'
2838 ENTER MARSHY GROUND
3162.72 BROOK NE 1.32'
5280 SET POST COR SECS 33, 34, 27, 28 IN MOUND OF EARTH AND SOD.
EAST RANDOM BETWEEN SECS 27 & 34
1007.82 BROOK 1.32' NE
4356 CREEK 9.9' @SE
4468.2 SAME CREEK NE
4554 SAME CREEK SE
4752 LEAVE CREEK BOTTOM
5273.4 SEC LINE 8.58' SOUTH OF POST.
WEST CORRECTED BETWEEN SEC 27 & 34
1290.96 BUR OAK 12
2622.18 BUR OAK 12
2636.7 SET 1/4 SEC POST. BUR OAK 18 N87E 42.9', BUR OAK 15 S1W
67.98
2818.86 BUR OAK 10IN DIA
5260.2 SEC COR.
EAST RANDOM BETWEEN SECS 28 & 33
3960 ENTER MARSHY GROUND
5261.52 INTERSECTED SEC. LINE 2.64' NORTH POST.
WEST MARKER BACK
2630.76 SET 1/4 SEC. POST. BUR OAK 12 N74E 54.12', BUR OAK 12
S7W 17.16'
5261.52 SEC COR.
NORTH BETWEEN SECS 27 & 28
792 ENTER RIDGE OF TIMBER
963.6 B.O. 18 IN
2030.16 BUR OAK 14 INC
2310 RAN IN MARSHY GROUND
2640 SET 1/4 SEC POST BUR OAK 12 S30E 183.48', YELLOW OAK 6
N35W 18.48
3078.9 BUR OAK 18
3762 CREEK BOTTOM MARSHY
3960 CREEK SE
4488 LEAVE CREEK BOTTOM
4537.5 YELLOW OAK 20
5280 SET POST CORNER OF SECS 22, 23, 27, 28 YELLOW OAK 20
N65W 40.92', BUR OAK 14 S82E 91.08'

1863 LOCKE VOL 1 PG 176 2663.76 TO W 1/4 COR SEC 34. VAR OF 5-45 INDICATES W
1/4 COR SEC 34 IS ON LINE WITH NW AND SW CORNERS SEC 34 AT MID WAY. VAR
OF 5-10 INDICATES N 1/4 COR SEC 34 IS ON LINE WITH NE & NW CORNERS OF
SEC 34 AT MID POINT. 2657.16 FROM NW & NE CORNERS. SET STAKE & 3
LIMESTONES.

1865 LOCKE MAP #3274 SET STAKE & 3 LIMESTONES. 2663.76 TO E 1/4 COR SEC
33.

1871 COLLINS
2655.84 REMONUMENTATION NORTH BETWEEN 33 & 34 VARIATION 5
INTERSECT 1/4 LINE 17.82' EAST OF CORNER SET 1/4 STONE
IN PLACE OF STAKE AND STONES AGREEING WITH STUMPS OF
WITNESS TREES.
CORRECTED VARIATION 4-36
CONTINUED NORTH VARIATION 5
5315.64 SET STONE FOR CORNER OF 27, 28, 33, 34 IN OLD MOUND.
EAST RANDOM BETWEEN SECS 27 & 34 VARIATION 5-15
2645.94 SET 1/4 STONE IN PLACE OF STAKE AND STONES AGREEING WITH
STUMP OF WITNESS TREE
CONTINUED EAST
VARIATION 4-30
3965.94 OFFSET 577.5 SOUTH AT RIGHT ANGLE
5295.54 OFFSET NORTH AT RIGHT ANGLE INTERSECTING SEC CORNER AT
584.76'
CORRECTED VARIATION 4-20
EAST RANDOM BETWEEN SECS 28 & 33 VARIATION 3-30
2647.26 INTERSECT 1/4 LINE 5.28' SOUTH OF CORNER SET 1/4 STONE
BY STUMP OF WITNESS TREE. CORRECTED VARIATION 3-23
CONTINUED EAST VARIATION 3-30
5269.44 SECTION CORNER.
NORTH BETWEEN SECS 27 & 28 VARIATION 7-30
2653.2 INTERSECT 1/4 LINE 11.88' WEST OF CORNER SET 1/4 STONE
BY WITNESS TREE WITH COURSE REVERSED. CORRECTED
VARIATION 7-46
CONTINUED NORTH VARIATION 7-30
5320.26 INTERSECT SECTION LINE 40.26' WEST OF CORNER UNDER STRAW
STACK. SET WITNESS STAKES 33' NORTH AND 33' WEST. TO SET

STONE BY WHEN STRAW IS REMOVED. CORRECTED VARIATION 8-
22. OCT. 23, 1871

DUG 5.5' DEEP IN SIDE OF SPOILS FROM DREDGING & FOUND NOTHING. TERRAIN INDICATES THE CUT LIMESTONE SHOULD BE IN. COULD NOT FIND IT. PLACED POLY MONUMENT WITH MAGNETS.

C) Was the corner restored through acceptance of (1) an obliterated evidence location, or, (2) a found perpetuated location?
CORNER RESTORED THROUGH ACCEPTANCE OF OBLITERATED EVIDENCE LOCATION. I PRORATED COLLINS DISTANCE TO THE ADJACENT PLSS CORNERS.

D) Describe any material discrepancy between the location of the corner as restored or reestablished and the location of that corner as previously restored or reestablished by distance and direction. Show the discrepancy on the plan view drawing under (a), above. Show the distances between the corner as previously restored or reestablished and (1) the corner as restored or reestablished, and (2) to at least 4 of the witness monuments shown on the drawing in (a), above.

(E) Was the corner reestablished through lost corner proportionate methods? If so, show the method, including the directions and distances to other public land survey corners used as evidence or used for proportioning the corner location.

I, Donald Barnes, hereby certify that the corner location as identified by the corner code index was determined by me under my direction and control and that this U.S. Public Land Survey Monument Record is correct and complete to the best of my knowledge and belief.

Donald Barnes
seal

March 15, 1999

emboss

Number of included sheets 2

CORNER CODE
A-E 7.08 REQUIREMENT

WOODS

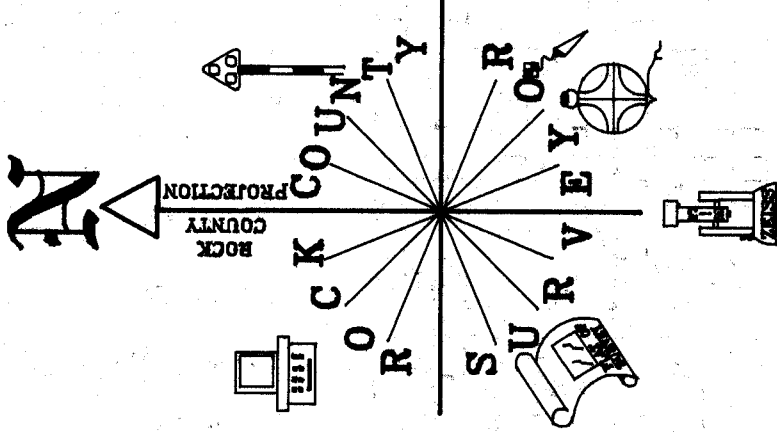
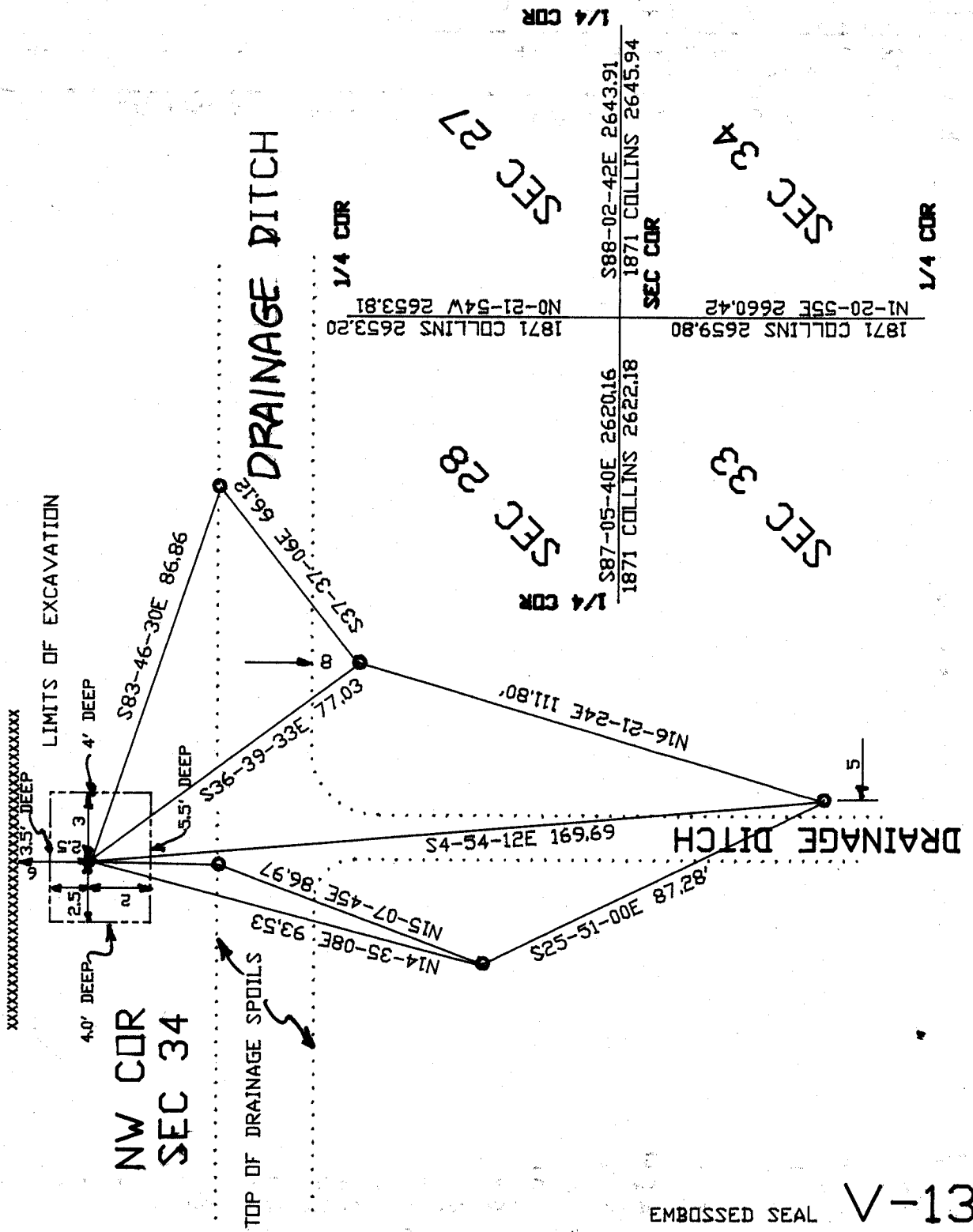

- 1/2X24 REROD WITH PLASTIC CAP
- POLY. MON. WITH CARSONITE & MAGNETS.
- OBSERVATION SHEET #301

NW COR SEC 34

DRAINAGE DITCH

TOP OF DRAINAGE SPOILS

LIMITS OF EXCAVATION

4' DEEP

3.5' DEEP

4' DEEP

4' DEEP

4' DEEP

4' DEEP

4' DEEP

4' DEEP

4' DEEP

696.69 121-54-4S

N14-35-08E 93.53

N15-07-45E 86.97

N14-35-08E 93.53

N15-07-45E 86.97

N14-35-08E 93.53

N16-21-24E 111.80'

S37-37-06E 66.12

S37-37-06E 66.12

S37-37-06E 66.12

S37-37-06E 66.12

S37-37-06E 66.12

S37-37-06E 66.12

S37-37-06E 66.12

S87-05-40E 2620.16
1871 COLLINS 2622.18

S88-02-42E 2643.91
1871 COLLINS 2645.94

N0-21-54W 2653.81
1871 COLLINS 2653.20

N1-20-55E 2660.42
1871 COLLINS 2659.80

1/4 COR

1/4 COR

1/4 COR

1/4 COR

1/4 COR

1/4 COR

1/4 COR

1/4 COR

1/4 COR

1/4 COR

1/4 COR

1/4 COR

SEC 27

SEC 28

SEC 34

SEC 33

EMBOSSED SEAL

V-13