

U.S. PUBLIC LAND SURVEY MONUMENT RECORD

For Public Land Survey Corners in:

WI ADMINISTRATIVE CODE A-E 7.08 REQUIREMENT

T. 1 N., R. 11 E

CORNER CODE INDEX

	1	2	3	4	5	6	7	8	9	10	11	12	13	14	15	16	17	18	19	20	21	22	23	24	25
A																									
B																									
C																									
D																									
E																									
F																									
G																									
H																									
I																									
J																									
K																									
L																									
M																									
N																									
O																									
P																									
Q																									
R																									
S																									
T																									
U																									
V																									
W																									
X																									
Y																									
Z																									

NEWARK TWP
ROCK COUNTY WI

IF AVAILABLE
ROCK COUNTY COORDINATES PREFERRED

North _____ Elev. _____

East _____

Hor. Datum _____ Vert. Datum _____

LATITUDE _____ ELLIPS. HT. _____

LONGITUDE _____

GPS (X) _____ TRAVERSE (X) _____

BASED ON THE FOLLOWING CONTROL:

PLACE MONUMENT SYMBOL AT PROPER LOCATION ON ABOVE INDEX

CORNER MONUMENT

WITNESS MONUMENT

(a)

BEARINGS ARE BASED ON:

FIELD BOOK _____ PAGE # _____

SHEET 1 OF 2

SHOW A PLAN VIEW DRAWING DEPICTING THE CORNER MONUMENT AND SURROUNDING PHYSICAL FEATURES, INCLUDING THE EXCAVATION AREA AND DEPTH.

PLANNING & ZONING COMMITTEE ADOPTED THE ABOVE FORM ON 12/2/1982

CORNER CODE T9

NE596-E1/4-SEC29

(B) Describe any record evidence, monument evidence, occupational evidence, testimonial evidence or any other material evidence you considered, and whether the monument was found or placed.

- 1834 MILLER PG 26 NORTH BETWEEN SEC 28 & 29
330 ENTER MARSH C E
990 LEAVE SAME
1227.6 BUR OAK 18 IN
2640 SET 1/4 SEC POST YELLOW 6 IN S2W165'; BUR OAK 12 IN N4-30E 300.96'
4563.9 BUR OAK 14 IN DIAMETER
4940.1 YELLOW OAK 14 IN DIA
5280 SET POST COR SECS 20,21,28,29 YELLOW OAK 22 IN N87E 133.32'; BUR OAK 22 IN S65W 232.32' LAND 2ND RATE ROLLING SOIL SANDY TIMBER OAK & HICKORY OAK & HAZEL U.G. PRAIRIE GRASS RED ROOT
- 1871 COLLINS. REMONUMENTATION FIELD NOTES PG 177
NORTH BETWEEN 28 & 29 VARIATION 7-15
2640 INTERSECT 1/4 LINE 11.22' WEST OF CORNER SET 1/4 STONE BY STUMP OF WITNESS TREE. CORRECTED VARIATION 7-30
CONTINUED NORTH VARIATION 6-45
5281.32 INTERSECT SECTION LINE 8.58' WEST OF CORNER. SET STONE FOR CORNER OF 20,21,28,29 IN PLACE OF GATE POST BY STUMP OF WITNESS TREE. CORRECTED VARIATION 6-57
- 1959 BATTERMAN VOL 4 PG 27 REFERENCED CORNER BUT STATES NOTHING ABOUT CORNER. SKETCH SHOWS 3' EAST OF WEST PVMT EDGE
- 1973 LEE #4262 1335.10 WEST TO 1/16TH COR & ANGLE OF 90-24-08 @ E 1/4 COR SEC 29 FROM SE TO W 1/4 COR SEC 29
- 1989 COMBS #1389 2636.76 TO SW COR SEC 28
1990 KREBS #11999 NORTH 1318.31 TO 1/16TH COR
1996 COMBS CSM 20 PG 225 2636.65 TO NW COR SEC 28

FD R/R SPIKE 0.1' DEEP, SW REFERENCE PIN, BENT NE REFERENCE PIN, BENT SE REFERENCE PIN, & THE NW REFERENCE PIN LAYING ON TOP OF THE GROUND. REPLACED NE & SE PINS WITH 3/4X24" REROD/CAP. DROVE FOUND NW PIN FLUSH WITH GROUND. FD 1/2" REROD 1.1' DEEP. 14" DEEP FOUND PIECES OF BARB WIRE. 24" DEEP FD PIECES OF CUT L.S. REPLACED REROD WITH ALUM. MON.

C) Was the corner restored through acceptance of (1) an obliterated evidence location, or, (2) a found perpetuated location?

ACCEPTED FOUND PERPETUATED LOCATION.

D) Describe any material discrepancy between the location of the corner as restored or reestablished and the location of that corner as previously restored or reestablished by distance and direction. Show the discrepancy on the plan view drawing under (a), above. Show the distances between the corner as previously restored or reestablished and (1) the corner as restored or reestablished, and (2) to at least 4 of the witness monuments shown on the drawing in (a), above.

THE FOUND R/R SPIKE DID NOT AGREE WITH THE FOUND REROD.

I, Donald Barnes, hereby certify that the corner location as identified by the corner code index was determined by me under my direction and control and that this U.S. Public Land Survey Monument Record is correct and complete to the best of my knowledge and belief.

seal

Donald Barnes

emboss

6-14-01

Number of included sheets 1

CORNER CODE T-9

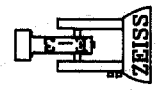
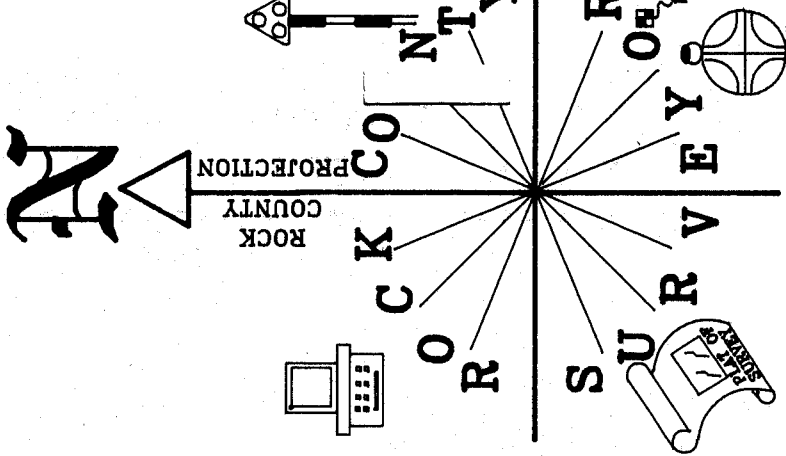

OBSERVATION SHEET #19 & 5

NEWARK TWP
T1N R11E

W 1/4 COR
SEC 28

FD 1.1 DEEP 1/2"
REROD & PIECES OF
CUT L.S. 14" DEEP
FD PIECES OF
BARB WIRE
0.1' DEEP
SET ALUM. MON.

FD R/R SPIKE
0.1 DEEP

FOUND BENT 3/4X36"
PIN, REPLACED WITH
3/4X24" REROD/
CAP

FIELD

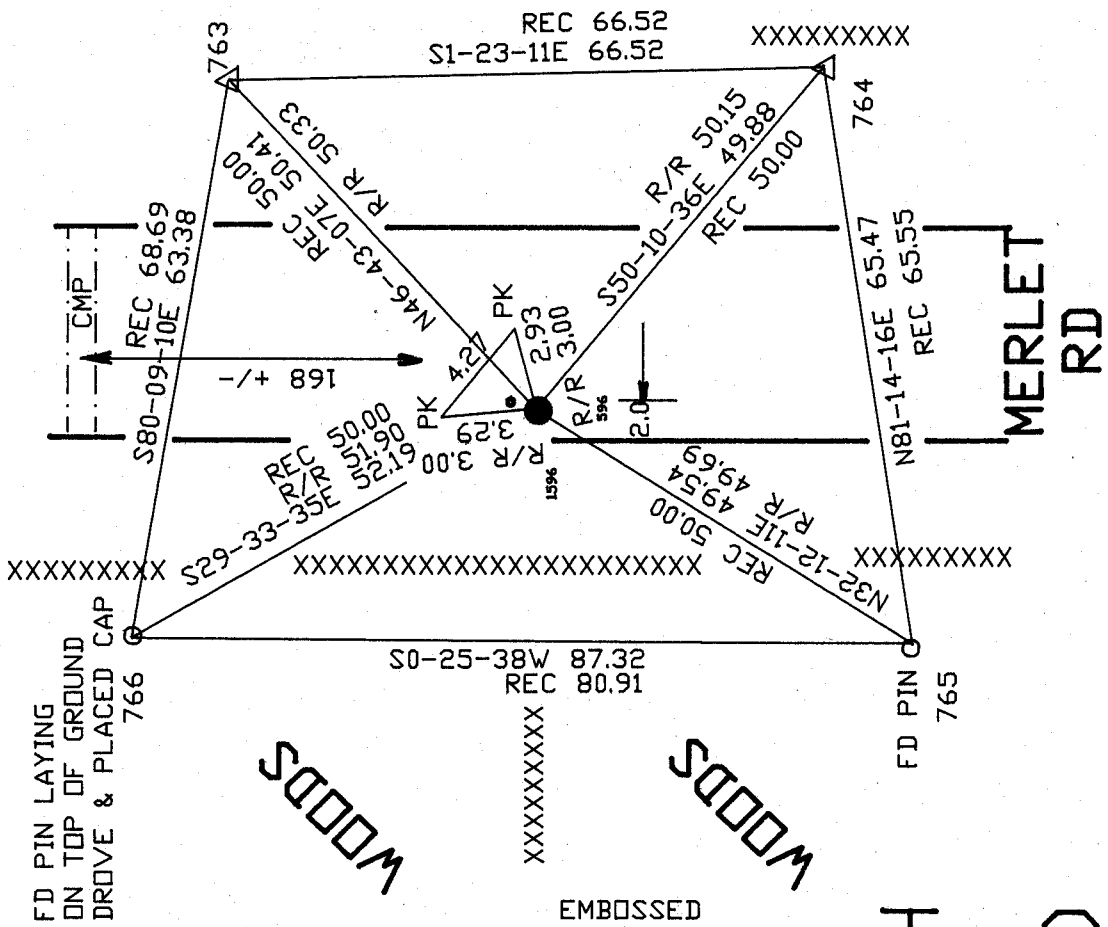

T-9

Donald Barnes
6-14-01