

PLAT AND RECORD

PG 161 JANESVILLE
REC 12/12/75 DAB

Of a Survey on Section S.W. 1/4 Sec 13 T 2 N. R 10 E. of the 4 P. M. in Spring Valley Township

Rock County, Wisconsin, made February the 13 1932

I hereby certify that the following is a correct record of said survey as made by me.

COUNTY BUILDING
IN CITY OF БЕЛОIT

B. J. Bunney
County Surveyor.

NOTE:

These monuments were referenced by R.H. Batterman Oct. 4, 1929 preparatory to paving highway #92 and reset by me as shown.

S.W. 1/4 Sec. 13

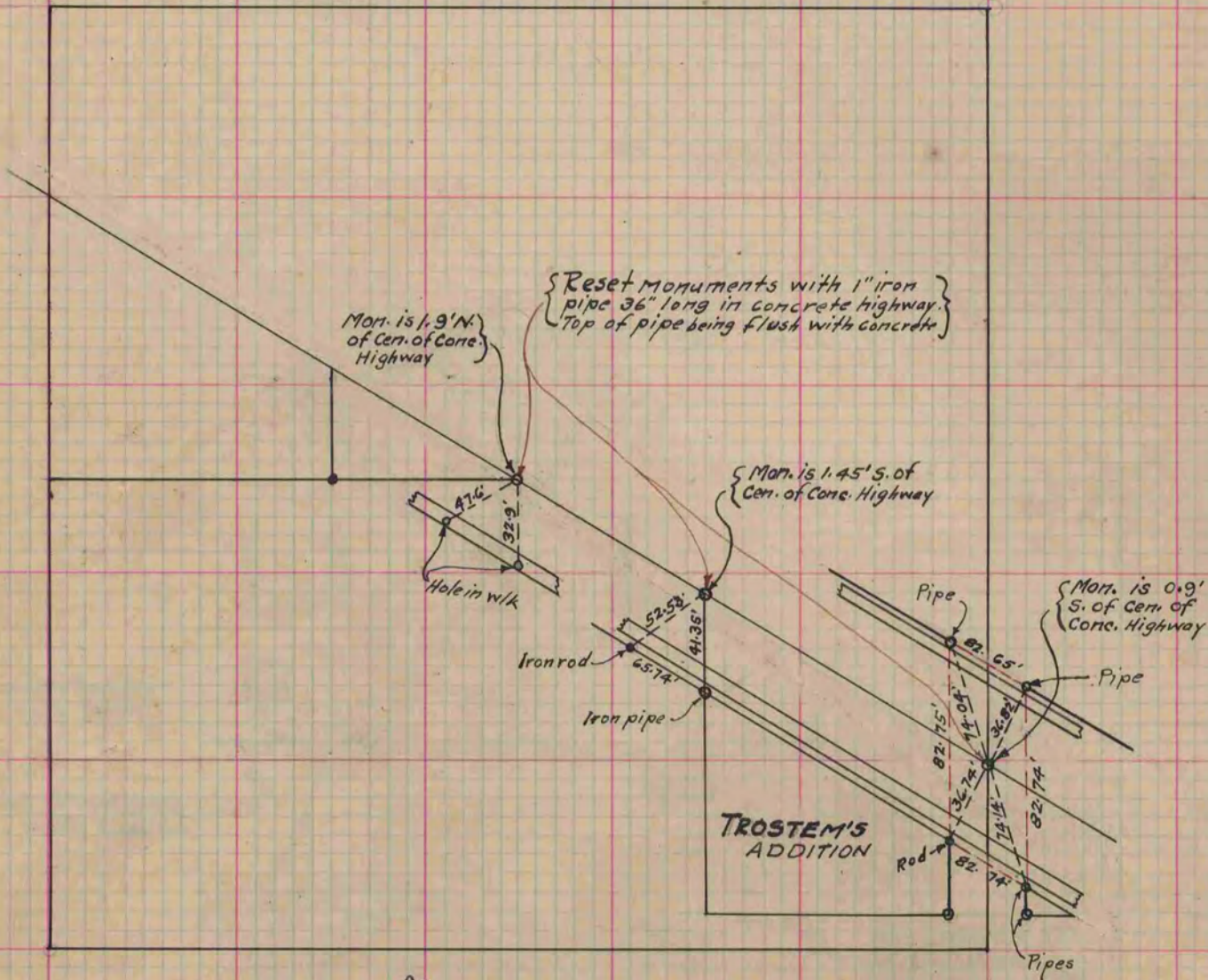

also page 143