

# U.S. PUBLIC LAND SURVEY MONUMENT RECORD

For Public Land Survey Corners in:

WI ADMINISTRATIVE CODE A-E 7.08 REQUIREMENT

T. 1 N., R. 12 E 4th P.M.

## BELOIT TWP

TWP

CORNER CODE INDEX

ROCK COUNTY, WI

IF AVAILABLE  
ROCK COUNTY COORDINATES PREFERRED

A	1	2	3	4	5	6	7	8	9	10	11	12	13	14	15	16	17	18	19	20	21	22	23	24	25
B						6																			
C						5																			
D						4																			
E						3																			
F						2																			
G						1																			
H						7																			
J						8																			
K						9																			
L						10																			
M						11																			
N						12																			
O						13																			
P						14																			
Q						15																			
R						16																			
S						17																			
T						18																			
U						19																			
V						20																			
W						21																			
X						22																			
Y						23																			
Z						24																			

North 217,093.31 Elev. \_\_\_\_\_

East 480,366.76

Hor. Datum COUNTY Vert. Datum \_\_\_\_\_

LATITUDE \_\_\_\_\_ ELLIPS. HT. \_\_\_\_\_

LONGITUDE \_\_\_\_\_

ELLIPS. DATUM  
NAD83(91) \_\_\_\_\_ COUNTY \_\_\_\_\_ LIST \_\_\_\_\_

GPS (X) \_\_\_\_\_ TRAVERSE (X) \_\_\_\_\_

BASED ON THE FOLLOWING CONTROL:

PLACE MONUMENT SYMBOL  AT PROPER LOCATION ON ABOVE INDEX

 CORNER MONUMENT

WITNESS MONUMENT

(a)

BEARINGS ARE BASED ON:

FIELD BOOK \_\_\_\_\_ PAGE # \_\_\_\_\_

SHEET 1 OF 3

SHOW A PLAN VIEW DRAWING DEPICTING THE CORNER MONUMENT AND SURROUNDING PHYSICAL FEATURES, INCLUDING THE EXCAVATION AREA AND DEPTH.

PLANNING & ZONING COMMITTEE ADOPTED THE ABOVE FORM ON 12/2/1982

CORNER CODE N-13

BE567

(B) Describe any record evidence, monument evidence, occupational evidence, testimonial evidence or any other material evidence you considered, and whether the monument was found or placed.

1834 HARRISON NORTH BETWEEN SECS 21 & 22

1320 TO THE SUMMIT OF RIDGE E & W

2310 TO THE TRAIL TO TURTLE VILLAGE

2640 QUARTER SEC COR.

SET POST & RAISED MOUND ON GROUND DESCENDING EAST

5280 SET COR TO SECS 15,16,21,22 SET POST & RAISED MOUND. AT THE HEAD OF SMALL RAVEN CRS E.

NORTH BETWEEN SECTIONS 26 & 27

33 TO THE RANDOM STATE LINE

1782 TO A LARGE DROUGHT CRS E & LEAVE PRAIRIE

2640 QUARTER SEC CORNER ON GROUND SLOPING SOUTH EASTWARDLY TO DRAUGHT. SET A POST & RAISED A MOUND

3300 A DRAUGHT CRS S.E.

5214 TO A TRAIL CRS S.E. (SEE BELOW)

5280 COR TO SECS 22, 23,26, 27 ON GROUND SLOPING NORTHWARDLY. SET A POST & RAISED A MOUND.

THE TRAIL MENTIONED AT 5214' IS THE DIRECT RAIL FROM PRAIRIE DE CHAIN TO CHICAGO VIA THE BLUE MOUNDS-THENCE BY DAUGHERTY-THENCE BY WINNOCECKS VIL. OPPOSITE D ????? SUGAR RIVER THENCE BY TURTLE VILLAGE TO CHICAGO SAID TO BE A FINE HERETOFORE A ? FREQUENTED ROUTE.

EAST ON RAND BET. SECS 16 & 21

660 ENTER BOTTOM

1254 BROOK 1.32 CRS S (NEAR THE HEAD)

1782 TO A TRAIL HEADING TO TURTLE VILLAGE

2112 LEFT BOTTOM CRS S.W.

2640 TEMPY 1/4 SEC COR.

5258.88 INT E BDY 66 SOUTH OF POST.  
COR WEST

2629.44 QUARTER SEC COR. SET A POST & RAISED MOUND ON GROUND DESCENDING S.W.

5258.88 SEC COR.

EAST ON RANDOM BETWEEN SECS 15 & 22

2640 TEMPY 1/4 SEC COR

3300 DESCEND INTO LOW WET GROUND CRS E

4620 LEFT SAME

5214 INT. E BOUNDARY 19.8 NORTH OF POST

COR. WEST BET. SECS 15 & 22

2607 QUARTER SEC COR SET POST AND RAISED MOUND ON A SMALL POINT DESCENDING NE.

5214 SEC COR.

1850 TOWN ROAD RECORDS BK 1 PG 120 DESCRIPTION BEGINS AT CORNER.

1856 TOWN ROAD RECORDS BK 1 PG 287 DESCRIPTION BEGINS AT CORNER.

1963 CTH "Q" PROJECT #51429(1) SHEET 4.2 FOUND MONUMENT BOX & REFERENCED SAME.

1963 BATTERMAN VOL 4 PG 182 REFERENCED COR. 2657.05 TO N 1/4 COR SEC 21.

1980 COMBS CSM V9 PG 189 FOUND MON. BOX 2616.2 TO N 1/4 COR SEC 22.

1987 COMBS CSM V13 PG 144 FOUND PIPE IN MONUMENT BOX.

FOUND PIPE IN MONUMENT BOX.

C) Was the corner restored through acceptance of (1) an obliterated evidence location, or, (2) a found perpetuated location?  
ACCEPTED FOUND PERPETUATED LOCATION

N-13

D) Describe any material discrepancy between the location of the corner as restored or reestablished and the location of that corner as previously restored or reestablished by distance and direction. Show the discrepancy on the plan view drawing under (a), above. Show the distances between the corner as previously restored or reestablished and (1) the corner as restored or reestablished, and (2) to at least 4 of the witness monuments shown on the drawing in (a), above.

(E) Was the corner reestablished through lost corner proportionate methods? If so, show the method, including the directions and distances to other public land survey corners used as evidence or used for proportioning the corner location.

NO

I, Donald Barnes, hereby certify that the corner points as identified by the corner code index were, in a field survey on, established, re-established, monumented, re-monumented, recovered or restored as expressed below and in conformance with the regulations and rules as required in the current manual of survey instructions of the United States Department of Interior, Bureau of Land Management.

COUNTY SURVEYOR FILING DATA

seal

Date of computer entry \_\_\_\_\_

Date microfilmed \_\_\_\_\_

Number of included sheets \_\_\_\_\_

CORNER CODE

EMBOSS LAND SURVEYOR SEAL

A-E 7.08 REQUIREMENT

OCT 9, 1998

N-13

Donald Barnes  
 Oct 19, 1998

CTH "Q"

STA #229 3/4X24" REROD;  
 5.5' SOUTH OF SOUTH  
 EDGE PVMT.

FD ILL; DOT PLASTIC  
 CAP ON REROD; PAINTED  
 9426

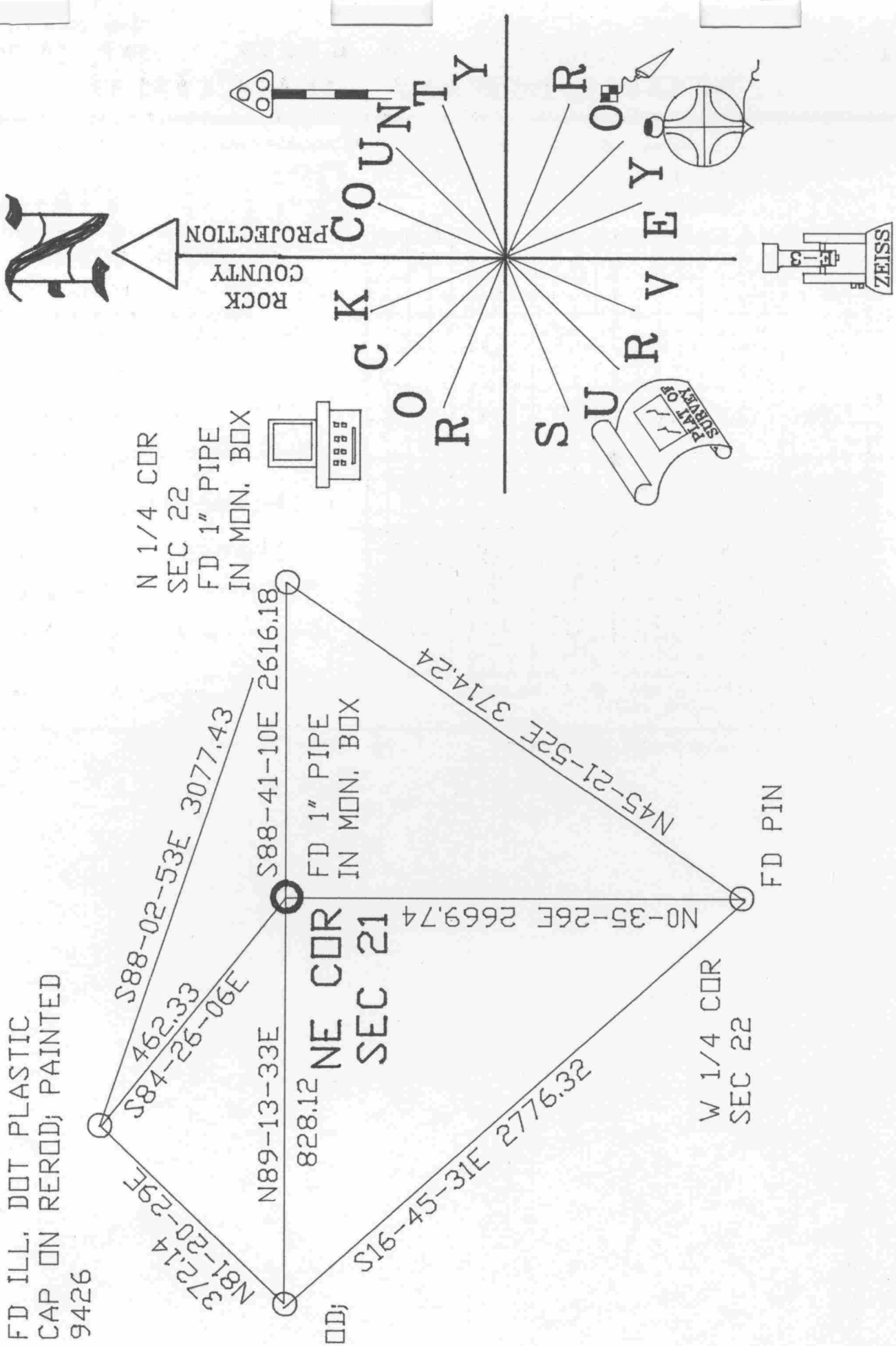

N-13