

PLAT AND RECORD

Of a Survey on Section 31 T 3 R 13 E. of the 4 P. M. in Harmony Township
Rock County, Wisconsin, made November the 23rd 1959

I hereby certify that the following is a correct record of said survey as made by me.

COUNTY BUILDING
IN CITY OF DELOIT

County Surveyor.

*A record and plat of a Survey made in retracing that part of the
shown on the plat between a & b. Variations marked on the*

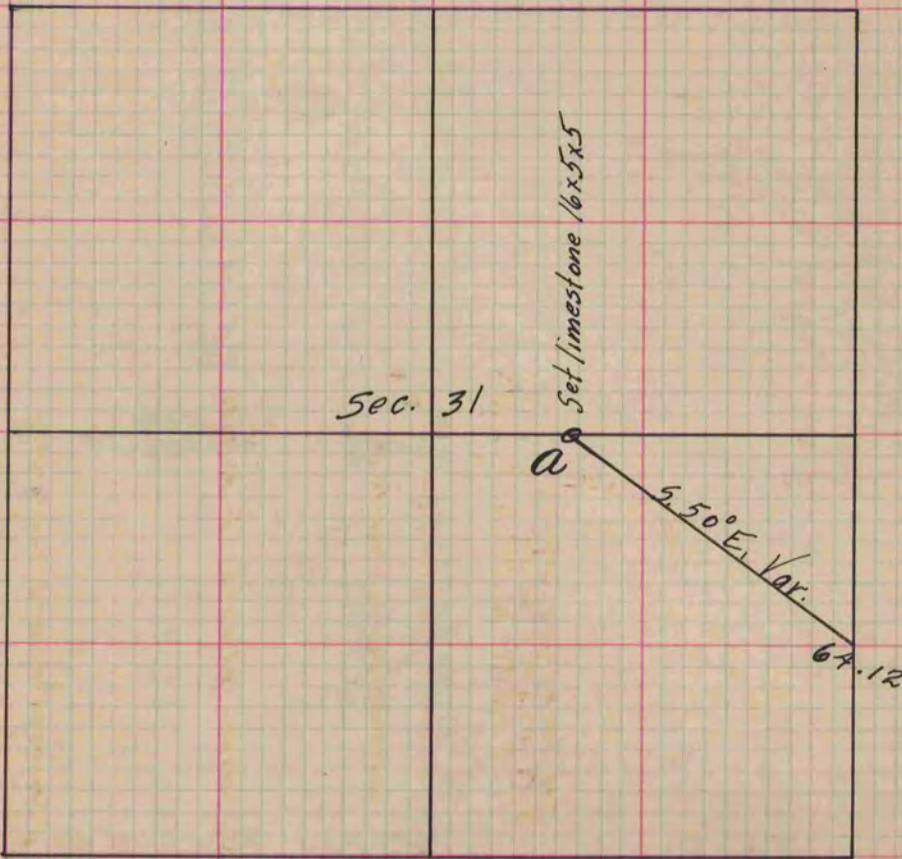

Copied from Pages 127 and 128 Volume