

# PLAT AND RECORD

Of a Survey on Section 7 T 2 R 12 E. of the 4 P. M. in Rock Township

Rock County, Wisconsin, made July the 9 1866

I hereby certify that the following is a correct record of said survey as made by me.

COUNTY BUILDING  
IN CITY OF BELOIT

(Signed) S.D. Locke  
S.D.L.

County Surveyor.

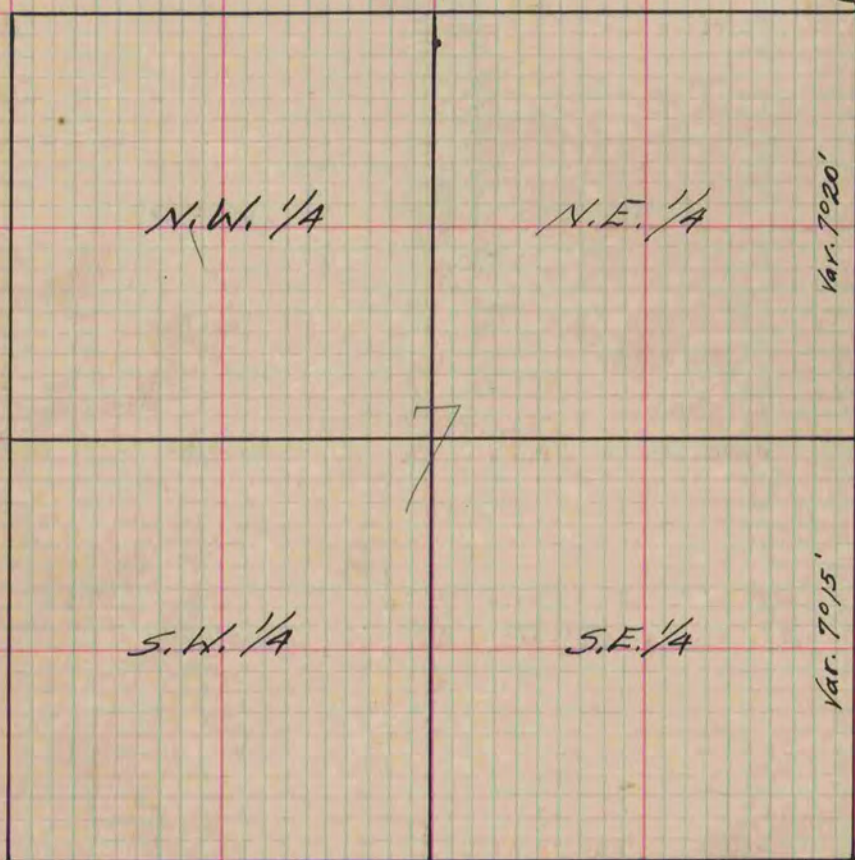

(B.T. gone - Found old stake set B.T. stake with hard on N.W. 1/4 + E. + lime on N.W.)

Var. 7020'

N.W. 1/4

N.E. 1/4

Var. 7015'

S.W. 1/4

S.E. 1/4

Found stumps of B.T. + old stake - set B.T. surrounded by 3 hard's.

Found N.B.T. + stump of E.B.T. + old stake - set stake with lime on E. + large hard on S. + smaller hard on N. + W.

Copied from Page 237 Vol. 1. Original County Surveyor's Record.