

PLAT AND RECORD

Of a Survey on Section 26 T 2 R 11 E. of the 4 P. M. in Plymouth Township
 Rock County, Wisconsin, made March the 15th & 16th 1869

I hereby certify that the following is a correct record of said survey as made by me.

COUNTY BUILDING
 IN CITY OF BELOIT

(Signed) R. H. Lee
R.H.L. County Surveyor.

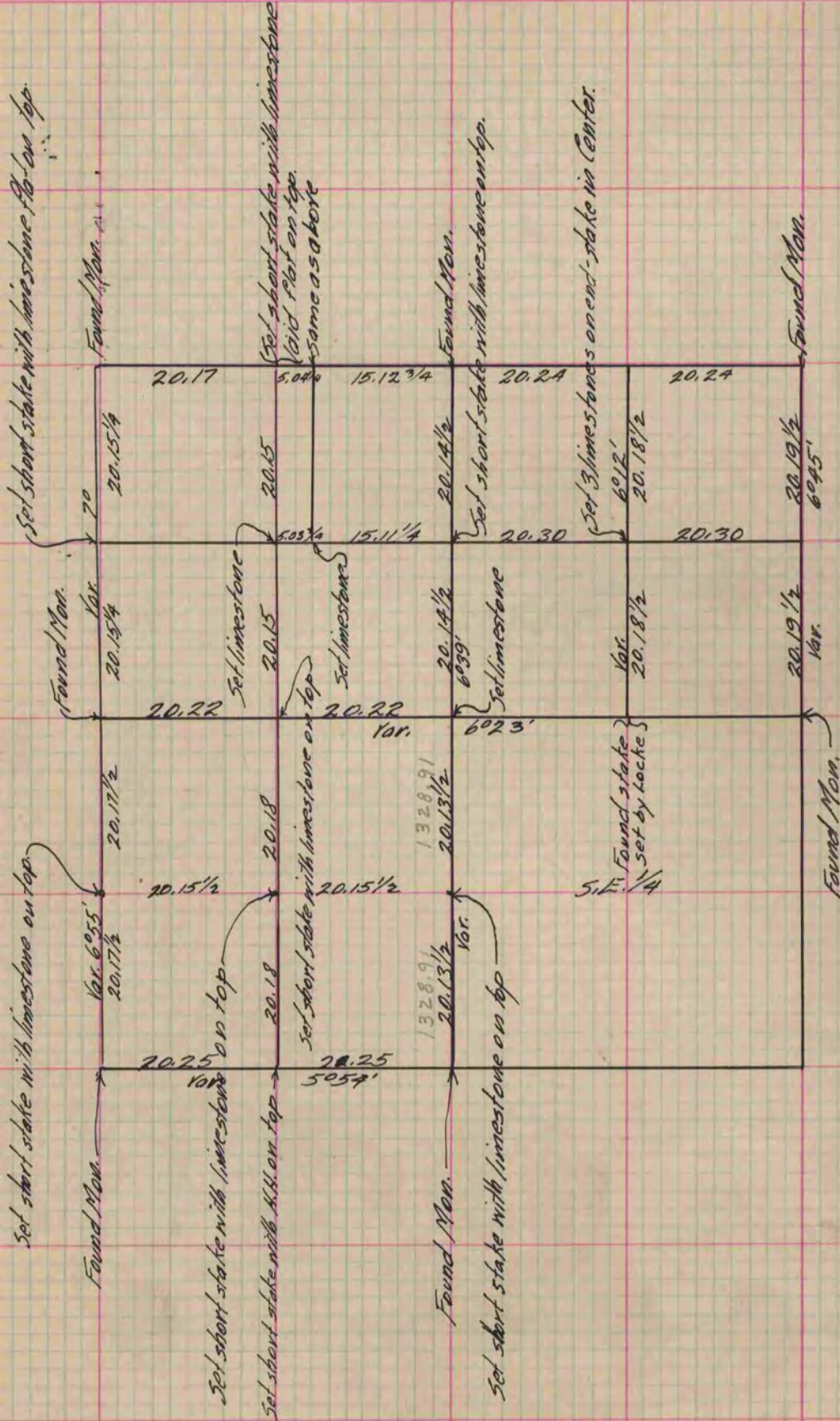

Copied from Lower 1/2 P. 276 Vol. 1 County Surveyor's Record.