

# PLAT AND RECORD

485

Of a Survey on <sup>SW 1/4</sup> Section 6 T 2 R 14 E. of the 4 P. M. in Bradford Township

Rock County, Wisconsin, made March the 12 1894

I hereby certify that the following is a correct record of said survey as made by me.

COUNTY BUILDING  
IN CITY OF БЕЛОIT

(Signed) O.G. Bleedorn  
O.A.B.

County Surveyor.

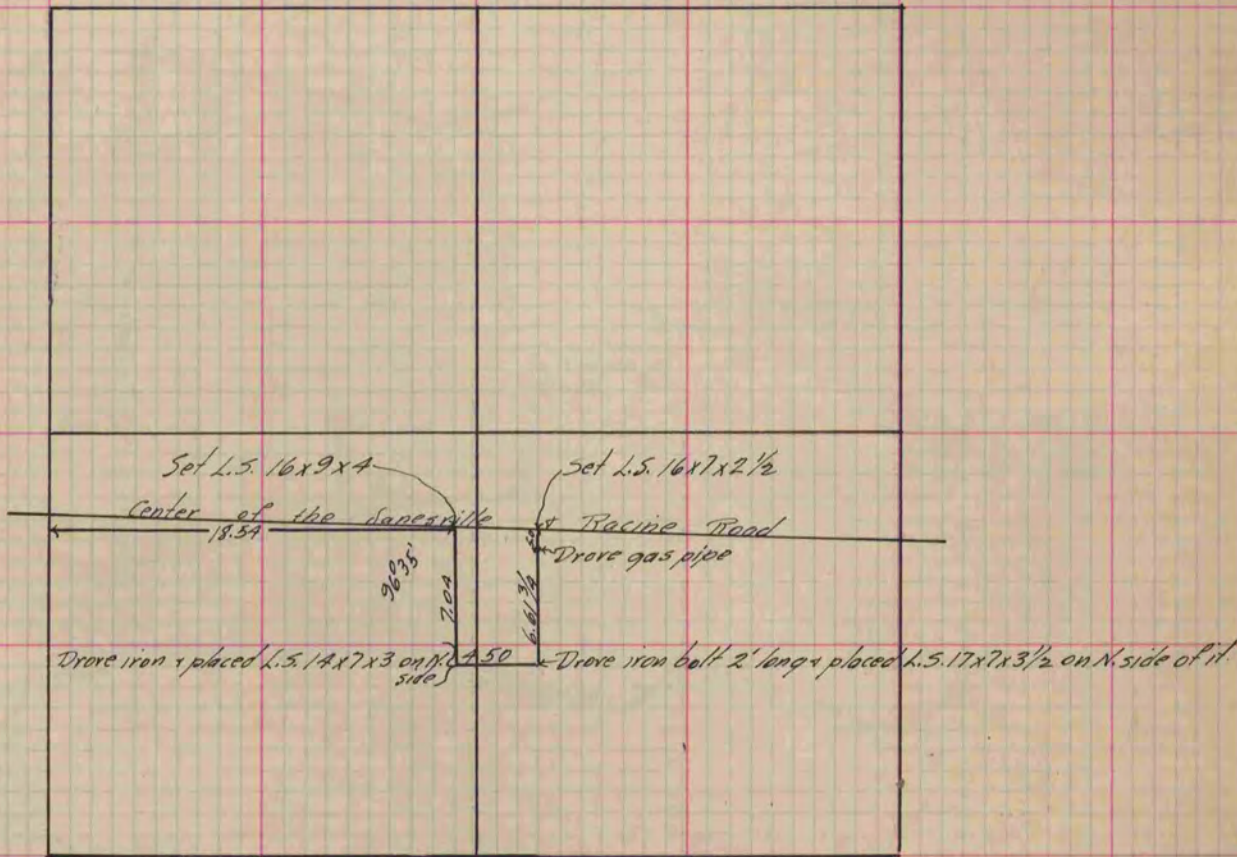

Copied from P. 376 Vol 2 County Surveyors Record.