

# PLAT AND RECORD

Of a Survey on Section 16 T 4 R 13 E. of the 4 P. M. in Milton Township

Rock County, Wisconsin, made July the 20th 19 72

I hereby certify that the following is a correct record of said survey as made by me.

COUNTY BUILDING  
IN CITY OF БЕЛОIT

*Hugh J. Dee*  
County Surveyor.

At N.E. Cor, Sec. 16  
Dug & Fd. cut stone  
7/20/72  
R.B.  
T.M.

Set C.I. & Ref.  
7/21/72  
M.L.  
T.M.

See Page 137 Vol. 4

18"  
HICKORY

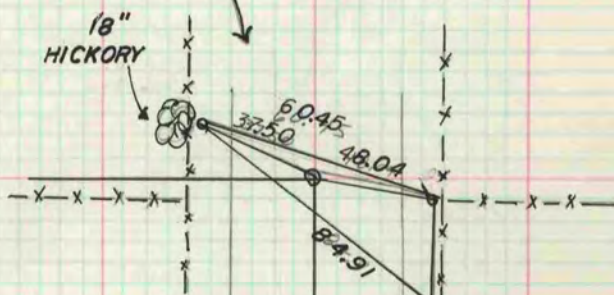

See Page 363 Vol. 4

16

SE RNS  
RD.

SEE Page 464

See Page 137 Vol. 4

SEE PAGE 584 VOL. 4



COUNTY BUILDING  
IN CITY OF БЕЛОIT