

PLAT AND RECORD

Of a Survey on Section 19 T 2N R 14 E. of the 4 P. M. in BRADFORD Township

Rock County, Wisconsin, made JULY the 21 1967

I hereby certify that the following is a correct record of said survey as made by me.

**COUNTY BUILDING
IN CITY OF BELOIT**

R. B. Atteman Jr.

County Surveyor.

THE GEO. D. BARNARD COMPANY, ST. LOUIS

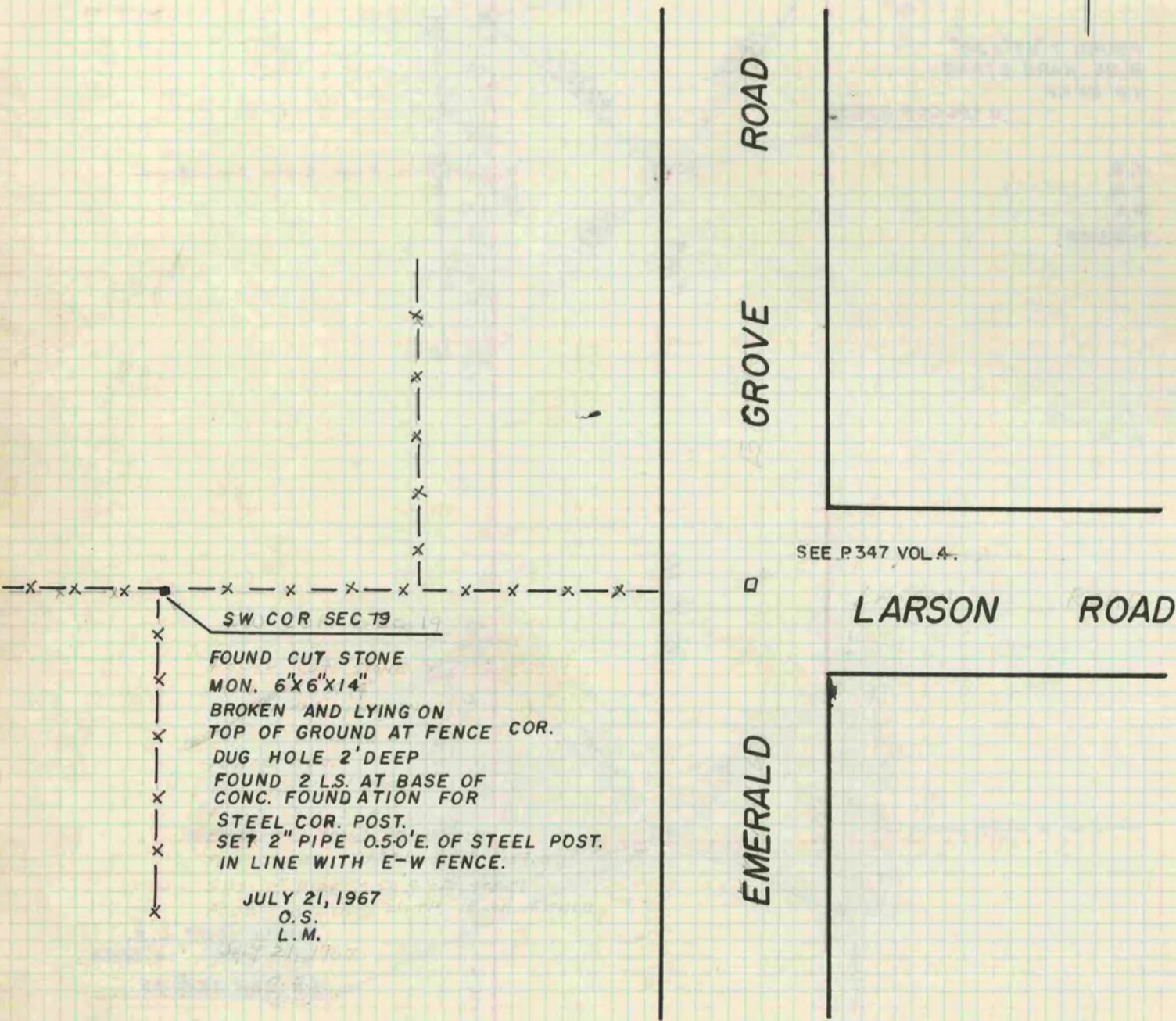

SW COR SEC 19

FOUND CUT STONE
MON. 6"X6"X14"
BROKEN AND LYING ON
TOP OF GROUND AT FENCE COR.
DUG HOLE 2' DEEP
FOUND 2 L.S. AT BASE OF
CONC. FOUNDATION FOR
STEEL COR. POST.
SET 2" PIPE 0.50'E. OF STEEL POST.
IN LINE WITH E-W FENCE.

JULY 21, 1967
O.S.
L.M.

SEE P. 347 VOL. 4.

GROVE ROAD

EMERALD

LARSON ROAD