

# PLAT AND RECORD

Of a Survey on Section 3 T 1 R 14 E. of the 4 P. M. in Clinton Township  
Rock County, Wisconsin, made September the 20th 1955

I hereby certify that the following is a correct record of said survey as made by me.

COUNTY BUILDING  
IN CITY OF БЕЛОIT

(Signed) Joseph Church  
JMC

County Surveyor.

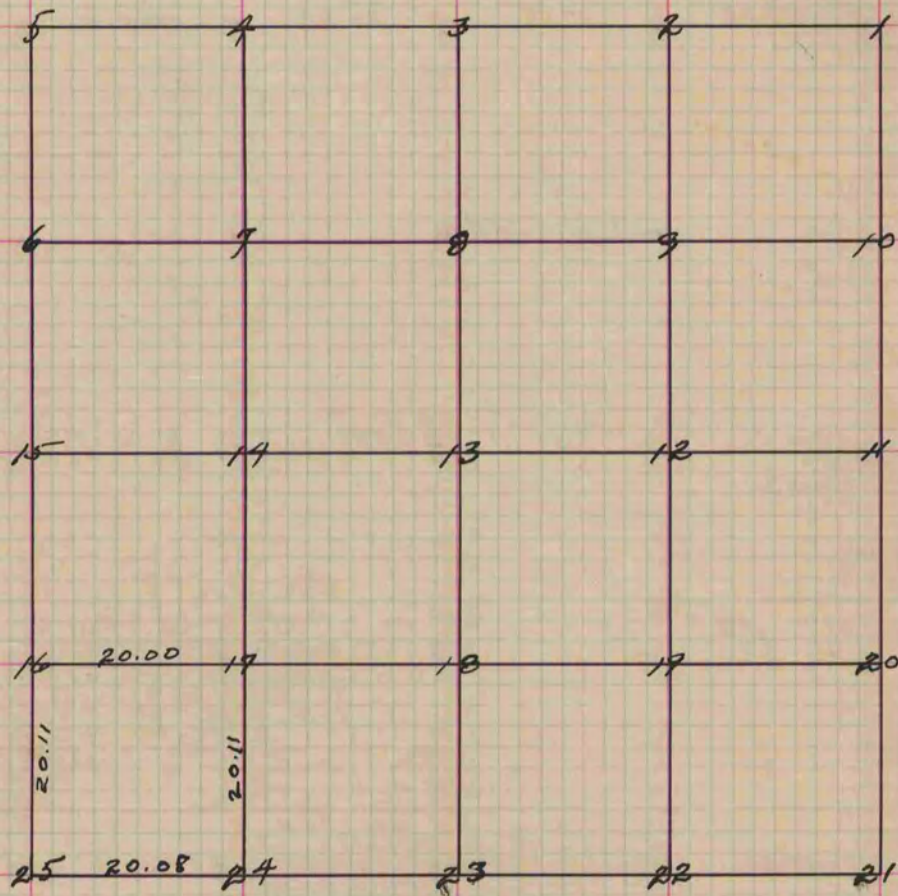

Fig. 16-17-24 & 25 Stakes & Stones fixed in the ground.  
16 & 25 are 50 links East of the Centre of the Highway

Copied from Page 52 Vol. 1 Original County Surveyor's Records.