

PLAT AND RECORD

Of a Survey on Section 30 T 2 R 12 E. of the 4 P. M. in Rock Township
Rock County, Wisconsin, made April the 6th 1855

I hereby certify that the following is a correct record of said survey as made by me.

COUNTY BUILDING
IN CITY OF BELOIT

(Signed) Joseph Church
R.H.B. County Surveyor.

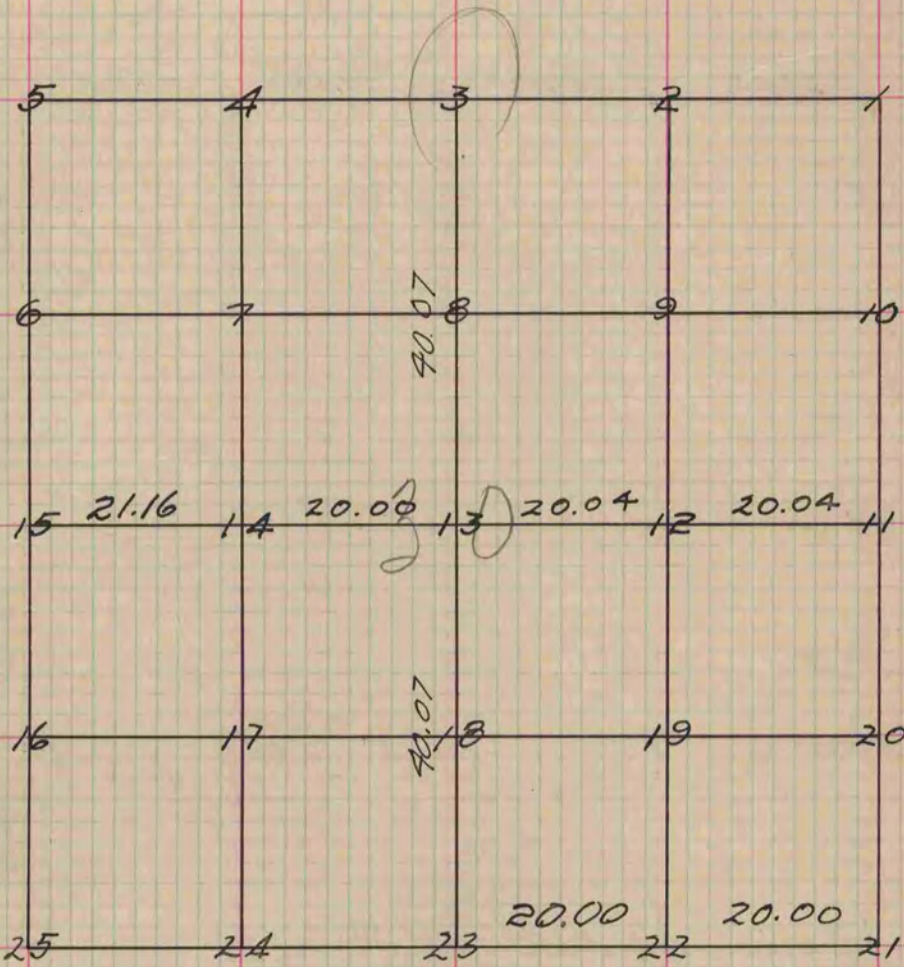

- Fig. 13 W.O. 12 N. $35\frac{1}{4}$ W. 85 links.
- " 12 Black O. N. 55 E. 76 "
- " 14 Bur. O. N. $10\frac{1}{2}$ E. 106 "
- " " W.O. S. $8\frac{1}{2}$ W. 144 "
- " 22 W. O. S. 55 E. 113 "
- " " Bl. O. S. 66 W. 190 "

Copied from Page 32 Vol. 1. Original County Surveyors Record