

PLAT AND RECORD

Of a Survey on Section 22 T 2 R 10 E. of the 4 P. M. in Spring Valley Township

Rock County, Wisconsin, made April the 1st 1857

I hereby certify that the following is a correct record of said survey as made by me.

Joseph Church by Chas. H. Brown

(Signed) Deputy County Surveyor.

CHB

County Surveyor.

COUNTY BUILDING
IN CITY OF BELoit

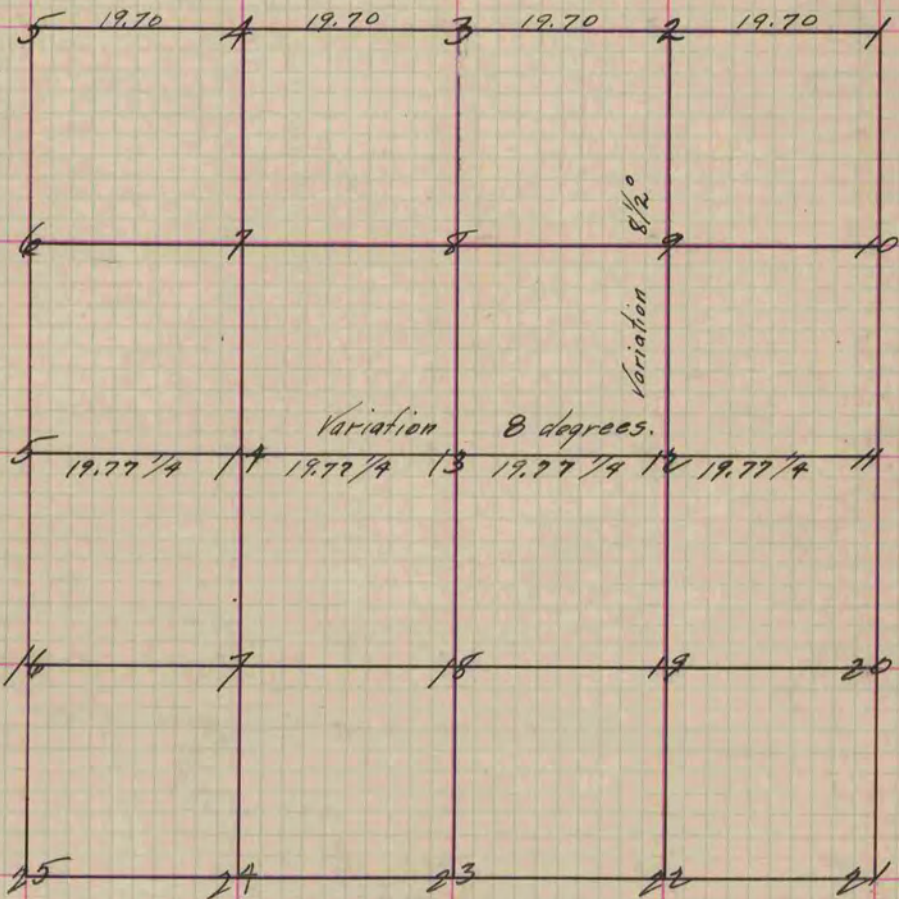

- Fig. 12 Stump 10 inches N. 7 1/2 E. 9 1/2 links.
- S. 22 1/2 W. 40 "
- " 13 W. 0. 12 " N. 76 W. 108 "
- Br. 0. 12 " N. 60 E. 140 "
- " 14 W. 0. 20 " N. 31 1/2 W. 36 "
- Stump " " S. 11 1/2 W. 11 1/4 "

Copied from Page 72 Vol. 1 Original County Surveyors Record.