

# PLAT AND RECORD

Of a Survey on Section 13 T A R 13 E. of the 4 P. M. in Milton Township  
Rock County, Wisconsin, made \_\_\_\_\_ the \_\_\_\_\_ 19\_\_\_\_

I hereby certify that the following is a correct record of said survey as made by me.

COUNTY BUILDING  
IN CITY OF BELOIT

(signed) P.F. Brown  
P.F.B.

County Surveyor.

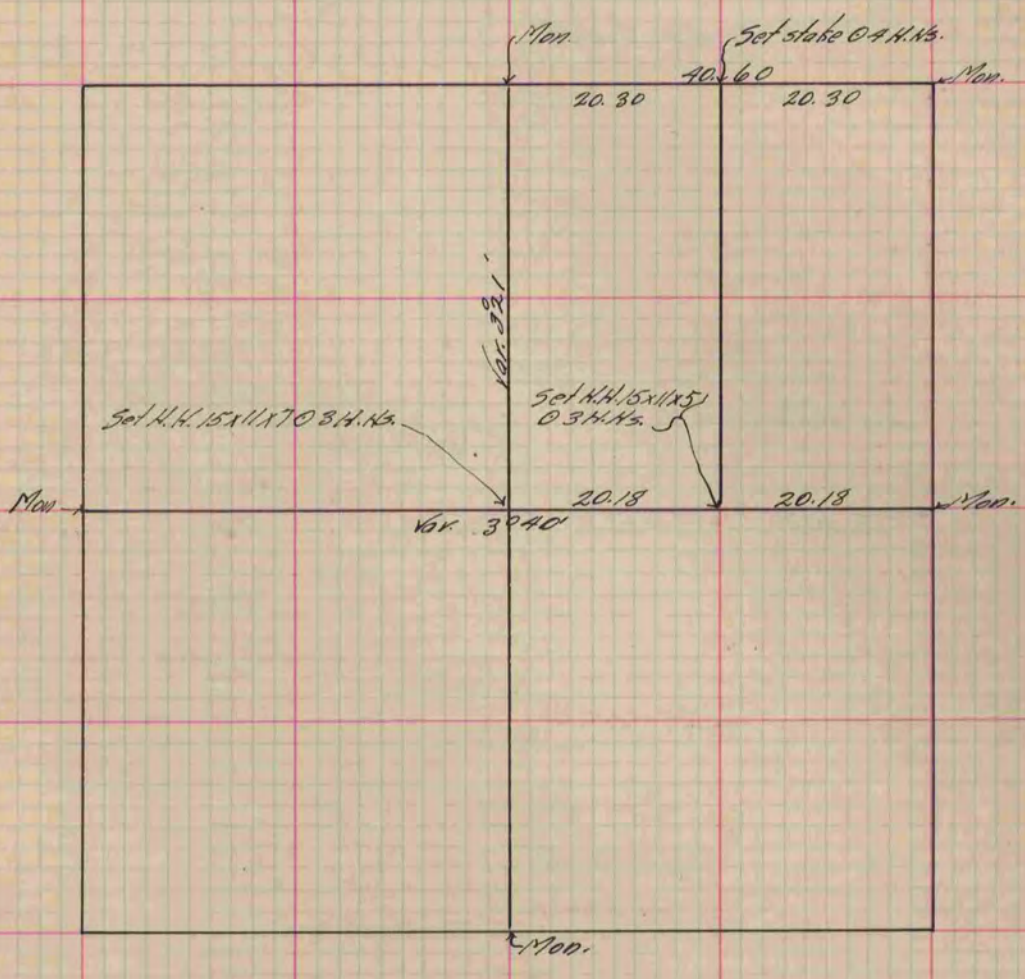

Copied from P. 380 Vol. 2 County Surveyors Record.