

U.S. PUBLIC LAND SURVEY MONUMENT RECORD

For Public Land Survey Corners in the

T. A.N., R. 11 E.

CORNER CODE INDEX

| | | | | | | | | | | | | | | | | | | | | | | | | | |
|---|----|----|---|---|---|---|---|---|---|----|----|----|----|----|----|----|----|----|----|----|----|----|----|----|----|
| | 1 | 2 | 3 | 4 | 5 | 6 | 7 | 8 | 9 | 10 | 11 | 12 | 13 | 14 | 15 | 16 | 17 | 18 | 19 | 20 | 21 | 22 | 23 | 24 | 25 |
| A | | | | | | | | | | | | | | | | | | | | | | | | | |
| B | | | | | | | | | | | | | | | | | | | | | | | | | |
| C | 8 | | | | | | | | | | | | | | | | | | | | | | | | |
| D | | 5 | | | | | | | | | | | | | | | | | | | | | | | |
| E | ◆ | | | | | | | | | | | | | | | | | | | | | | | | |
| F | | | | | | | | | | | | | | | | | | | | | | | | | |
| G | 7 | | | | | | | | | | | | | | | | | | | | | | | | |
| H | | 6 | | | | | | | | | | | | | | | | | | | | | | | |
| I | | | | | | | | | | | | | | | | | | | | | | | | | |
| J | | | | | | | | | | | | | | | | | | | | | | | | | |
| K | | | | | | | | | | | | | | | | | | | | | | | | | |
| L | 18 | | | | | | | | | | | | | | | | | | | | | | | | |
| M | | 17 | | | | | | | | | | | | | | | | | | | | | | | |
| N | | | | | | | | | | | | | | | | | | | | | | | | | |
| O | | | | | | | | | | | | | | | | | | | | | | | | | |
| P | 19 | | | | | | | | | | | | | | | | | | | | | | | | |
| Q | | 20 | | | | | | | | | | | | | | | | | | | | | | | |
| R | | | | | | | | | | | | | | | | | | | | | | | | | |
| S | | | | | | | | | | | | | | | | | | | | | | | | | |
| T | 30 | | | | | | | | | | | | | | | | | | | | | | | | |
| U | | 29 | | | | | | | | | | | | | | | | | | | | | | | |
| V | | | | | | | | | | | | | | | | | | | | | | | | | |
| W | | | | | | | | | | | | | | | | | | | | | | | | | |
| X | 31 | | | | | | | | | | | | | | | | | | | | | | | | |
| Y | | 32 | | | | | | | | | | | | | | | | | | | | | | | |
| Z | | | | | | | | | | | | | | | | | | | | | | | | | |

PLACE MONUMENT SYMBOL (◆) AT PROPER LOCATION ON ABOVE INDEX

EXAMPLE

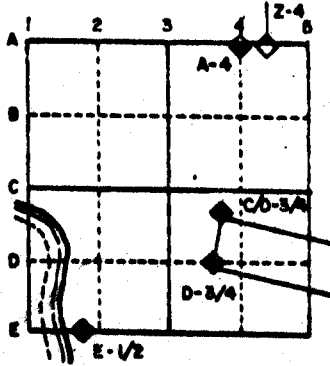

PORTER TWP
ROCK COUNTY WI

IF AVAILABLE STATE PLANE COORDINATES

North (Y) _____ Eleve. (Z) _____
 East (X) _____ Zone _____
 Hor. Datum _____ Vert. Datum _____

d.)

◆ CORNER MONUMENT

○ WITNESS MONUMENT

BEARINGS ARE BASED ON:

MICROFILMED

SHEET 1 OF 2

CORNER CODE: E 3

(b) Describe any record evidence, monument evidence, occupational evidence, testimonial evidence or any other material evidence you considered, and whether the monument was found or placed.

1893 BLEEDORN VOL 2 PG 473 FOUND STAKE IN MOUND. PUT SMALL LIMESTONE AROUND IT. SHOWS A DISTANCE OF 2663.76 TO THE SOUTH EAST CORNER. USED CORNER TO SUBDIVIDE SECTION 6.

1933 SUNNY VOL 3 PG 237 SHOWS A DISTANCE FROM THE SW TO SE CORNERS OF SECTION 6. ALSO SHOWS A DISTANCE TO THE CENTER OF SECTION 6. DOES NOT STATE WHAT HE PLACED. SHOWS THAT THE CENTER OF GRAVEL ROAD IS 13.9' EAST OF THE CORNER.

1940 SUNNY VOL 3 PG 465 CORNER DESTROYED IN CONSTRUCTING CULVERT.

1952 SUNNY PLAT OF SURVEY. SET R.R. SPIKE IN BLACKTOP ROAD AT N1/4 CORNER OF SECTION 7. SHOWS BEARINGS AND DISTANCES TO PROPERTY CORNERS TO THE SOUTH AND WEST. *CORNER FALLS ON TOP OF OLD CONCRETE CULVERT. DID NOT PLACE ANYTHING.*

(c) Was the corner restored through acceptance of (1) an obliterated evidence location, or, (2) a found perpetuated location?

No.

(d) Describe any material discrepancy between the location of the corner as restored or reestablished and the location of that corner as previously restored or reestablished by distance and direction. Show the discrepancy on the plan view drawing under (a), above.

THE ONLY KNOWN DISCREPANCY IS BETWEEN THE COMPUTED POSITION BY USING SUNNY'S PIPES THAT ARE IN SECTION 7.

(e) Was the corner reestablished through lost corner proportionate methods? If so, show the method, including the directions and distances to other public land survey corners used as evidence or used for proportioning in determining the corner location.

FOUND SUNNY'S PROPERTY CORNERS TO THE SOUTH. IN SUNNY'S 1933 SURVEY, HE SHOWS THE CENTER OF THE GRAVEL ROAD 13.9' EAST OF THE CORNER. IN THE 1952 SURVEY, HE STATES THAT HE SET A R.R. SPIKE BUT DOES NOT REFER TO HIS 1933 SURVEY OR THE WAY HE ESTABLISHED IT. THE DRAWING ALSO SHOWS THE CORNER AS IN THE CENTER OF THE ROAD. PROJECTING THE FOUND PIPES NORTH WILL LOCATE A POINT IN THE CENTER OF THE CENTER OF THE PAVEMENT. THIS WILL BE IN CONFLICT WITH HIS 1933 MAP AND THE DISTANCES TO THE EAST AND WEST. AS SUNNY STATED, THE CORNER WAS PROBABLY DESTROYED BY THE INSTALLATION OF THE CONCRETE BOX CULVERT. I DECLARED THE CORNER LOST AND PLACED IT ON LINE WITH THE SW AND SE CORNERS OF SECTION AT PROPORTIONATE DISTANCE WITH THE ORIGINAL FEDERAL GOVERNMENT DISTANCES.

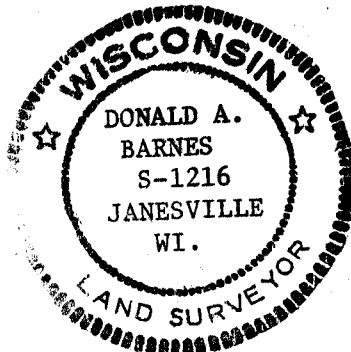
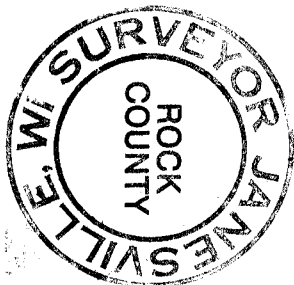

Donald Barnes
AUG 5 18, 1988.

NOTHING
DUG & FD

SW COR
SEC 6
1933 SUNNY 2513.71

S330.32
S0-29-18W

662.0 SUNNY 1952 662.0
662.29 672.42

SUNNY 1952
89-14-00
90-14-00

869
FD PIPE

2550.61
1933 SUNNY 2550.5
1893 BLEEDORN 2552.88
S1-56-51W 5186.16

S1/4 COR SEC 6

N1/4 COR SEC 6

1.84
FD 1/2 BOLT
.3 DEEP

8.44
FD 1/2" PIPE
0.3' DEEP

S1/4 COR
SEC 6
1893 BLEEDORN 2663.76
1933 SUNNY 2644.70
0216 2640

S89-16-03E 2646.01

X X X
DUG WITH CRUZ AIR
& FOUND NOTHING

1325

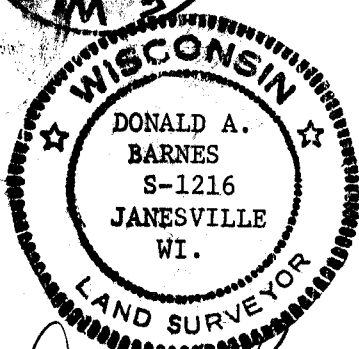
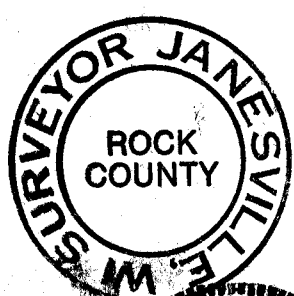

Donald Barnes
Aug 8, 1988

FD PIPE
REPLACED
WITH POLY

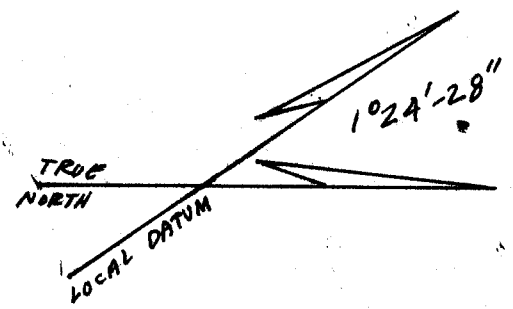

E 3