

PUBLIC LAND SURVEY MONUMENT RECORD

For Public Land Survey Corners in the

T. 4 N., R. 11 E.

CORNER CODE INDEX

	1	2	3	4	5	6	7	8	9	10	11	12	13	14	15	16	17	18	19	20	21	22	23	24	25
A																									
B																									
C	8																								
D																									
E																									
F																									
G	7	6	5	4	3	2																			
H																									
I																									
J																									
K																									
L	16	17	18	19	20	21	22	23	24																
M																									
N																									
O																									
P	9	20	21	22	23	24																			
Q																									
R																									
S																									
T	50	29	28	27	26	25																			
U																									
V																									
W																									
X	81	32	33	34	35	36																			
Y																									
Z																									

PLACE MONUMENT SYMBOL (●) AT PROPER LOCATION ON ABOVE INDEX

EXAMPLE

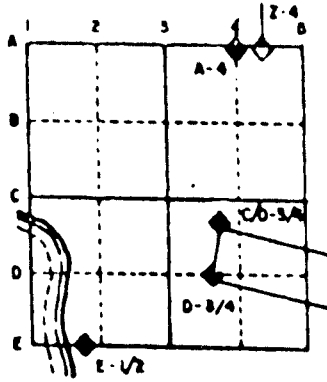

PORTER TWP
ROCK COUNTY WI

IF AVAILABLE
STATE PLANE COORDINATES

North (Y) _____ Eleve. (Z) _____
 East (X) _____ Zone _____
 Hor. Datum _____ Vert. Datum _____

◆ CORNER MONUMENT

○ WITNESS MONUMENT

BEARINGS ARE BASED ON:

(B) Describe any record evidence, monument evidence, occupational evidence, testimonial evidence or any other material evidence you considered, and whether the monument was found or placed.

1870 RUGER REMONUMENTATION NOTES. NORTH ON EAST LINE OF SE 1/4 SEC 36 ON A VAR 7-21 OFFSET WEST 8 LKS (5.28') AT 40.19 CHS (2652.54') INTERSECTED QUARTER LINE 1 LK (.66') WEST OF QUARTER COR. FOUND STAKE SURROUNDED BY HARD HEAD STONES SET BY LOCKE AT CORNER. ALSO FOUND REMAINS OF STUMPS OF BEARING TREES COR VAR 7-28. NORTH ON EAST LINE OF NE 1/4 SEC 36 ON A VAR 7-12 OFFSET EAST 13 LKS (8.58') AT 40.18 CH (2651.88') INTERSECTED NORTH BOUNDARY LINE 12 LKS EAST OF CORNER. COR VAR 7-11. (PLACED CUT LIMESTONE)

1874 RUGER VOL 2 PG 165 FOUND STONE MONUMENT AT E 1/4 CORNER OF SECTION 36 UNION TWP. SET STAKE SURROUNDED WITH 3 HH AT W 1/4 CORNER OF SECTION 31 PORTER TWP. STAKE IS 11.22' NORTH OF E 1/4 CORNER OF SECTION 36 UNION TWP. 2660.79 TO NW & 2660.79 TO SW COR OF SEC 31. W 1/4 COR IS 2599.41' TO CENTER OF SECTION 31 & 5253.27' TO E 1/4 CORNER OF SEC 31 PORTER TWP.

DUG VERY LARGE HOLE 3' DEEP WITH BACKHOE AND FOUND NOTHING. DUG BY HAND AT THE W 1/4 CORNER OF SEC 31 PORTER TWP AND FOUND 3 PIECES OF 1"X4" CUT LIMESTONE SCATTERED AROUND THE CENTER OF THE HOLE AS SHOWN IN THE DRAWING. FOUND LARGE WOOD POST 15" DEEP AND REMAINS OF OLD BARB WIRE. PLACED G-1 MONUMENT IN CENTER OF POST.

C) Was the corner restored through acceptance of (1) an obliterated evidence location, or, (2) a found perpetuated location?

ACCEPTED WOOD POST. SET G-1 MONUMENT IN MIDDLE OF POST. THE DIFFERENCES IN VARIANCE IN BEARINGS BETWEEN THE NE CORNER TO THE E 1/4 CORNER AND THE E 1/4 CORNER TO THE SE CORNERS OF SECTION 36 ARE:

LOCKE 0-15'
RUGER 0-17'
NEW BEARINGS 0-17

(E) Was the corner reestablished through lost corner proportionate methods? If so, show the method, including the directions and distances to other public land survey corners used as evidence or used for proportioning the corner location.

NO

I, Donald Barnes, hereby certify that the corner points as identified by the corner code index were, in a field survey on, SEP 8, 1994, established, re-established, monumented, re-monumented, recovered or restored as expressed below and in conformance with the regulations and rules as required in the current manual of survey instructions of the United States Department of Interior, Bureau of Land Management.

COUNTY SURVEYOR FILING DATA

Date of computer entry _____

Date microfilmed _____

Number of included sheets _____
CORNER CODE

seal

Donald Barnes
Sep 12, 1994

AFFIX YOUR LAND SURVEYOR SEAL

X-1

*Donald Barnes
Sep 12, 1994*

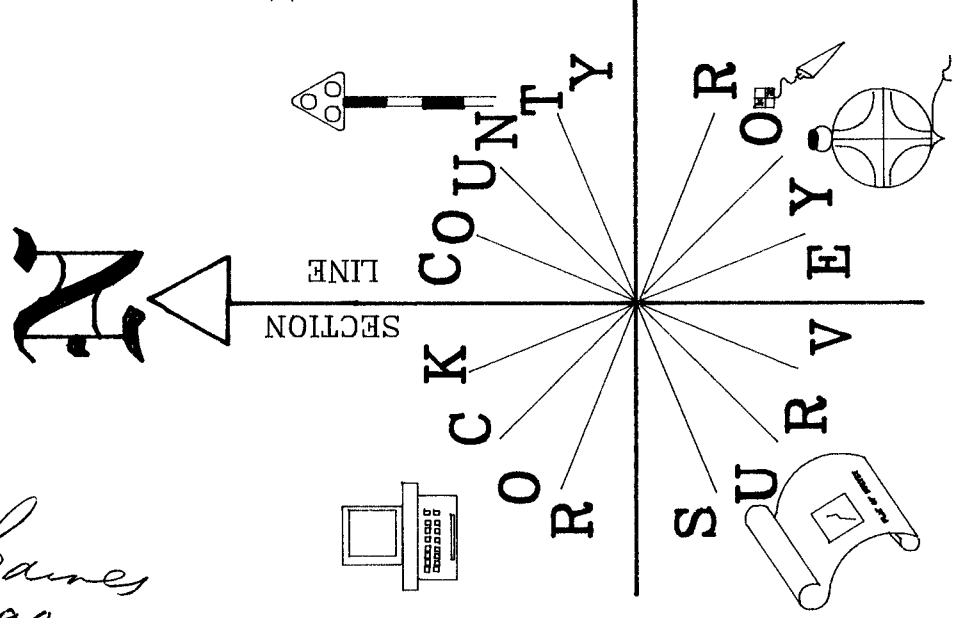



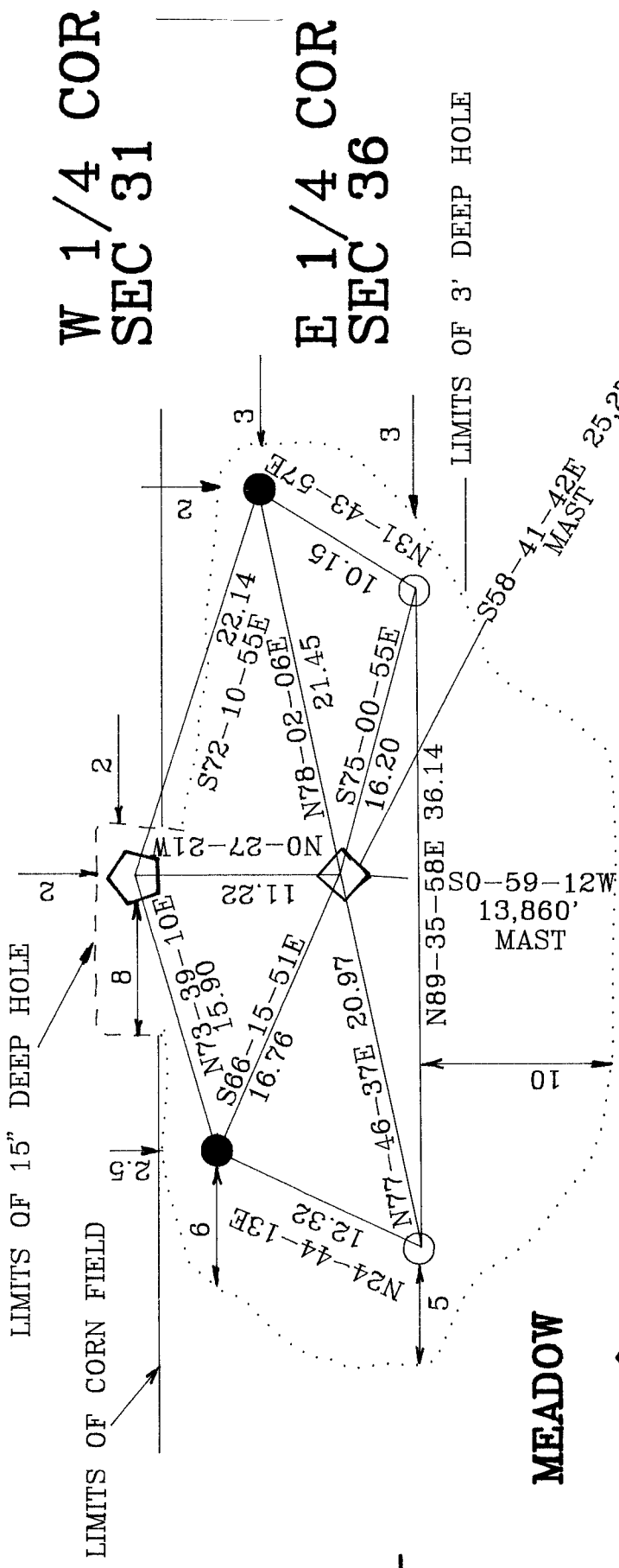



CORN FIELD



**W 1/4 COR
SEC 31**

**E 1/4 COR
SEC 36**

- 

 G-1 MON 15" DEEP IN WOOD POST
 W 1/4 COR SEC 31 PORTER TWP
- 

 ALUM. MON. 15" DEEP
 E 1/4 COR SEC 36 UNION TWP
- 
 3/4X24 REROD 20" DEEP
 WITH MAGNET
- 
 3/4X24 REROD 20" DEEP

X/