

# U.S. PUBLIC LAND SURVEY MONUMENT RECORD

For Public Land Survey Corners in the  
 T. 4 N., R. // E.  
 CORNER CODE INDEX

	1	2	3	4	5	6	7	8	9	10	11	12	13	14	15	16	17	18	19	20	21	22	23	24	25
A																									
B																									
C	6																								
D		5																							
E			4																						
F				3																					
G					2																				
H																									
I	7																								
J		8																							
K			9																						
L				10																					
M					11																				
N						12																			
O	18																								
P		17																							
Q			16																						
R				15																					
S					14																				
T						13																			
U							12																		
V								11																	
W									10																
X										9															
Y											8														
Z												7													

PLACE MONUMENT SYMBOL (◆) AT PROPER LOCATION ON ABOVE INDEX

EXAMPLE

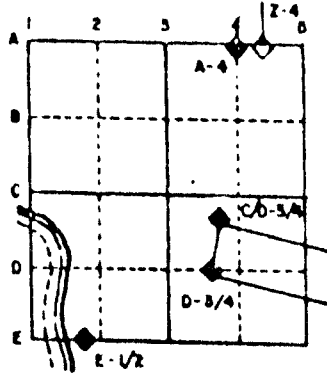

PORTER TWP  
 ROCK COUNTY WI

IF AVAILABLE  
 STATE PLANE COORDINATES

North (Y) \_\_\_\_\_ Eleve. (Z) \_\_\_\_\_  
 East (X) \_\_\_\_\_ Zone \_\_\_\_\_  
 Hor. Datum \_\_\_\_\_ Vert. Datum \_\_\_\_\_

◆ CORNER MONUMENT

○ WITNESS MONUMENT

○ PLACED 1"X24" IRON PIPE



FD 3/4"  
 PINCHED IRON PIPE

FD 3/4"  
 ROD

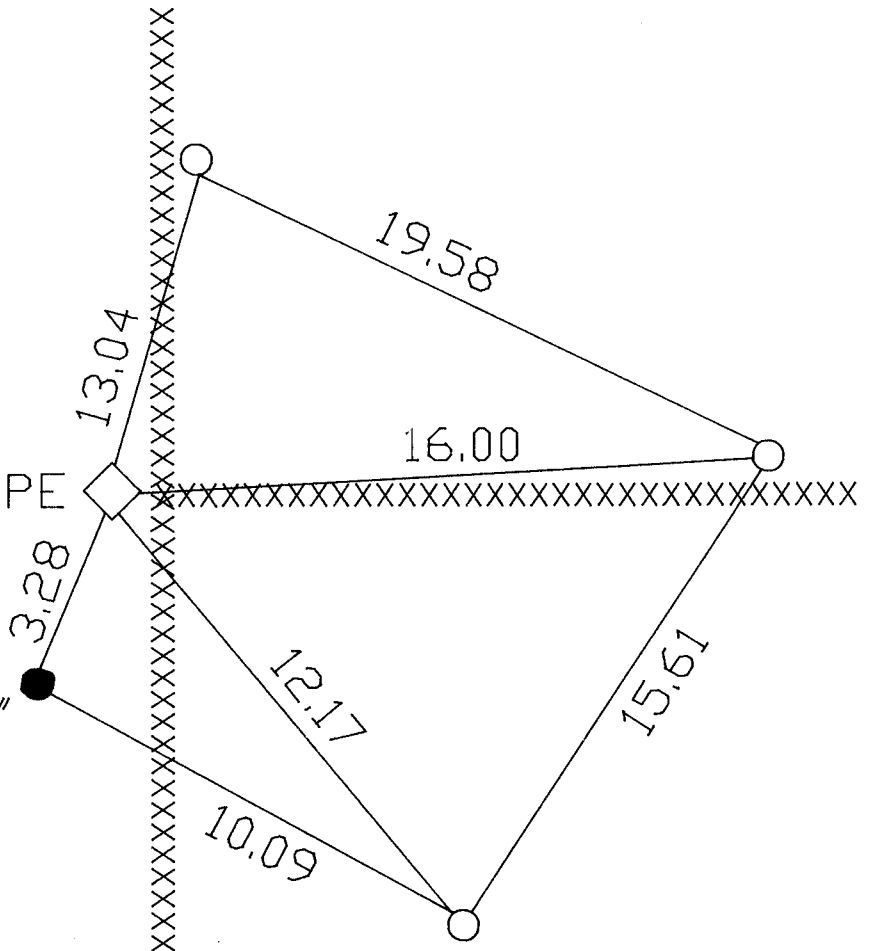

INFORMATION PROVIDED BY JIM WOODMAN

MICROFILMED

SHEET 1 OF 1

CORNER CODE: 417

(B) Describe any record evidence, monument evidence, occupational evidence, testimonial evidence or any other material evidence you considered, and whether the monument was found or placed.

1953 ELY PLAT OF SURVEY. LEGEND SHOWS "IRON STAKE DRIVEN". STATES NOTHING ELSE ABOUT THE CORNER.

1989 LEE. PLAT OF SURVEY. PLACED 3/4 X 48" IRON PIN. SHOWS THAT THE CORNER IS 2654.04 TO THE SE AND NE CORNERS OF SECTION 15. STATES THAT THE FENCE IS 3.0 NORTH AND 1.0 EAST OF THE MONUMENT.

FOUND PINCHED PIPE THAT ELY PLACED AND IRON PIN THAT LEE PLACED.

C) Was the corner restored through acceptance of (1) an obliterated evidence location, or, (2) a found perpetuated location?

ACCEPTED FOUND THE PINCHED PIPE. ACCEPTED THE PIPE RATHER THAN IRON PIN. I ACCEPTED THE PIPE BECAUSE IT WAS PLACED BEFORE THE PIN, THE PIN IS IN HARMONY WITH OCCUPATION AND THE DIFFERENCE BETWEEN THE POSITION THAT WAS DETERMINED FOR A LOST CORNER IS TOO TRIVIAL. I BELIEVE THE PIN BEST REPRESENTS THE POSITION BY OBLITERATED EVIDENCE LOCATION.

D) Describe any material discrepancy between the location of the corner as restored or reestablished and the location of that corner as previously restored or reestablished by distance and direction. Show the discrepancy on the plan view drawing under (a), above. Show the distances between the corner as previously restored or reestablished and (1) the corner as restored or reestablished, and (2) to at least 4 of the witness monuments shown on the drawing in (a), above.

DISCREPANCY IS SHOWN IN THE SKETCH. LEE DID NOT FILE A U.S. PUBLIC MONUMENT RECORD NOR ANY OTHER TIE SHEET.

(E) Was the corner reestablished through lost corner proportionate methods? If so, show the method, including the directions and distances to other public land survey corners used as evidence or used for proportioning the corner location.

I, Donald Barnes, hereby certify that the corner points as identified by the corner code index were, in a field survey on, March 10, 1991, established, re-established, monumented, re-monumented, recovered or restored as expressed below and in conformance with the regulations and rules as required in the current manual of survey instructions of the United States Department of Interior, Bureau of Land Management.

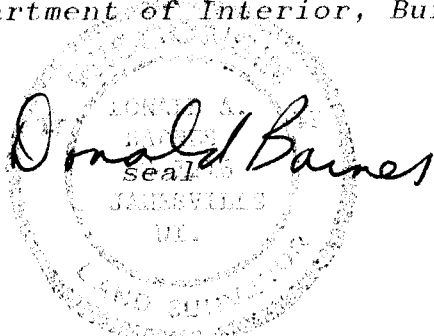

COUNTY SURVEYOR FILING DATA

Date of computer entry \_\_\_\_\_

Date microfilmed \_\_\_\_\_

Number of included sheets 0  
CORNER CODE

AFFIX YOUR LAND SURVEYOR SEAL

417