

PLAT AND RECORD

Of a Survey on Section 7 T 2 R 11 E. of the 4 P. M. in Wymouth Township

Rock County, Wisconsin, made April the 20th 1858
March 1857

I hereby certify that the following is a correct record of said survey as made by me.

COUNTY BUILDING
IN CITY OF BELOIT

(Signed) Joseph Church
RAB

County Surveyor.

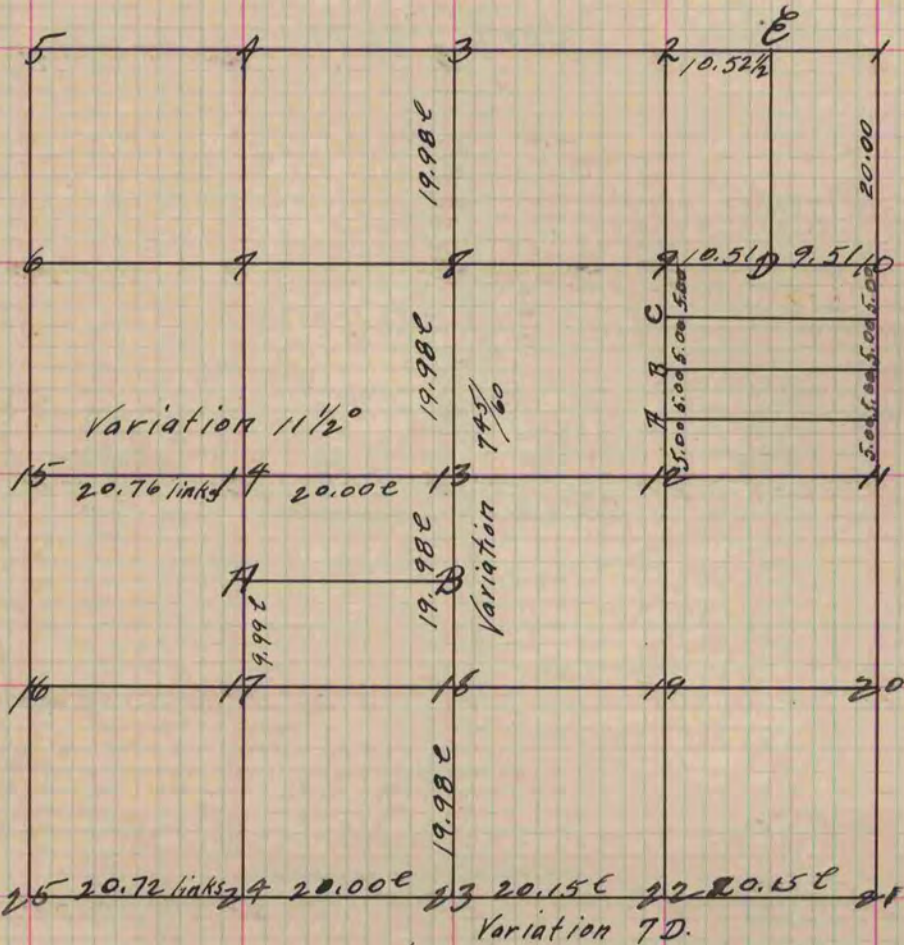

Fig. 18 Stake in Marsh no bearings.

- " 17 " " " "
- " 24 " " " "
- " 22 " " " "
- " 21 " " " "
- " 19 Bro. O. 14 N 72 W. 41
- " " 12 S 79 1/2 E. 90

Letter A Stake in the Marsh no bearings.

" B " " " " " "

Above Made March 18th 1857

Variation 7 D.

- Fig. 2 W. O. 40 N. 17 1/2 E. 117
- W. O. 20 S. 80 1/2 W. 180
- " 12 " " 30 N. 65 W. 51
- 36 N 29
- A. W. O. 30 N. 41 W. 21
- B. W. O. 18 S. 69 W. 35
- C. W. O. 16 N. 20 W. 43
- Fig. 9 W. O. 30 S. 6 1/2 E. 113 1/2
- 10 " " 20 S. 61 W. 27 1/2
- E. B. I. O. 10 S. 18 1/2 E. 29
- 10 S. 25 1/2 W. 39

Made 20th day of April 1858
Joseph Church

Copied from Page 67 Vol. 1 Original County Surveyors Record.