

U.S. PUBLIC LAND SURVEY MONUMENT RECORD

For Public Land Survey Corners in the
 T. 4 N., R. 13 E.

CORNER CODE INDEX

	1	2	3	4	5	6	7	8	9	10	11	12	13	14	15	16	17	18	19	20	21	22	23	24	25
A																									
B																									
C	6																								
D		5																							
E			4																						
F				3																					
G					2																				
H																									
I																									
J	7																								
K		8																							
L			9																						
M				10																					
N					11																				
O						12																			
P	18																								
Q		17																							
R			16																						
S				15																					
T					14																				
U						13																			
V							12																		
W								11																	
X									10																
Y										9															
Z											8														
												7													
													6												
														5											
															4										
																3									
																	2								
																		1							

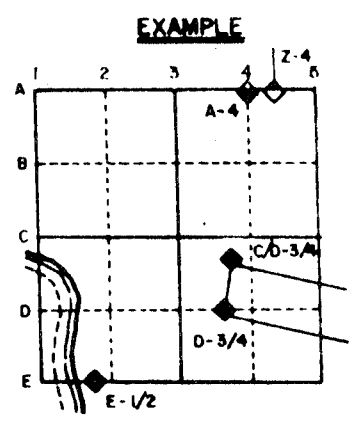

MILTON TWP
 ROCK COUNTY WI

IF AVAILABLE
 STATE PLANE COORDINATES

North (Y) _____ Eleve. (Z) _____
 East (X) _____ Zone _____
 Hor. Datum _____ Vert. Datum _____

PLACE MONUMENT SYMBOL (◆) AT PROPER LOCATION ON ABOVE INDEX

(a) ◆ CORNER MONUMENT ○ WITNESS MONUMENT

Poly monument is 4 EAST OF
 PUMT TO THE SOUTH, 1.5' SOUTH
 OF SOUTH EDGE

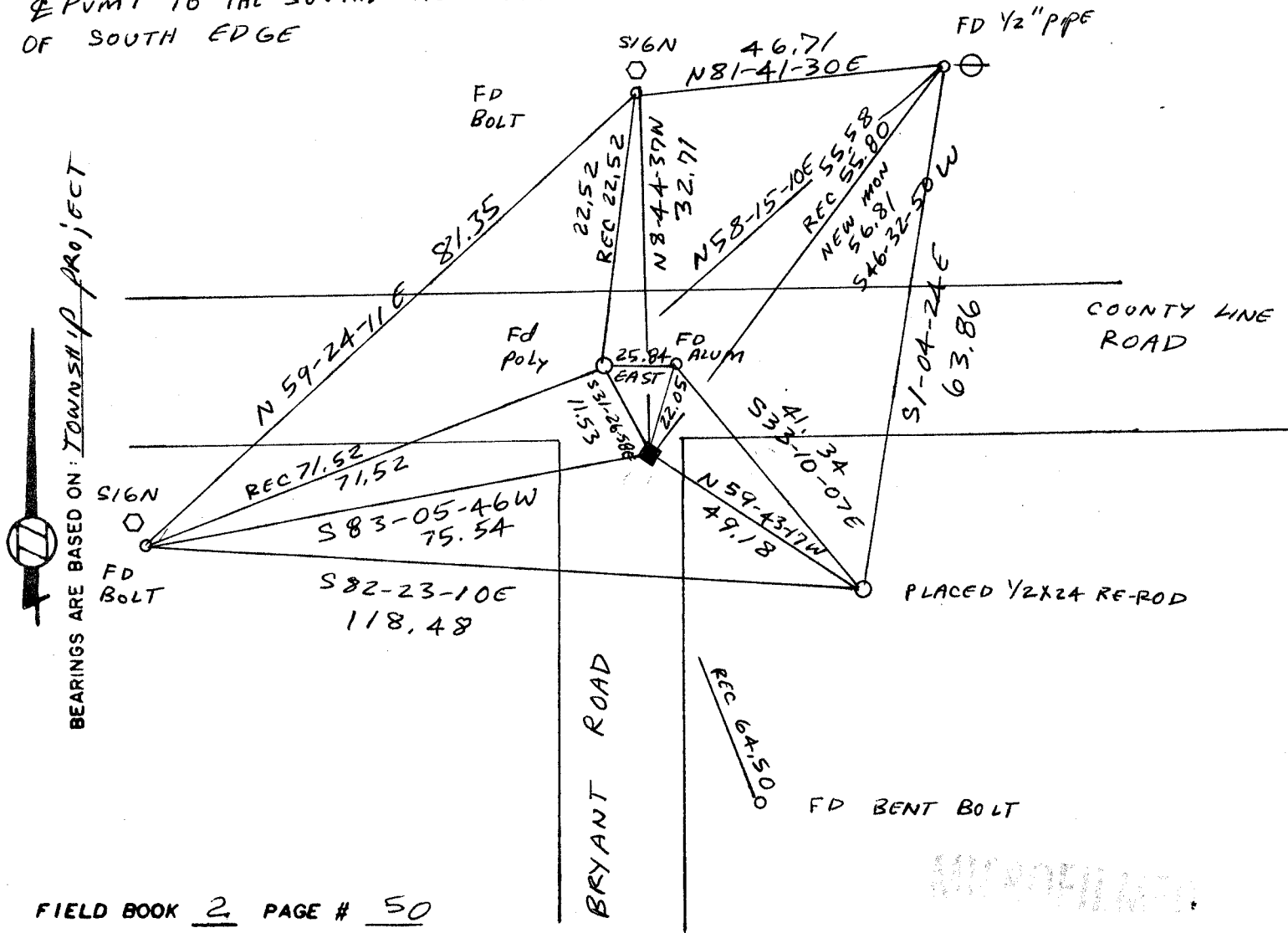

FIELD BOOK 2 PAGE # 50

SHOW A PLAN VIEW DRAWING DEPICTING THE CORNER MONUMENT AND SURROUNDING PHYSICAL FEATURES, INCLUDING THE EXCAVATION AREA AND DEPTH. THE CORNER MONUMENT SHALL HAVE THE FOLLOWING CHARACTERISTICS: 1) HAVE AT LEAST TWO PREDETERMINED BREAK-OFF POINTS. 2) IF BROKEN, LEAVE A PERMANENTLY MAGNETIZED REMNANT AT THE ORIGINAL POINT. 3) MUST BE EXTENDABLE. 4) THE CAP IS INSCRIBED: ROCK COUNTY SURVEY MONUMENT - PENALTY FOR DISTURBING MARKER. 5) OR AN EXISTING CUT LIMESTONE. AN IRON PIPE 1 1/2" x 4'0" (MINIMUM) MAY BE USED IN AREAS WHERE GROUND WATER IS WITHIN ONE FOOT OF THE SURFACE. IF THE CORNER IS OCCUPIED BY AN IMPROVEMENT (MANHOLE, BURIED CABLE, ETC.) ANY DURABLE, DISTINCT MONUMENT MAY BE USED. CORNERS SHALL BE REFERENCED WITH AT LEAST 4 DURABLE WITNESS MONUMENTS. WITNESS MONUMENTS SHALL BE MADE OF CONCRETE, NATURAL STONE, IRON OR OTHER EQUALLY DURABLE MATERIAL, EXCEPT WOOD. DESCRIBE THE CORNER AND THE WITNESS MONUMENTS.

CORNER CODE: A23(1)

(b.) Describe any record evidence, monument evidence, occupational evidence, testimonial evidence or any other material evidence you considered, and whether the monument was found or placed.

SEE SHEET 2 & 3

(c.) Was the corner restored through acceptance of (1) an obliterated evidence location, or, (2) a found perpetuated location?

see sheet 2 & 3

(d.) Describe any material discrepancy between the location of the corner as restored or reestablished and the location of that corner as previously restored or reestablished by distance and direction. Show the discrepancy on the plan view drawing under (d), above. Show the distances between the corner as previously restored or reestablished and (1) the corner as restored or reestablished, and (2) to at least 4 of the witness monuments shown on the drawing in (d), above.

SEE SHEET 2 & 3

(e.) Was the corner reestablished through lost corner proportionate methods? If so, show the method, including the directions and distances to other public land survey corners used as evidence or used for proportioning in determining the corner location.

see sheet 2 & 3

I, Donald Barnes, hereby certify that the corner points as identified by the corner code index were, in a field survey on July 15 1988, established, re-established, monumented, re-monumented, recovered or restored as expressed below and in conformance with the regulations and rules as required in the current manual of survey instructions of the United States Department of Interior, Bureau of Land Management.

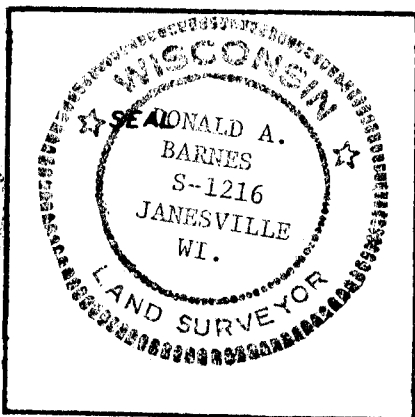
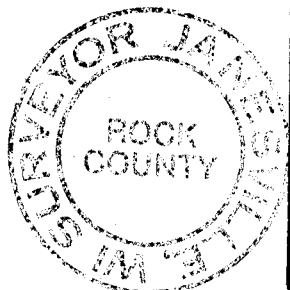

COUNTY SURVEYOR FILING DATA

Date of Computer Entry _____

Date Received _____

Date Microfilmed _____

Treasurer's Receipt No. _____

Number of Included Sheets 2

AFFIX YOUR LAND SURVEYOR SEAL. CORNER CODE A 23(1)

U.S. PUBLIC LAND SURVEY MONUMENT RECORD

For Public Land Survey Corners in the

T. 4 N., R. 13 E.

CORNER CODE INDEX

1	2	3	4	5	6	7	8	9	10	11	12	13	14	15	16	17	18	19	20	21	22	23	24	25
A																								
B	6																							
C		5																						
D			4																					
E				3																				
F					2																			
G	7																							
H		8																						
I			9																					
J				10																				
K					11																			
L	12																							
M		13																						
N			14																					
O				15																				
P					16																			
Q						17																		
R							18																	
S								19																
T									20															
U										21														
V											22													
W												23												
X													24											
Y																								
Z																								

PLACE MONUMENT SYMBOL (◆) AT PROPER LOCATION ON ABOVE INDEX

EXAMPLE

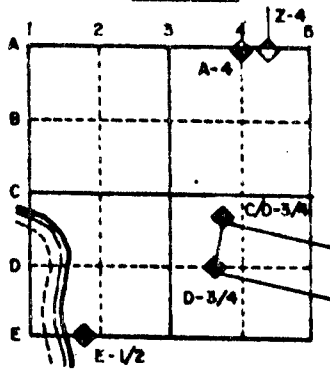

MILTON TWP
ROCK COUNTY WI

IF AVAILABLE STATE PLANE COORDINATES

North (Y) _____ Eleve. (Z) _____
 East (X) _____ Zone _____
 Hor. Datum _____ Vert. Datum _____

a.)

◆ CORNER MONUMENT

○ WITNESS MONUMENT

BEARINGS ARE BASED ON: Township projected

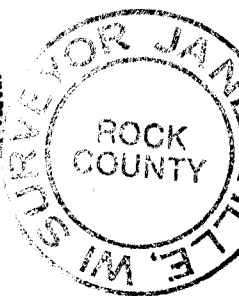
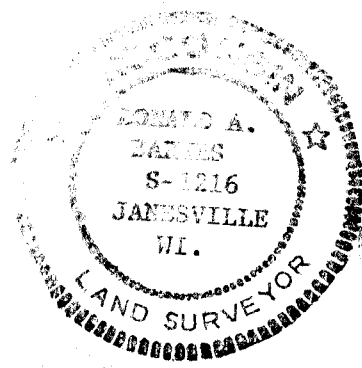
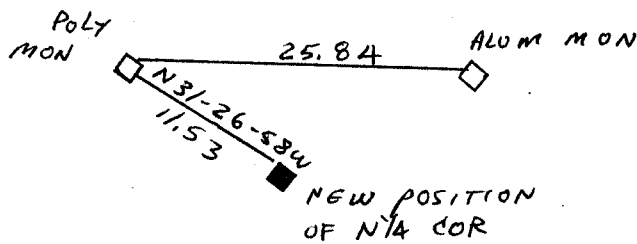

- 1871 RUGER'S REMONUMENTATION FIELD NOTES. NORTH 1/4 CORNER OF SECTION 1 ON THE TOWN LINE AND EQUIDISTANCE FROM THE NE AND NW CORNERS OF SAID SECTION. IT BEING 2655.35 DISTANCE FROM EACH AND 26.73 WEST OF THE SOUTH 1/4 CORNER OF SECTION 36 T5NR13E. AT SOUTH 1/4 CORNER OF SECTION 36 T5NR13E FOUND DECAYED STUMPS OF BOTH B.T.s. LINEN SHOWS THE SAME VARIANCE FOR ENTIRE NORTH LINE OF SECTION.
- 1921 ELY VOL 3 PG 112. PLACED CORNER MID WAY BETWEEN THE NW AND NE CORNERS OF SECTION 1. SHOWS A JOG OF 25.9. ALSO PLACED MONUMENTS AT THE CENTER OF THE SECTION AND THE PROPERTY CORNER OF THE SOUTH 80 ACRES OF THE NE 1/4 WHICH IS BETWEEN THE CENTER AND THE NORTH QUARTER CORNER.
- 1957 BATTERMAN VOL 3 PG 513. FOUND ELY'S MONUMENTS AT THE CENTER OF SECTION AND THE PROPERTY CORNER.
- 1969 BATTERMAN JR. VOL 4 PG 424. PLACED PIPES AND REFERENCED THE CENTER AND THE PROPERTY CORNER.
- 1972 SCHROEDER - JEFFERSON COUNTY SURVEYOR'S RECORDS. FIELD NOTES STATE THAT HE DUG AND FOUND NOTHING. NOTES STATE THAT HE ESTABLISHED THE SOUTH QUARTER OF SECTION 36 T5NR13E BY RETRACING THE DISTANCES FROM SOUTH AND EAST WHICH WERE PREVIOUSLY DONE BY ROCK COUNTY SURVEYOR IN 1921. FIELD NOTES SHOWS A DISTANCE OF 2667.7 TO THE NE CORNER AND 3176.3 TO THE CENTER OF THE SECTION. FIELD NOTES ALSO SHOWED A DIAGRAM WITH REFERENCE PIPES.
- 1977 WOLLEN WROTE ON SCHROEDER'S FIELD NOTES THAT HE SET 1" X 24" PIPES AT BOTH CORNERS. NOTES ALSO SHOWS THAT HE ASSISTED SCHROEDER IN 1972.
- 1983 BARNES U.S. PUBLIC LAND SURVEY MONUMENT RECORD. FOUND 1" X 24" IRON PIPE. ^{THERE} REPLACED WITH POLY MONUMENT. THE TERRAIN INDICATES THAT WAS DEEP CUTS FOR THE ROAD. THE CUT LIMESTONE THAT RUGER PLACED WAS PROBABLE DESTROYED.

(C) Was the corner restored through acceptance of (1) an obliterated evidence location, or, (2) found perpetuated location?

NO

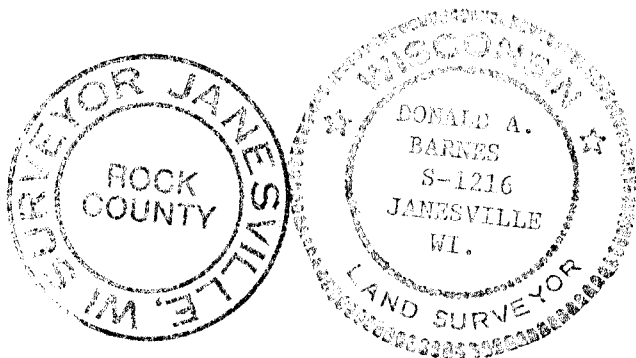

U.S. PUBLIC LAND SURVEY MONUMENT RECORD

For Public Land Survey Corners in the

T. 4 N., R. 13 E.

CORNER CODE INDEX

	1	2	3	4	5	6	7	8	9	10	11	12	13	14	15	16	17	18	19	20	21	22	23	24	25
A																									
B																									
C	6	5	4	3	2																				
D																									
E																									
F																									
G	7	8	9	10	11	12																			
H																									
I																									
J																									
K																									
L	13	14	15	16	17	18	19	20	21	22	23	24	25												
M																									
N																									
O																									
P	19	20	21	22	23	24																			
Q																									
R																									
S																									
T	30	29	28	27	26	25																			
U																									
V																									
W																									
X	31	32	33	34	35	36																			
Y																									
Z																									

PLACE MONUMENT SYMBOL (◆) AT PROPER LOCATION ON ABOVE INDEX

EXAMPLE

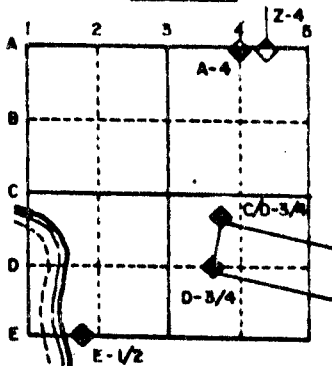

MILTON TWP
ROCK COUNTY WI

IF AVAILABLE
STATE PLANE COORDINATES

North (Y) _____ Eleve. (Z) _____
 East (X) _____ Zone _____
 Hor. Datum _____ Vert. Datum _____

o.)

◆ CORNER MONUMENT

○ WITNESS MONUMENT

S89-17-46E 2660.68
 ELY 2667.70
 RUGER 2655.35

SCHROEDER 2667.70
 S89-17-46E 2660.68
 ELY 2667.70
 RUGER 2655.35

BEARINGS ARE BASED ON: Township projected
 NW COR
 W 1/4 COR

ELY 2644.80
 N89-57-41E 2645.84

0.19
 PROPERTY CORNER

HLC 1308.65
 ELY 1309.41
 SCHROEDER 3176.3
 TO NEW POSITION 3166.45
 TO FOUND PIPE 3176.19

CENTER N89-58-52E 2655.77
 ELY 2660.10
 THOM 2655.84

ELY 2647.50
 2645.60

S 1/4
 COR

NE COR

E 1/4 COR

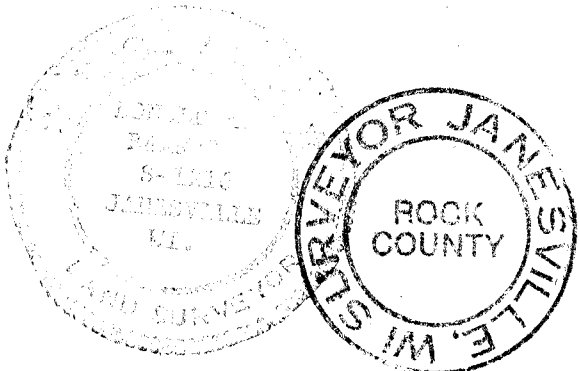

MICROFILMED

SHEET 3 OF 3

CORNER CODE: A 23 (1)

(d) Describe any material discrepancy between the location of the corner as restored or reestablished and the location of that corner as previously restored or reestablished by distance and direction. Show the discrepancy on the plan view drawing under (c), above. Show the distances between the corner as previously restored or reestablished and (1) the corner as restored or reestablished, and (2) to at least 4 of the witness monuments shown on the drawing in (a), above.

AFTER REVIEWING THE FIELD NOTES FROM JEFFERSON COUNTY, I PLACED THE CORNER MIDWAY AND ON LINE BETWEEN THE NE AND NW CORNERS OF SECTION 1. THIS WAS THE METHOD THAT RUGER USED. ELY'S NOTES SHOW THAT HE PLACED IT MIDWAY. USING THE CORNER THAT SCHROEDER ESTABLISHED PLACES THE PIPE AT THE CENTER 6.18' WEST OF THE N/S QUARTER LINE. THE NEW POSITION PLACES THE PIPE 1.52 EAST OF THE N/S QUARTER LINE. THE PROPERTY CORNER IS .19' EAST OF THE NEW N/S QUARTER LINE. THE JEFFERSON COUNTY FIELD NOTES SHOWS THAT SCHROEDER USED ELY'S DISTANCES FROM THE CENTER OF THE SECTION AND THE NE CORNER OF THE SECTION TO ESTABLISH THE NORTH QUARTER CORNER. THIS IS CONFIRMED BY MY MEASUREMENTS. THIS PROCEDURE DOES NOT USE PRORATION WHICH WOULD DISTRIBUTE ELY'S MEASUREMENT ERRORS ALONG THE NORTH LINE OF THE SECTION. DOING SO CAUSES THE PROPERTY CORNER, NORTH QUARTER CORNER, CENTER, AND SOUTH QUARTER CORNERS TO BE CLOSER TO A STRAIGHT LINE WHICH WAS ELY'S INTENT. **SCHROEDER AND WOLLEN WERE NOTIFIED.**

(E) Was the corner reestablished through lost corner proportionate methods? If so, show the method, including the directions and distances to other public land survey corners used as evidence or used for proportioning in determining the corner location.

YES. SEE OTHER SIDE

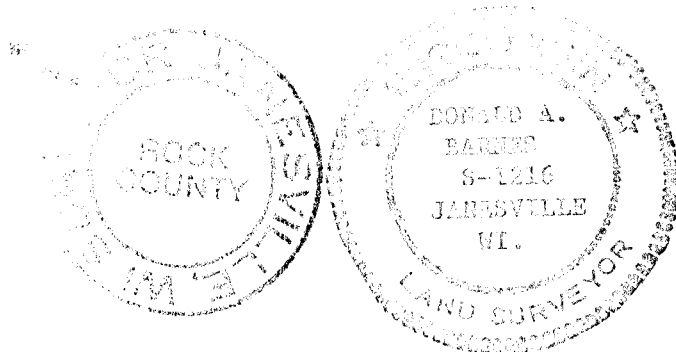

SHEET 3 OF 3

A 23(1)