

PLAT AND RECORD

Of a Survey on Section 35 T 2 R 14 E. of the 4 P. M. in Bradford Township
 Rock County, Wisconsin, made October the 3rd & 4th 1859

I hereby certify that the following is a correct record of said survey as made by me.

COUNTY BUILDING
 IN CITY OF BELOIT

(Signed) Edward Ruger
 R.M.S.

County Surveyor.

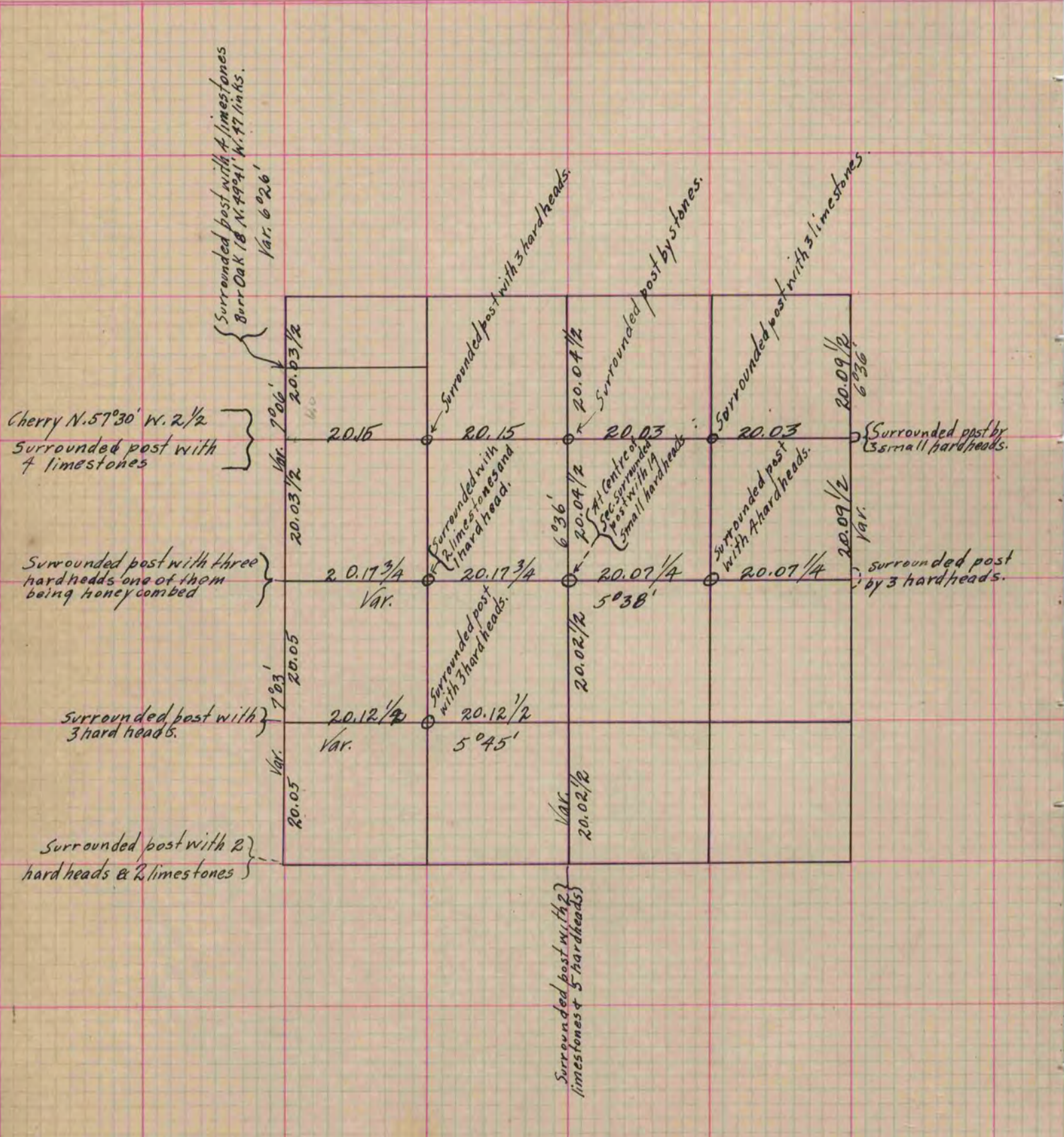

Copied from Page 121 Vol. One Original County Surveyor's Record.