

# PLAT AND RECORD

Of a Survey on Section 19 T 4N. R 11 E. of the 4 P. M. in PORTER Township

Rock County, Wisconsin, made SEPTEMBER the 9th 1971

I hereby certify that the following is a correct record of said survey as made by me.

COUNTY BUILDING  
IN CITY OF BELOIT

County Surveyor.

BK. 152 A, Pp. 55-56

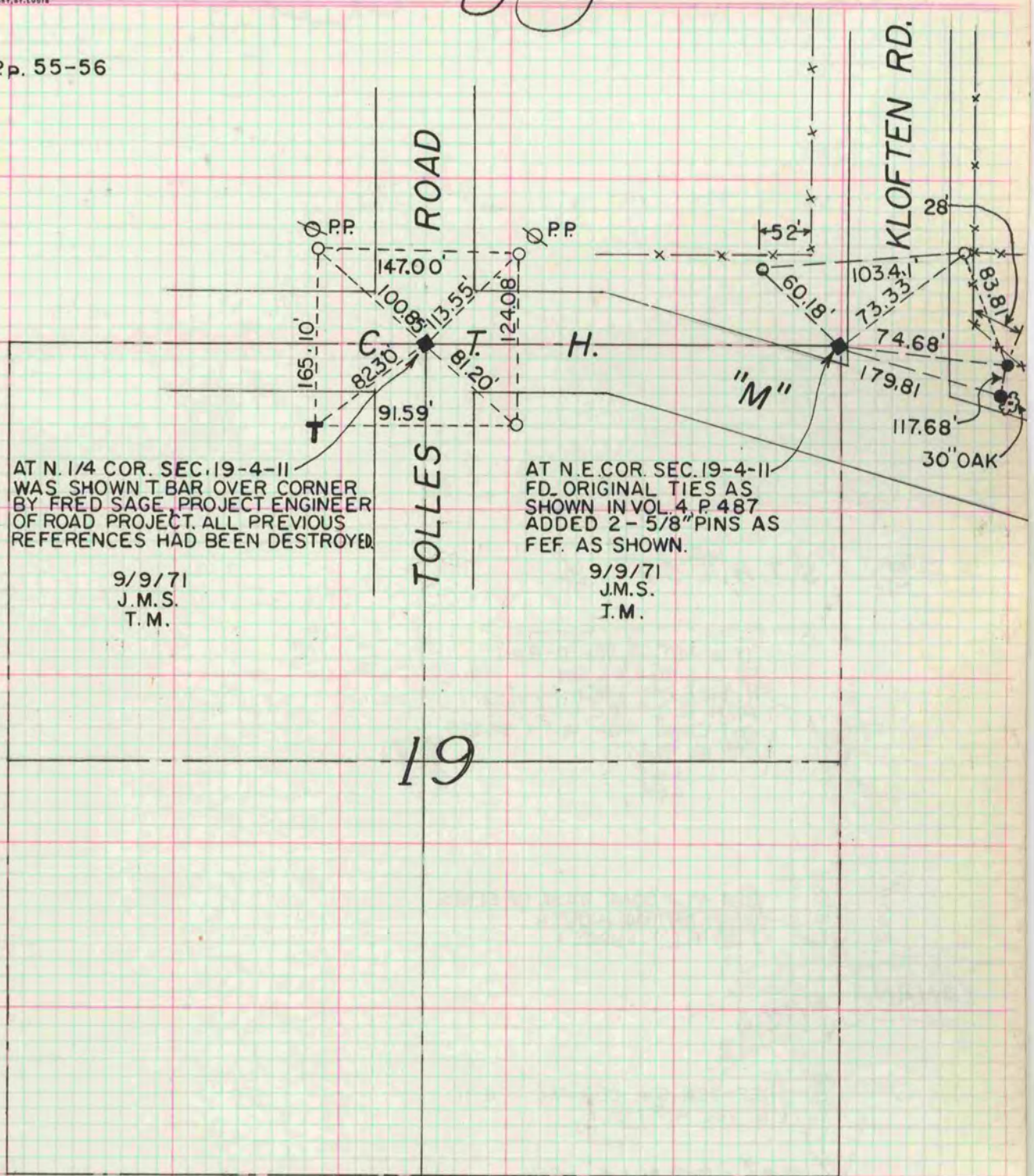

AT N. 1/4 COR. SEC. 19-4-11  
WAS SHOWN T BAR OVER CORNER  
BY FRED SAGE, PROJECT ENGINEER  
OF ROAD PROJECT. ALL PREVIOUS  
REFERENCES HAD BEEN DESTROYED.

9/9/71  
J.M.S.  
T.M.

AT N.E. COR. SEC. 19-4-11  
FD. ORIGINAL TIES AS  
SHOWN IN VOL. 4, P. 487  
ADDED 2 - 5/8" PINS AS  
FEF. AS SHOWN.

9/9/71  
J.M.S.  
I.M.

19

**MONUMENT KEY**  
T = T BAR IRON STAKE  
● = 5/8" IRON PIN  
○ = 1" IRON PIPE