

U.S. PUBLIC LAND SURVEY MONUMENT RECORD

For Public Land Survey Corners in the

T. 4 N., R. 12 E.

CORNER CODE INDEX

	2	3	4	5	6	7	8	9	10	11	12	13	14	15	16	17	18	19	20	21	22	23	24	25
A																								
B																								
C	6																							
D		5																						
E			4																					
F				3																				
G					2																			
H																								
I																								
J	7																							
K		8																						
L			9																					
M				10																				
N					11																			
O						12																		
P	18						15																	
Q		17						14																
R			16						13															
S				15																				
T					16																			
U						17																		
V							18																	
W								19																
X									20															
Y										21														
Z											22													
												23												
													24											
														25										
															26									
																27								
																	28							
																		29						
																			30					
																				31				
																					32			
																						33		
																							34	
																								35
																								36

PLACE MONUMENT SYMBOL (◆) AT PROPER LOCATION ON ABOVE INDEX

EXAMPLE

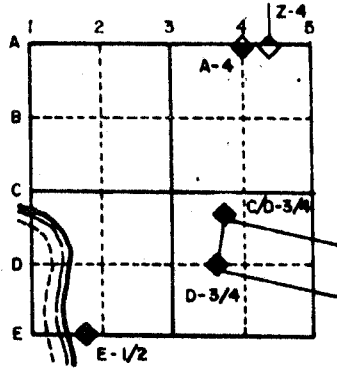

FULTON TWP
ROCK COUNTY WI

IF AVAILABLE
STATE PLANE COORDINATES

North (Y) 310432.18 Eleve. (Z) _____
 East (X) 2,261,936.21 Zone _____
 Hor. Datum _____ Vert. Datum _____

RE ROD 310,449.83 ; 2,261,932.52

(a) ◆ CORNER MONUMENT ○ WITNESS MONUMENT 1 7/8 x 24 PIPE
 FOUND 3 LARGE HARDHEADS IN TIGHT CLUSTER SET POLY MONUMENT & CARSONITE POST

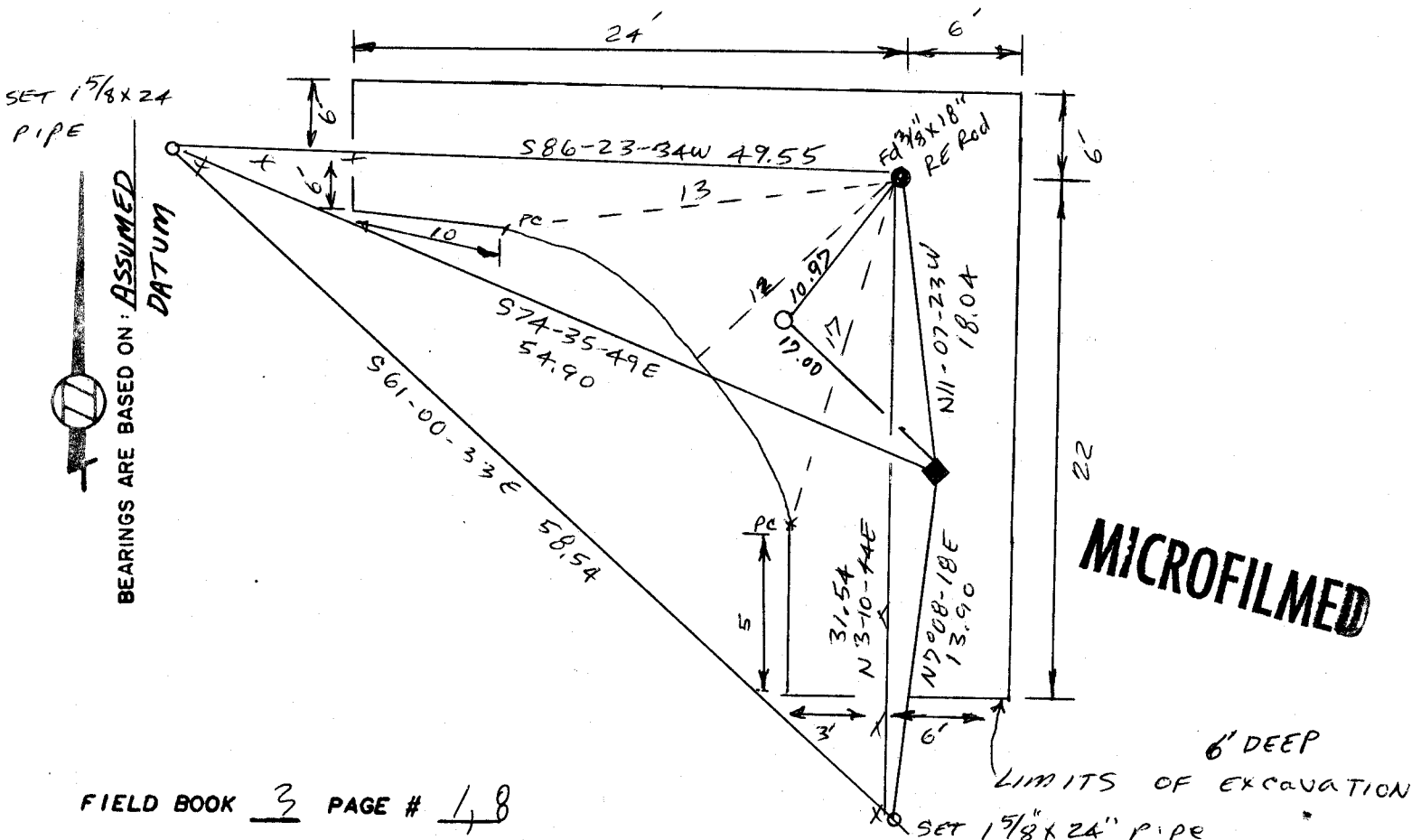

FIELD BOOK 3 PAGE # 18

SHOW A PLAN VIEW DRAWING DEPICTING THE CORNER MONUMENT AND SURROUNDING PHYSICAL FEATURES, INCLUDING THE EXCAVATION AREA AND DEPTH. THE CORNER MONUMENT SHALL HAVE THE FOLLOWING CHARACTERISTICS: 1) HAVE AT LEAST TWO PREDETERMINED BREAK-OFF POINTS. 2) IF BROKEN, LEAVE A PERMANENTLY MAGNETIZED REMNANT AT THE ORIGINAL POINT. 3) MUST BE EXTENDABLE. 4) THE CAP IS INSCRIBED: ROCK COUNTY SURVEY MONUMENT - PENALTY FOR DISTURBING MARKER. 5) OR AN EXISTING CUT LIMESTONE. AN IRON PIPE 1 1/2" x 4" (MINIMUM) MAY BE USED IN AREAS WHERE GROUND WATER IS WITHIN ONE FOOT OF THE SURFACE. IF THE CORNER IS OCCUPIED BY AN IMPROVEMENT (MANHOLE, BURIED CABLE, ETC.) ANY DURABLE, DISTINCT MONUMENT MAY BE USED. CORNERS SHALL BE REFERENCED WITH AT LEAST 4 DURABLE WITNESS MONUMENTS. WITNESS MONUMENTS SHALL BE MADE OF CONCRETE, NATURAL STONE, IRON OR OTHER EQUALLY DURABLE MATERIAL, EXCEPT WOOD. DESCRIBE THE CORNER AND THE WITNESS MONUMENTS.

CORNER CODE:

A-23

(b.) Describe any record evidence, monument evidence, occupational evidence, testimonial evidence or any other material evidence you considered, and whether the monument was found or placed.

1) IN 1880 R.K. LEE ESTABLISHED THE NORTH QUARTER CORNER MIDWAY BETWEEN THE NE & NW CORNERS OF SECTION 2. HE FOUND THE S1/4 CORNER OF SECTION 36 T5NR12E WHICH WAS WEST 0.04'. HE STATED THERE WAS A SMALL 4" BLACK OAK TREE AT THE N 1/4 CORNER OF SEC 1.

2) IN 1912 HINTZE DECLARED THE S1/4 CORNER OF SEC 36 LOST AND SET A CONCRETE MONUMENT ON LINE WITH THE SW & SE CORNERS OF SEC 36 AT MID POINT. HIS TOWNSHIP PLAT SHOWS A JOG OF 8.3'. IT APPEARS FROM HIS FIELD NOTES AND THE OTHER JOGS ALONG THE COUNTY LINE THAT THIS WAS A COMPUTATION AND HE DID NOT FIND THE N 1/4 CORNER OF SECTION 1.

3) I FOUND A 3/8"X18" REROD AT THE FENCE INTERSECTION & 3 LARGE HARDHEAD STONES IN A TIGHT CLUSTER AT ABOUT 18' SOUTH OF THE REROD.

4) THE DANE COUNTY SURVEYOR, RON RIPP, DID NOT FIND ANY DOCUMENTATION FOR THE REROD OR STONES.

(c.) Was the corner restored through acceptance of (1) an obliterated evidence location, or, (2) a found perpetuated location?

I ACCEPTED THE HARD HEAD STONES BECAUSE THEY WERE IN HARMONY WITH LEE'S SURVEY AND THE MONUMENTS TO THE SOUTH AND THE FENCE INTERSECTION TO THE EAST.

SEE COUNTY SURVEYOR'S RECORDS VOL 6 PAGE 341 FOR SKETCH OF SECTION.

(d.) Describe any material discrepancy between the location of the corner as restored or reestablished and the location of that corner as previously restored or reestablished by distance and direction. Show the discrepancy on the plan view drawing under (a), above. Show the distances between the corner as previously restored or reestablished and (1) the corner as restored or reestablished, and (2) to at least 4 of the witness monuments shown on the drawing in (a), above.

(e.) Was the corner reestablished through lost corner proportionate methods? If so, show the method, including the directions and distances to other public land survey corners used as evidence or used for proportioning in determining the corner location.

I, Donald Evans, hereby certify that the corner points as identified by the corner code index were, in a field survey on APRIL 24 1985, established, re-established, monumented, re-monumented, recovered or restored as expressed below and in conformance with the regulations and rules as required in the current manual of survey instructions of the United States Department of Interior, Bureau of Land Management.

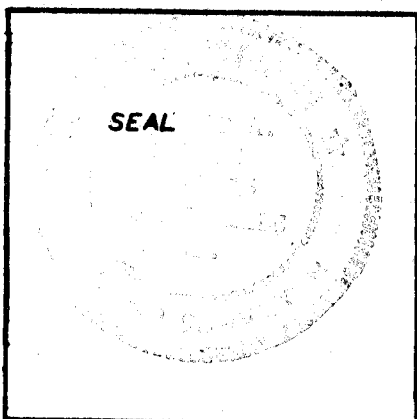

COUNTY SURVEYOR FILING DATA

Date of Computer Entry _____

Date Received _____

Date Microfilmed AUG 30, 1985

Treasurer's Receipt No. _____

Number of Included Sheets _____

AFFIX YOUR LAND SURVEYOR SEAL. CORNER CODE A 23