

U.S. PUBLIC LAND SURVEY MONUMENT RECORD

For Public Land Survey Corners in the
 T. 2 N., R. 11 E.

CORNER CODE INDEX

	1	2	3	4	5	6	7	8	9	10	11	12	13	14	15	16	17	18	19	20	21	22	23	24	25
A																									
B																									
C	6				5	◆			4					3					2						
D																									
E																									
F																									
G	7				8				9					10					11						12
H																									
I																									
J																									
K																									
L	13				17				16					15					14						13
M																									
N																									
O																									
P	19				20				21					22					23						24
Q																									
R																									
S																									
T	30				29				28					27					26						25
U																									
V																									
W																									
X																									
Y																									
Z																									

PLACE MONUMENT SYMBOL (◆) AT PROPER LOCATION ON ABOVE INDEX

EXAMPLE

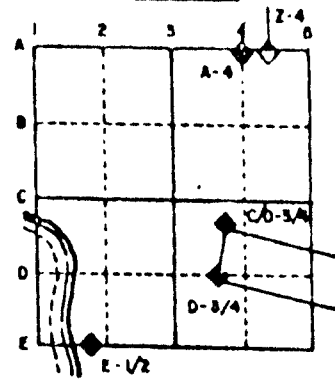

PLYMOUTH TWP
ROCK COUNTY WI

IF AVAILABLE
 STATE PLANE COORDINATES

North (Y) _____ Elev. (Z) _____
 East (X) _____ Zone _____
 Hor. Datum _____ Vert. Datum _____

◆ CORNER MONUMENT

○ WITNESS MONUMENT

BEARINGS ARE BASED ON:

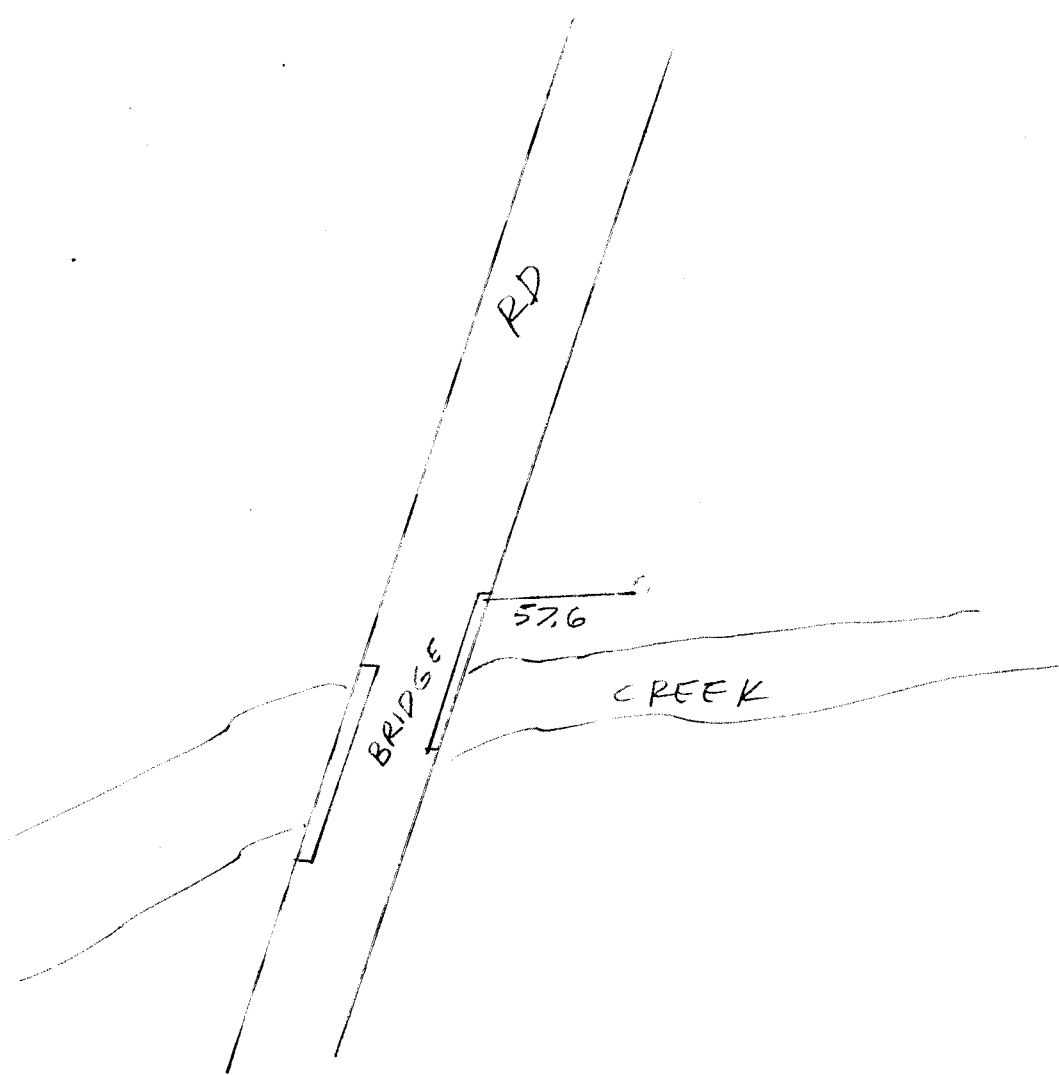

FB 3 PG 32

MICROFILMED

C

SHEET ___ OF ___

CORNER CODE: C8

(B) Describe any record evidence, monument evidence, occupational evidence, testimonial evidence or any other material evidence you considered, and whether the monument was found or placed.

1867 LOCKE VOL 1 PG 280 ESTABLISHED 1/16TH CORNER. DID NOT STATE THE TYPE OF MONUMENT PLACED. CALLS FOR 1332.21 TO THE E 1/4 CORNER AND CENTER OF SECTION 5.

1966 BATTERMAN JR. VOL 4 PG 255. CALLS FOR A MONUMENT AND THE FOLLOWING:

- 1334.35 TO THE CENTER OF SECTION 5
- 1334.35 TO THE E 1/4 CORNER OF SECTION 5
- 82-19 ANGLE AT THE CENTER FROM THE N 1/4 CORNER TO THE E 1/4 CORNERS OF SECTION 5
- 88-13-45 ANGLE AT THE E 1/4 CORNER OF SECTION 5 FROM THE CENTER TO THE NE CORNERS OF SECTION 5

FOUND BENT 2" PIPE. REPLACED WITH 3/4X24 REROD. 1334.53 TO E 1/4 CORNER OF SECTION 5.

C) Was the corner restored through acceptance of (1) an obliterated evidence location, or, (2) a found perpetuated location?

PERPETUATED FOUND PIPE. DID NOT ACCEPT NOR REJECT MONUMENT.

D) Describe any material discrepancy between the location of the corner as restored or reestablished and the location of that corner as previously restored or reestablished by distance and direction. Show the discrepancy on the plan view drawing under (a), above. Show the distances between the corner as previously restored or reestablished and (1) the corner as restored or reestablished, and (2) to at least 4 of the witness monuments shown on the drawing in (a), above.

(E) Was the corner reestablished through lost corner proportionate methods? If so, show the method, including the directions and distances to other public land survey corners used as evidence or used for proportioning the corner location.

I, Donald Barnes, hereby certify that the corner points as identified by the corner code index were, in a field survey on, OCTOBER 14, 1991, established, re-established, monumented, re-monumented, recovered or restored as expressed below and in conformance with the regulations and rules as required in the current manual of survey instructions of the United States Department of Interior, Bureau of Land Management.

COUNTY SURVEYOR FILING DATA

Date of computer entry _____

Date microfilmed _____

Number of included sheets _____
CORNER CODE

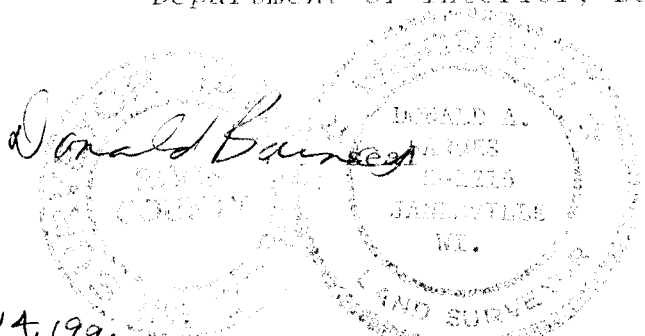

1054, 1991 AFFIX YOUR LAND SURVEYOR SEAL

C8