

U.S. PUBLIC LAND SURVEY MONUMENT RECORD

For Public Land Survey Corners in the

T. 2 N., R. 10 E.

CORNER CODE INDEX

	1	2	3	4	5	6	7	8	9	10	11	12	13	14	15	16	17	18	19	20	21	22	23	24	25
A																									
B																									
C																									
D																									
E																									
F																									
G																									
H																									
I																									
J																									
K																									
L																									
M																									
N																									
O																									
P																									
Q																									
R																									
S																									
T																									
U																									
V																									
W																									
X																									
Y																									
Z																									

EXAMPLE

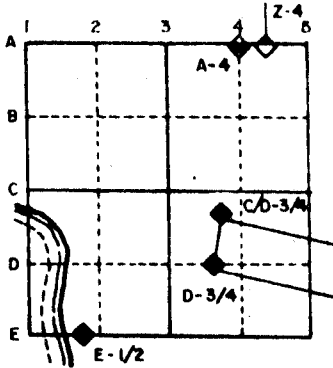

SPRING VALLEY TWP
ROCK COUNTY WI

IF AVAILABLE
STATE PLANE COORDINATES

North (Y) _____ Eleve. (Z) _____

East (X) _____ Zone _____

Hor. Datum _____ Vert. Datum _____

NAD27 230,170.77
2,189,049.62 7/17/98 DAB

PLACE MONUMENT SYMBOL (◆) AT PROPER LOCATION ON ABOVE INDEX

(a.)

◆ CORNER MONUMENT

July 1 1987

Placed poly monument

○ WITNESS MONUMENT

1/2 x 24 Pe ROD

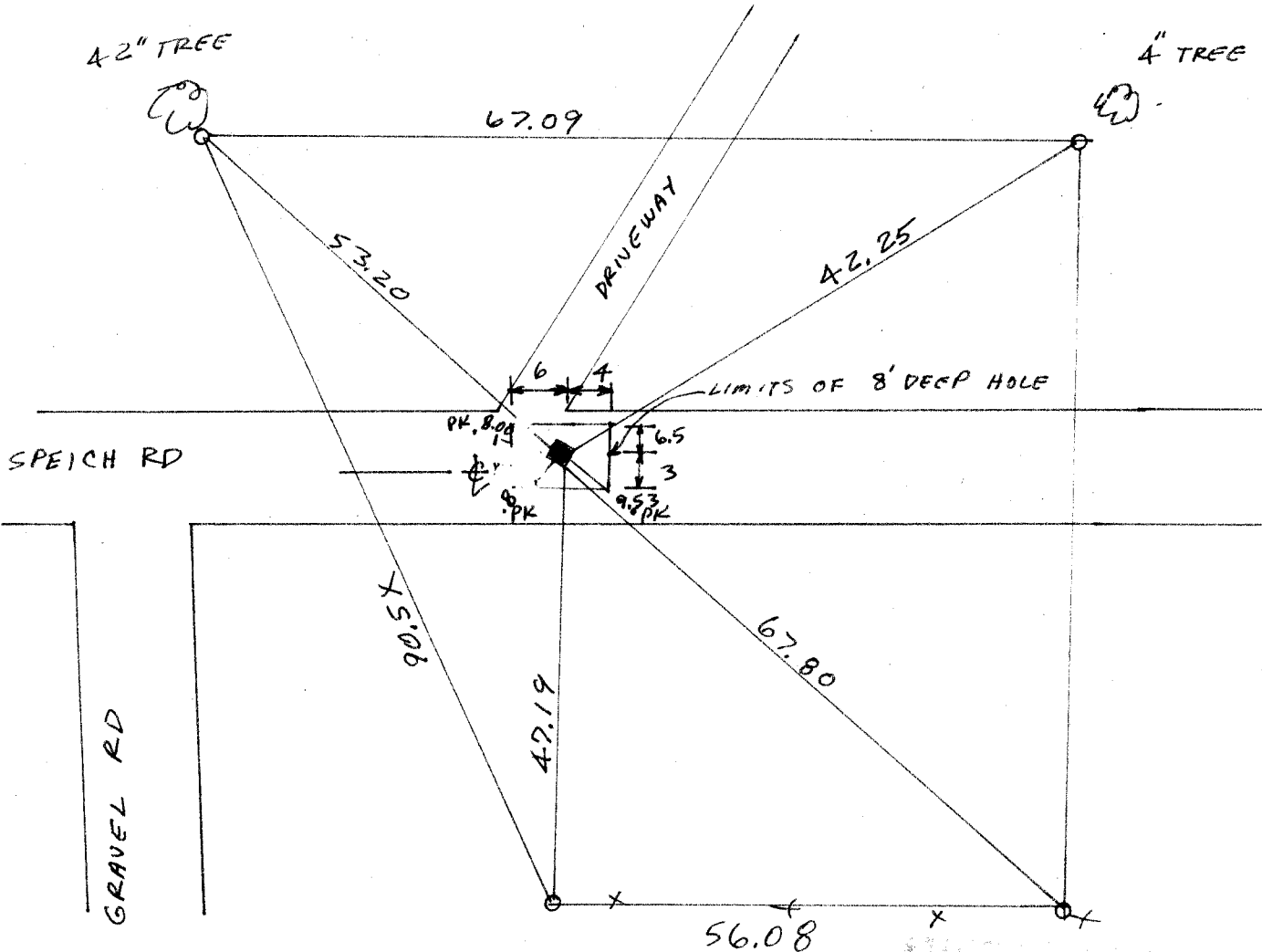

FIELD BOOK 2 PAGE # 52,55

SHOW A PLAN VIEW DRAWING DEPICTING THE CORNER MONUMENT AND SURROUNDING PHYSICAL FEATURES, INCLUDING THE EXCAVATION AREA AND DEPTH. THE CORNER MONUMENT SHALL HAVE THE FOLLOWING CHARACTERISTICS: 1) HAVE AT LEAST TWO PREDETERMINED BREAK-OFF POINTS. 2) IF BROKEN, LEAVE A PERMANENTLY MAGNETIZED REMNANT AT THE ORIGINAL POINT. 3) MUST BE EXTENDABLE. 4) THE CAP IS INSCRIBED: ROCK COUNTY SURVEY MONUMENT - PENALTY FOR DISTURBING MARKER. 5) OR AN EXISTING CUT LIMESTONE. AN IRON PIPE 1/2" x 4'0" (MINIMUM) MAY BE USED IN AREAS WHERE GROUND WATER IS WITHIN ONE FOOT OF THE SURFACE. IF THE CORNER IS OCCUPIED BY AN IMPROVEMENT (MANHOLE, BURIED CABLE, ETC.) ANY DURABLE, DISTINCT MONUMENT MAY BE USED. CORNERS SHALL BE REFERENCED WITH AT LEAST 4 DURABLE WITNESS MONUMENTS. WITNESS MONUMENTS SHALL BE MADE OF CONCRETE, NATURAL STONE, IRON OR OTHER EQUALLY DURABLE MATERIAL, EXCEPT WOOD. DESCRIBE THE CORNER AND THE WITNESS MONUMENTS.

CORNER CODE:
N 15

- (b.) Describe any record evidence, monument evidence, occupational evidence, testimonial evidence or any other material evidence you considered, and whether the monument was found or placed.
- 1857 CHURCH VOL 1 PG 69 GOVERNMENT TREES ARE NOT TO BE FOUND AND MADE CORNER BY RUNNING THE SOUTH LINE AND PLACING THE STAKE IN THE CENTER
- 1857 BROWN VOL 1 PG 72 USED CORNER FOR SMALL SURVEY TO THE EAST BUT DID NOT STATE WHAT HE FOUND OR USED.
- 1857 BROWN VOL 1 PG 7 SHOWS DISTANCE ALONG THE NORTH LINE OF SECTION 15 BUT STATES NOTHING ABOUT THE CORNER
- 1874 RUGER VOL 2 PG 176 FOUND CORNER ESTABLISHED BY LOCKE. STAKE SURROUNDED BY 3 LIMESTONES. DISTANCE TO S.W. B.T. STUMP 135 INSTEAD OF 145. COURSE TO N.W. B.T. SUMP S78°W INSTEAD OF S73W N.W. B.T. STUMP DUG UP. FOUND WHERE IT HAD BEEN
- 1876 RUGER VOL 2 PG 210 FOUND CORNER SET BY LOCKE
- 1882 RUGER VOL 2 PG 400 FOUND CORNER SET BY SELF
- 1964 BATTERMAN JR. VOL 4 PG 189 DUG LARGE HOLE & FOUND NOTHING
- 1866 LOCKE MAP IN B1 FILE. SET STAKE SURROUNDED BY 3 LIMESTONES. SHOWS THAT THE CORNER IS NOT ON LINE WITH THE SECTION CORNERS.
- FOUND 12" DEEP 1 1/4" X 24" PIPE IN OLD SOLID ROAD BED. THIS IS IN HARMONY WITH RECORD DISTANCES.
- (c.) Was the corner restored through acceptance of (1) an obliterated evidence location, or, (2) a found perpetuated location?

ACCEPTED FOUND PIPE

- (d.) Describe any material discrepancy between the location of the corner as restored or reestablished and the location of that corner as previously restored or reestablished by distance and direction. Show the discrepancy on the plan view drawing under (a), above. Show the distances between the corner as previously restored or reestablished and (1) the corner as restored or reestablished, and (2) to at least 4 of the witness monuments shown on the drawing in (a), above.
- (e.) Was the corner reestablished through lost corner proportionate methods? If so, show the method, including the directions and distances to other public land survey corners used as evidence or used for proportioning in determining the corner location.

I, Donald Barnes, hereby certify that the corner points as identified by the corner code index were, in a field survey on APRIL 27, 1987, established, re-established, monumented, re-monumented, recovered or restored as expressed below and in conformance with the regulations and rules as required in the current manual of survey instructions of the United States Department of Interior, Bureau of Land Management.

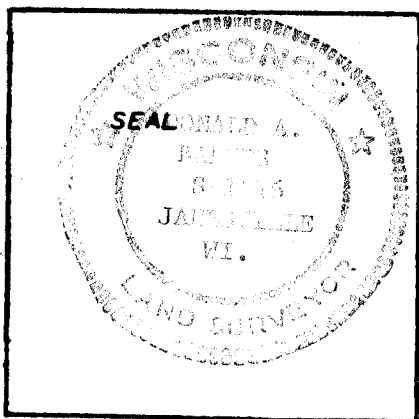

COUNTY SURVEYOR FILING DATA

Date of Computer Entry _____

Date Received _____

Date Microfilmed _____

Treasurer's Receipt No. _____

Number of Included Sheets _____

AFFIX YOUR LAND SURVEYOR SEAL. CORNER CODE N15