

PLAT AND RECORD

Of a Survey on Section 14 T 2 R 10 E. of the 4 P. M. in Spring Valley Township
 Rock County, Wisconsin, made March the 25th & 26th 1857

I hereby certify that the following is a correct record of said survey as made by me.

COUNTY BUILDING
 IN CITY OF БЕЛОIT

(Signed) Joseph Church
JAC County Surveyor.

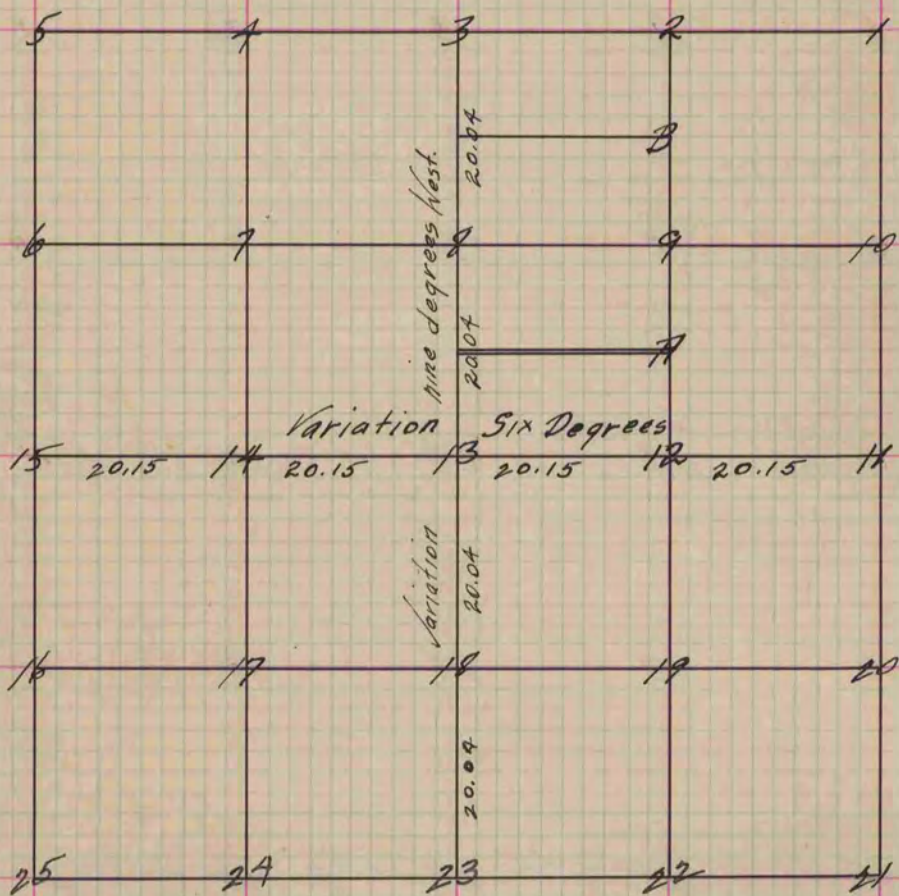

Fig. 13 B. & O. 20 S. $10\frac{1}{2}$ E. 73
 14 N. 88 E. 74
 " 12 28 S. 60 W. $59\frac{1}{2}$
 " 2 B. & O. 14 N. $25\frac{1}{4}$ E. 78
 10 S. $41\frac{1}{2}$ E. 100
 " 9 W. O 20 N. $1\frac{1}{2}$ E. 25
 20 S. $49\frac{1}{2}$ E. $51\frac{3}{4}$
 Letter A. W. O 12 S. 78 E. 89
 " " 10 N. 20 W. 37
 Variation of the Compass - nine degrees.

Copied from Page 69 Vol. 1 Original County Surveyors Record.