

PLAT AND RECORD

Of a Survey on Section 3 T 2 R 11 E. of the 4 P. M. in Plymouth Township

Rock County, Wisconsin, made May the 29 1855

COUNTY BUILDING
IN CITY OF БЕЛОIT

I hereby certify that the following is a correct record of said survey as made by me.

(Signed) Joseph Church
J. C.

County Surveyor.

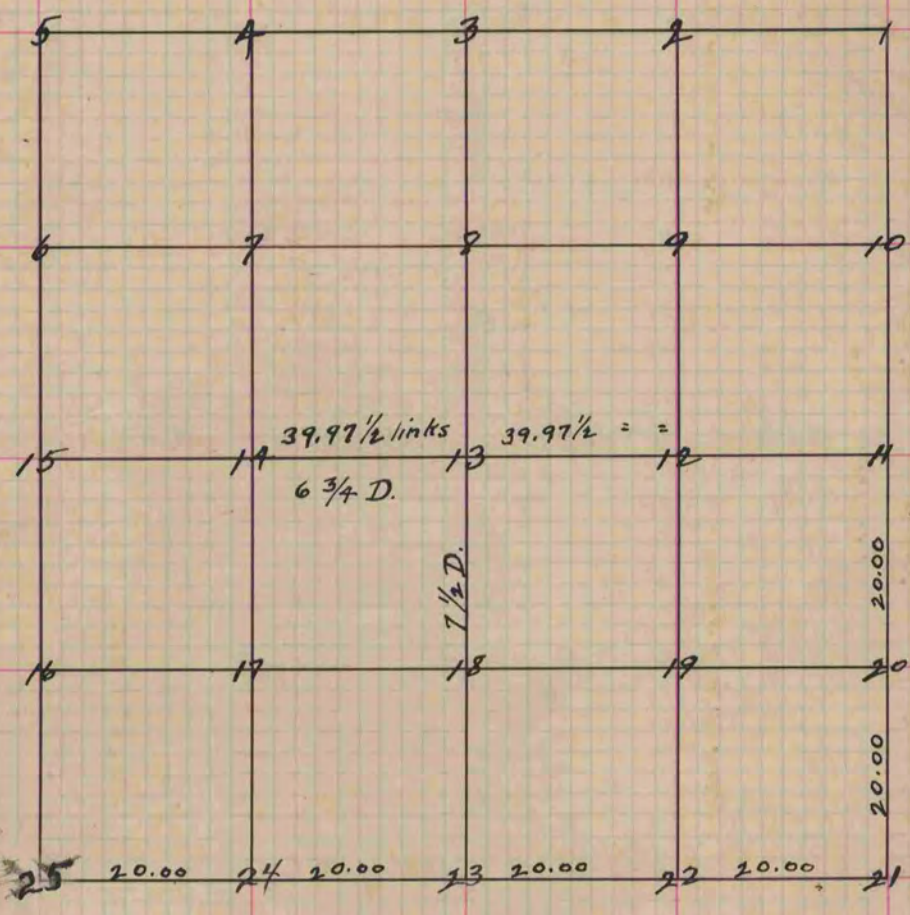

9.095
66
54570
34570
600,270

- Fig. 22 Bass wood four inches N. 66 E. 176 links.
- Black Walnut four inches N. 20 E. 81 "
- " 20 Stone 20 long 4 inches thick.
- " 11 Stone 18 inch long 4 inches thick Locust 45.5 W. 909 1/2 links.
- Yellow Oak 16 N. 13 W. 543

33258
35238

Copied from Page 40 Vol. 1 Original County Surveyors Record.