

PLAT AND RECORD

Of a Survey on Section 18 T 3 R 10 E. of the 4 P. M. in Magnolia Township
 Rock County, Wisconsin, made December the 21st 1855

I hereby certify that the following is a correct record of said survey as made by me.

COUNTY BUILDING
 IN CITY OF BELOIT

(Signed) Joseph Church
 County Surveyor.

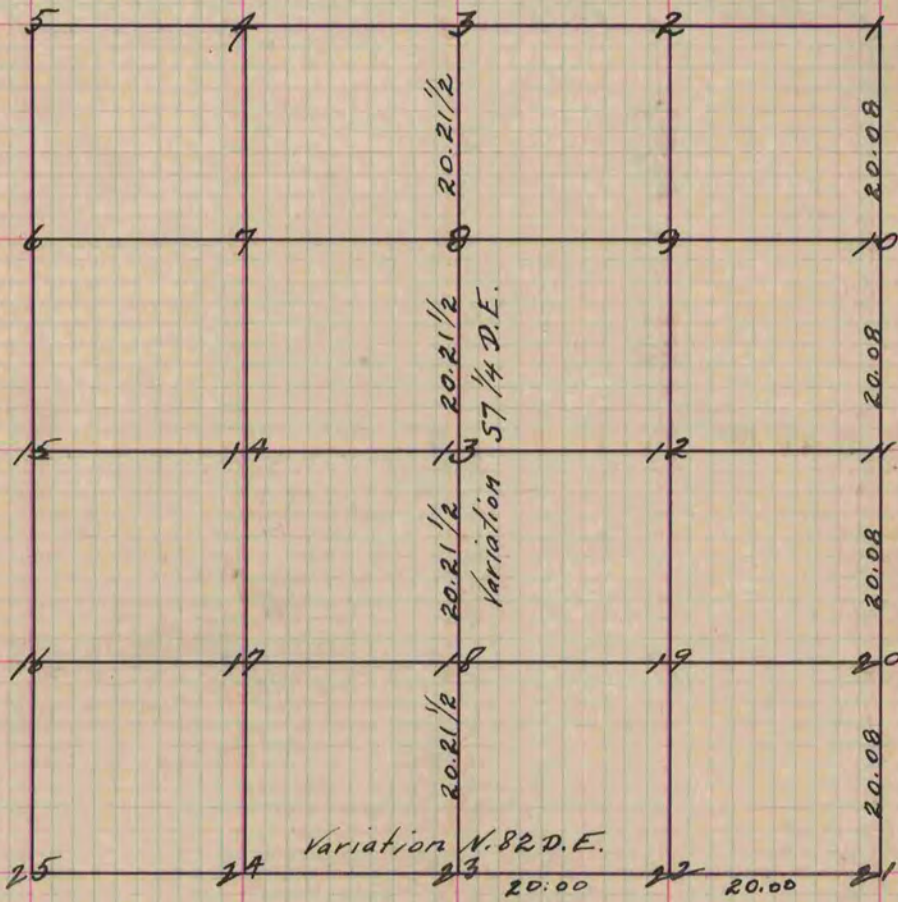

- Fig. 13 Centre of Sec. Wit. Br. O. 12 N. 36 E. 26 c
 245.79 1/2 W. 126 1/2 c
- Fig. 11 No bearing ^{tree} made corner. Wit. to corner Br. O. 18 N. 18 1/2 W. 69
 Stone school house N.W. Corner 52 1/2 E. 145
- Fig. 17 Bro. O. 12 N. 29 W. 91 Br. O. Stump 16 N. 24 W. 34 1/2 E.
- " 10 Bro. O. 16 N. 86 W. 17 1/2 Br. O. 12 S 32 W. 20 1/2
- " 7 W. O. 20 N. 56 E. 53 W. O. 18 N. 1 1/2 W. 57 1/2 c

Copied from Page 56 Vol. 1 Original County Surveyors Record.