

# PLAT AND RECORD

Of a Survey on Section 29 T 2 R 10 E. of the 4 P. M. in Spring Valley Township  
 Rock County, Wisconsin, made April the 10<sup>th</sup> 1855

I hereby certify that the following is a correct record of said survey as made by me.

COUNTY BUILDING  
 IN CITY OF BELOIT

(Signed) Joseph Church  
 R.H.B. County Surveyor.

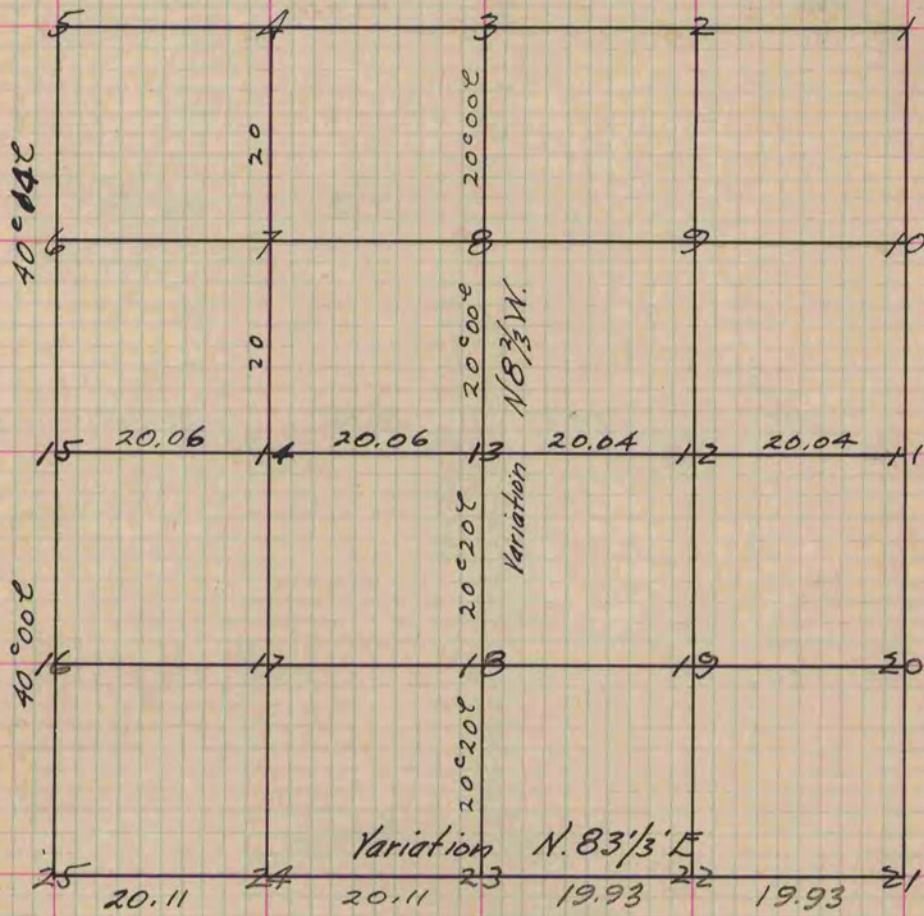

The above Survey was taken with or the bearing trees with the variations off of the Compass. Fig. 13 represents the Centre of Sec.

B.I.O. 8 S. 30 1/2 W. 183 links Stake

|          |         |    |              |     |   |   |
|----------|---------|----|--------------|-----|---|---|
| Fig. 14. | Bur. 0. | 16 | N. 87 E.     | 287 | " | " |
| " 18     | " "     | "  | N 19 W.      | 583 | " | " |
| " 21     | " "     | 16 | N. 23 W.     | 25  | " | " |
| "        | "       | "  | N. 13 E.     | 30  | " | " |
| " 22     | W. 0.   | 20 | S. 65 1/2 W. | 110 | " | " |
| " 24     | Bur 0.  | 16 | S. 8 E       | 130 | " | " |

Copied from Page 34 Vol. 1. Original County Surveyors Record