

U.S. PUBLIC LAND SURVEY MONUMENT RECORD

For Public Land Survey Corners in:

WI ADMINISTRATIVE CODE A-E 7.08 REQUIREMENT

T. 3N., R. 1AE

CORNER CODE INDEX

JOHNSTOWN TWP

ROCK COUNTY WI

IF AVAILABLE
ROCK COUNTY COORDINATES PREFERRED

A	1	2	3	4	5	6	7	8	9	10	11	12	13	14	15	16	17	18	19	20	21	22	23	24	25
B																									
C	6						5					4					3						2		1
D																									
E																									
F																									
G	1						8					9				10						11		12	
H																									
I																									
J																									
K																									
L	18						11					16				15						14		13	
M																									
N																									
O																									
P	19						20					21				22						23		24	
Q																									
R																									
S																									
T	30						29					28				27						26		25	
U																									
V																									
W																									
X	31						32					33				34						35		36	
Y																									
Z																									

PLACE MONUMENT SYMBOL AT PROPER LOCATION ON ABOVE INDEX

North _____ Elev. _____

East _____

Hor. Datum _____ Vert. Datum _____

LATITUDE _____ ELLIPS. HT. _____

LONGITUDE _____

GPS (X) _____ TRAVERSE (X) _____

BASED ON THE FOLLOWING CONTROL:

CORNER MONUMENT

WITNESS MONUMENT

(a)

BEARINGS ARE BASED ON:

FIELD BOOK _____ PAGE # _____

SHEET 1 OF 2

SHOW A PLAN VIEW DRAWING DEPICTING THE CORNER MONUMENT AND SURROUNDING PHYSICAL FEATURES, INCLUDING THE EXCAVATION AREA AND DEPTH.

PLANNING & ZONING COMMITTEE ADOPTED THE ABOVE FORM ON 12/2/1982

CORNER CODE X-15

J08617

(B) Describe any record evidence, monument evidence, occupational evidence, testimonial evidence or any other material evidence you considered, and whether the monument was found or placed.

1864 LOCKE VOL 1 PG 221 STATES NOTHING ABOUT MONUMENT. 2650.89' TO E & W ¼ CORNERS; {SET EQUAL DISTANCE ON E/W ¼ LINE}

1940 SUNNY VOL 3 PG 461 FOUND LIMESTONE. SET 1 ½" CAPPED PIPE ON TOP & REFERENCED SAME.

FOUND R/R SPIKE & REFERENCED SAME. PAVEMENT SURFACE WILL BE GROUND OFF AND ROAD REPAVED.

C) Was the corner restored through acceptance of (1) an obliterated evidence location, or, (2) a found perpetuated location?

DID NOT ACCEPT NOR REJECT MONUMENT.

D) Describe any material discrepancy between the location of the corner as restored or reestablished and the location of that corner as previously restored or reestablished by distance and direction. Show the discrepancy on the plan view drawing under (a), above. Show the distances between the corner as previously restored or reestablished and (1) the corner as restored or reestablished, and (2) to at least 4 of the witness monuments shown on the drawing in (a), above.

(E) Was the corner reestablished through lost corner proportionate methods? If so, show the method, including the directions and distances to other public land survey corners used as evidence or used for proportioning the corner location.

I, Donald Barnes, hereby certify that the corner location as identified by the corner code index was determined by me under my direction and control and that this U.S. Public Land Survey Monument Record is correct and complete to the best of my knowledge and belief.

seal

Donald Barnes
Oct 26 2000
emboss

Number of included sheets 1

CORNER CODE X-15

A-E 7.08 REQUIREMENT

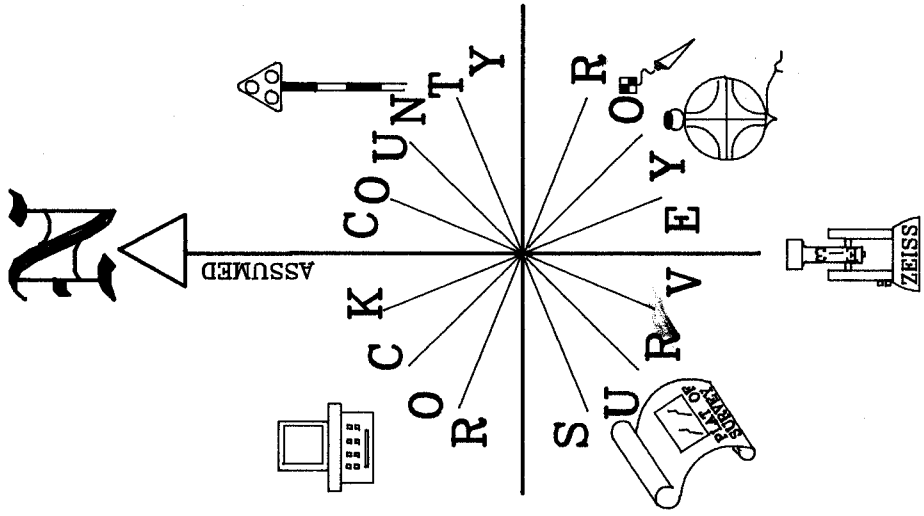

POSSIBLE CENTER OF SEC 34
JOHNSTOWN TWP
T3R R14E

● FD R/R @
PVMT SURFACE

○ 3/4X24" REROD/CAP

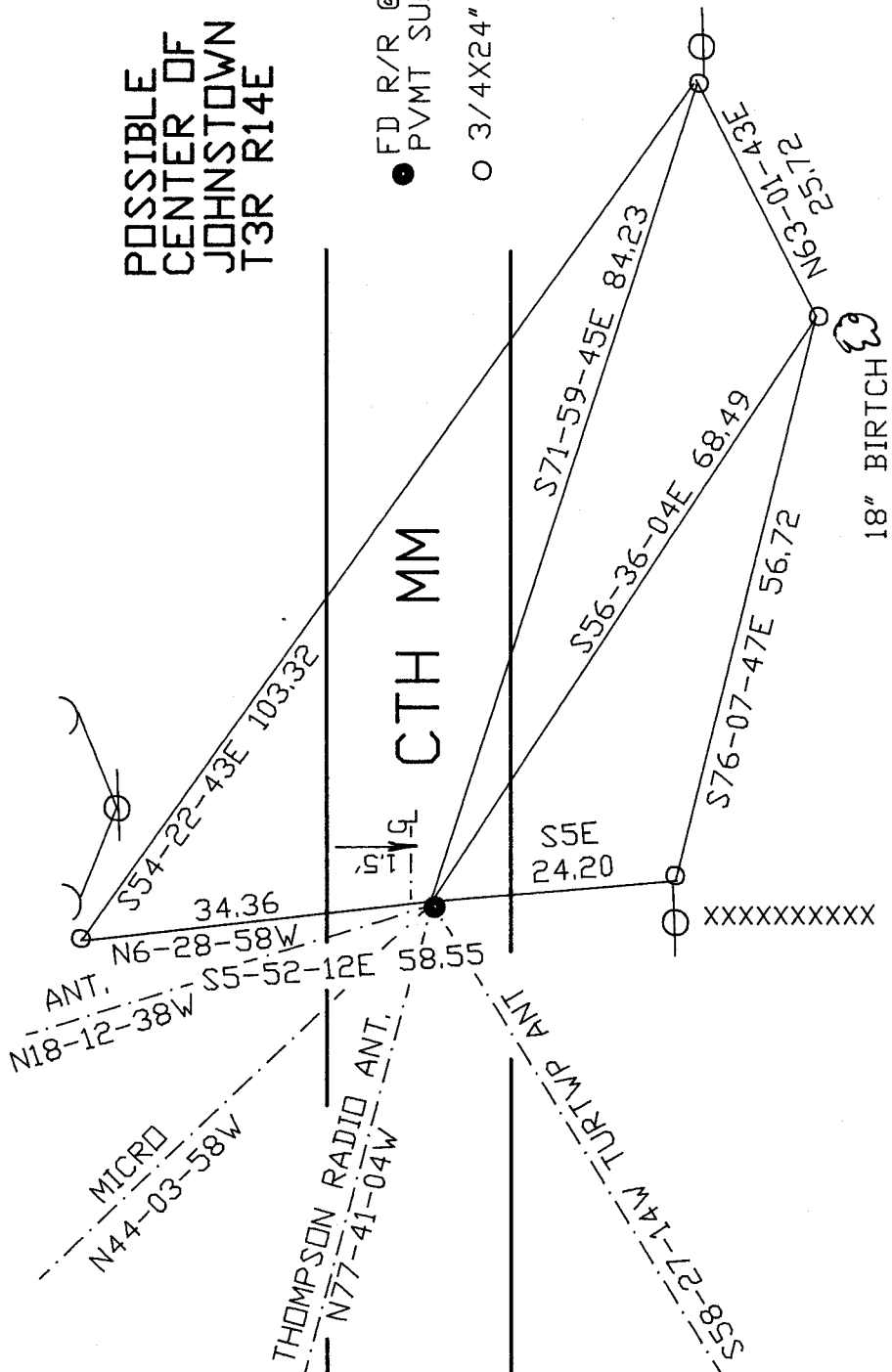

Donald Barnes
EMBOSSED SEAL
OCT 26 2000

X 15