

Paper weight-110# (minimum)

Black nonfading ink required

# U.S. PUBLIC LAND SURVEY MONUMENT RECORD

For Public Land Survey Corners In:  
T. 4 N. R. 11 E. 4th P.M.  
CORNER CODE INDEX

WI ADMINISTRATIVE CODE A-E 7.08 REQUIREMENT  
REV 10/23/2004 USMONREC.DWG

PORTER TWP  
ROCK COUNTY WI

IF AVAILABLE  
ROCK COUNTY COORDINATES PREFERRED

North \_\_\_\_\_ Elev. \_\_\_\_\_

East \_\_\_\_\_

Hor. Datum \_\_\_\_\_ Vert. Datum \_\_\_\_\_

LATITUDE \_\_\_\_\_ ELLIPS. HT. \_\_\_\_\_

LONGITUDE \_\_\_\_\_

NAD83(91) \_\_\_\_\_ NETWORK ADJ. YR \_\_\_\_\_

GPS (X) \_\_\_\_\_ TRAVERSE (X) \_\_\_\_\_

BASED ON THE FOLLOWING CONTROL:  
\_\_\_\_\_

	1	2	3	4	5	6	7	8	9	10	11	12	13	14	15	16	17	18	19	20	21	22	23	24	25		
A																											A
B																											B
C																											C
D																											D
E																											E
F																											F
G																											G
H																											H
J																											J
K																											K
L																											L
M																											M
N																											N
O																											O
P																											P
Q																											Q
R																											R
S																											S
T																											T
U																											U
V																											V
W																											W
X																											X
Y																											Y
Z																											Z

PLACE MONUMENT SYMBOL  AT PROPER LOCATION ON ABOVE INDEX

CORNER MONUMENT

WITNESS MONUMENT

BEARINGS ARE BASED ON:-----

FIELD BOOK \_\_\_\_\_ PAGE # \_\_\_\_\_

SHEET 1 OF 3

SHOW A PLAN VIEW DRAWING DEPICTING THE CORNER MONUMENT AND SURROUNDING PHYSICAL FEATURES, INCLUDING THE EXCAVATION AREA AND DEPTH.

PLANNING & ZONING COMMITTEE ADOPTED THIS FORM ON 12/2/1982

CORNER CODE Z-5

**PO623 SECSEC31**

*(B) Describe any record evidence, monument evidence, occupational evidence, testimonial evidence or any other material evidence you considered, and whether the monument was found or placed.*

**1833 (SEP 15) MULLETT & BRINK T4N R11E 4<sup>TH</sup> MERIDIAN WEST  
ON SOUTH SIDE SEC 32**

- 2640.0 SET QUARTER SECTION POST BURR OAK 14  
N24E 8.58'; BUR OAK 8 N81W 21.12'**
- 3663.0 ENTER WET PRAIRIE**
- 5280.0 SET POST CORNER SECTIONS 31 & 32 BUR  
OAK 12 N41E 74.58'; BUR OAK 6 N11W 11.22'  
LAND & SAME AS LAST MILE**

**1833 (SEP 15) MULLETT & BRINK T4N R11E 4<sup>TH</sup> MERIDIAN WEST  
ON SOUTH SIDE SEC 31**

- 2640.0 SET QUARTER SECTION POST IN PRAIRIE AND  
MADE A MOUND.**
- 5227.20 INTERSECTED RANGE LINE 118.80' SOUTH OF  
TEMPORARY POST. SET POST AT  
INTERSECTION CORNER TOWNSHIP 3 & 4  
NORTH RANGES 10 & 11 EAST AND MADE A  
MOUND 4 FEET SQUARE AT BASE AND 4 FEET  
HIGH.**

**1833 HARRISON (NOV) T4N R11E 4<sup>TH</sup> MER. NORTH  
BET. 31 & 32**

- 1524.6 BURR OAK 12 IN DIAM.**
- 2381.28 TRAIL N.E.**
- 2640.0 QUARTER SEC COR  
{BURR OAK 10 N88E 29.70'; BURR OAK 20  
N65E 85.80' {BURR OAK 10; BURR OAK  
20} MARKED**
- 4072.86 BURR OAK 12 IN DIAM**
- 5280.0 SET POST FOR COR TO SEC 29,30,31,32  
{BURR OAK 12 S8W 52.14'; BURR OAK 12  
N68E 38.28'; BURR OAK 10 N42W 93.06';  
BURR OAK 14 S44E 123.42'  
LAND ROLLING 2<sup>ND</sup> RATE WITH RED & BURR  
OAK TIMBER**

**1833 HARRISON T3N R11E 4<sup>TH</sup> MER NORTH BET SECS 5 & 6**

- 1848.0 LEAVE MARSH & ENTER TIMBER**
- 2640.0 SET QUARTER SEC COR. BLK OAK 12 N25E  
174.24'; BLACK OAK 16 N13W 280.5'**
- 3498.0 LEAVE ISLAND OF TIMBER ENTER MARSH**
- 4975.08 LEAVE MARSH & INTER. NORTH BDY 7.92'  
WEST OF POST {BURR OAK 8 S60E 67.32';  
BURR OAK 8 S52W 69.30' LAND MOSTLY??**

**1874 RUGER VOL 2 PG 165 & #3652 FD REMAINS OF OLD STAKE  
& WHERE STUMPS OF SE BT BELONGING TO NE. COR SEC 6  
CENTER TWP, HAD BEEN DUG UP AT COR FOR PORTER  
DROVE STAKE DEEP & PUT ON TOP OF IT HH STONE  
26X12X9 POINT UP. AT NE COR SEC 6 CENTER TWP DROVE  
STAKE & SURROUNDED IT WITH SMALL STONES. VAR 7-25  
2659.80 TO SEC 32, VAR 7-25 1327.70 TO FLINTSTONE  
25X12X5 POINT UP @ S 1/16TH COR OF SE 1/4 SEC 31,  
VAR 7-25 2655.39 TO S 1/4 COR SEC 31. CORNER IS ON  
LINE WITH SW COR SEC 31 & S 1/4 COR SEC 32. AT E 1/4  
COR SEC 31 DROVE STAKE DEEP & PUT ON TOP OF IT HH  
STONE 15X10X8 & SURROUNDED IT BY 4 HH STONES. VAR  
7-15 2667.06 TO NW & VAR 7-15' 2667.06 TO SW CORNERS  
OF SEC 32. VAR INDICATES THE W 1/4 COR WAS PLACED  
MIDWAY & ON LINE WITH NW & SW CORNERS OF SEC 32**

**1875 RUGER VOL 2 PG 184 7.92' EAST OF NW COR SEC 5 CENTER  
TWP, 2659.80 TO S 1/4 COR SEC 32.**

**1875 RUGER VOL 2 PG 185 & #702 SEE PG 121 7.92' EAST OF  
NW COR SEC 5.**

**1900 BROWN VOL 2 PG 520 & #6518 FD STAKE STONES @ NE  
COR SEC 6 CENTER TWP, 2642.64 TO N 1/4 COR SEC 6,  
5257.56 TO FD MON @ NW COR SEC 6.**

*Donald Baues*

6-9-2009

- 1902 KERCH VOL 3 PG 15 FD STONE 26X12X9 SET BY RUGER 7.8X' EAST OF STAKE SURROUNDED BY STONE @ NE COR SEC 6. 1329.1X TO FD STAKE SURROUNDED BY STONE @ S 1/16TH COR OF SE 1/4 SEC 31, 2657.2 FROM FD STAKE @ AT NE COR SEC 6 TO SET GAS PIPE @ N 1/4 COR SEC 6, 2596.1 FROM N 1/4 COR SEC 6 TO NW COR SEC 6.
- 1976 BARNES VOL 5 PG 181 STONE OF REC 2659.4X TO S 1/4 COR SEC 31.
- 1976 BARNES VOL 5 PG 206 FD HH POINT UP 26X12X9 783+/\_ NORTH OF CENTER OF R/R TRACKS. PLACED 2 R/R SPIKES IN HORIZONTAL POSITION ON EAST SIDE OF HH. REFERENCED SAME.
- 1983 BARNES VOL 6 PG 305 FD REC HH @ SW COR SEC 32. SHOWS NB9-25-12E 2662.96 TO S 1/4 COR SEC 32 PORTER TWP & EAST OF NW COR SEC 5.
- 1993 KARNs #10028 & #10027 STATES NOTHING ABOUT MON. SB9-16-30W 7.80 TO NE COR SEC 6, N00-27-20W 2651.62 TO E 1/4 COR SEC 31, FROM NE COR SEC 6 S00-28-09E 730.96 ALONG SEC LINE OF SEC 6 TO THE NORTH R/R R/W. CALLS FOR THE E 1/4 COR SEC 31 AS S0-18-13E 473.05 FROM A SET PIN ON THE SOUTH R/W LINE OF STH 14.
- 1995 BARNES VOL 6 PG 441 FD ALUM MON. NB9-16-09W 7.79 TO NW COR SEC 5. SB9-15-59W 2658.86 TO S 1/4 COR SEC 31.
- 1995 BARNES A-3 THE POSITION OF THE N 1/4 COR SEC 6 IS IN THE DRAINAGE DITCH. I DID NOT PLACE A MONUMENT. ESTABLISHED CORNER PER ORIG PLAT DISTANCE JOG OF 7.92'. THIS IS IN HARMONY WITH KERCH'S DISTANCES AND BROWN'S DISTANCES IF ONE ASSUMES BROWN COMPUTED THE DISTANCES WITH THE JOG ON THE WRONG SIDE OF THE S 1/4 COR SEC 31. REFERENCED SAME. NB9-15-43E 2659.00 TO NE COR SEC 6, SB9-13-01W 2597.07 TO NW COR SEC 6, NB9-13-01E 7.92 TO S 1/4 COR SEC 31 PORTER TWP.

FD REF. MONUMENTS & HH OF REC WITH CARSONITE ON EAST SIDE OF HH. PLACED 2 MAGNETS 1.1' ON SOUTH SIDE OF HH.

C) Was the corner restored through acceptance of (1) an obliterated evidence location, or, (2) a found perpetuated location?

ACCEPTED FD HH

D) Describe any material discrepancy between the location of the corner as restored or reestablished and the location of that corner as previously restored or reestablished by distance and direction. Show the discrepancy on the plan view drawing under (a), above. Show the distances between the corner as previously restored or reestablished and (1) the corner as restored or reestablished, and (2) to at least 4 of the witness monuments shown on the drawing in (a), above.

(E) Was the corner reestablished through lost corner proportionate methods? If so, show the method, including the directions and distances to other public land survey corners used as evidence or used for proportioning the corner location.

I, Donald Barnes, hereby certify that the corner location as identified by the corner code index was determined by me under my direction and control and that this U.S. Public Land Survey Monument Record is correct and complete to the best of my knowledge and belief.

Seal  
  
 Emboss  
 6-9-2009

SHEET 2 OF 3

CORNER CODE **Z-5**

A.E. 7.08 REQUIREMENT

SE COR  
SEC 31  
PORTER TWP  
T4N R11E

1976 BARNES VOL 5 PG 206  
OBSERVATION SHEET #1004

□ SE COR SEC 31 FD HH  
OF REC.; 1.5' W  
OF N/S FENCE;  
CARSONITE ON EAST  
SIDE OF HH;  
PLACED 2 MAG. ON  
EAST SIDE.

◇ NE COR SEC 6  
CENTER TWP.  
DID NOT SET  
A MON.

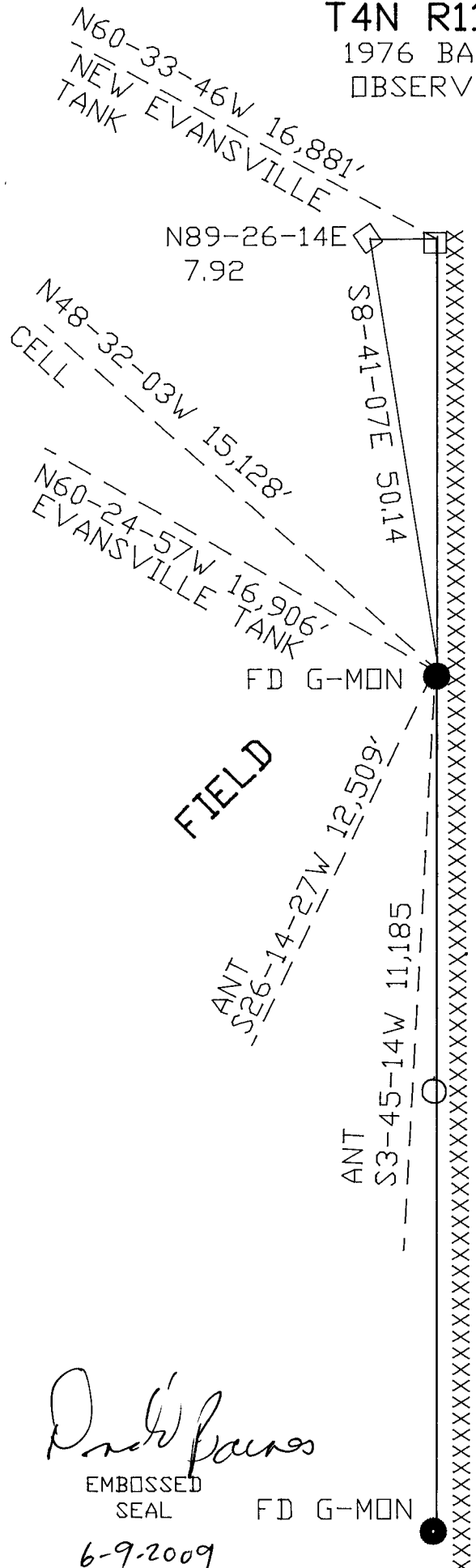

FIELD

FIELD

NE COR  
SEC 6  
CENTER TWP  
T3N R11E

*D. Barnes*  
EMBOSSSED  
SEAL  
6-9-2009

FD G-MON

SHEET 3 OF 3

Z-5