

U.S. PUBLIC LAND SURVEY MONUMENT RECORD

For Public Land Survey Corners in the
T. 2 N., R. 11 E.

CORNER CODE INDEX

	1	2	3	4	5	6	7	8	9	10	11	12	13	14	15	16	17	18	19	20	21	22	23	24	25
A																									
B																									
C	6																								
D																									
E																									
F																									
G	7																								
H																									
J																									
K																									
L	18																								
M																									
N																									
O																									
P	19																								
Q																									
R																									
S																									
T	30																								
U																									
V																									
W																									
X	31																								
Y																									
Z																									

PLACE MONUMENT SYMBOL (◆) AT PROPER LOCATION ON ABOVE INDEX

EXAMPLE

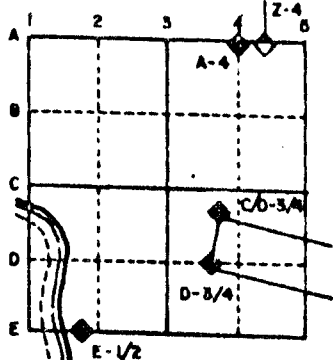

PLYMOUTH TWP
ROCK COUNTY WI

IF AVAILABLE
STATE PLANE COORDINATES

North (Y) _____ Eleve. (Z) _____
 East (X) _____ Zone _____
 Hor. Datum _____ Vert. Datum _____

◆ CORNER MONUMENT

○ WITNESS MONUMENT

BEARINGS ARE BASED ON: ROCK TWP PROJ.

SEE BACK

3/4X24 REROD
WITH ORANGE PLASTIC
CAP

3/4X24 REROD
WITH ORANGE PLASTIC
CAP

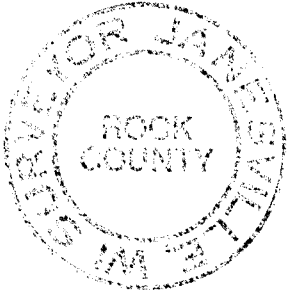

FIELD BK# 3 PG 34

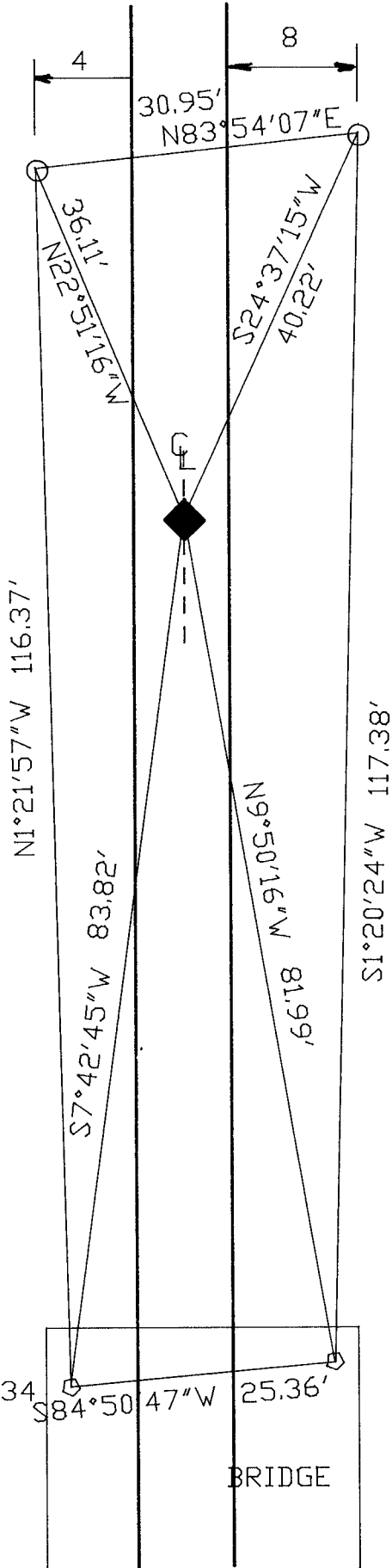

◇ DRILL HOLE IN
IN CONCRETE OPPOSITE
STEEL VERTICAL BEAM

◆ FOUND CUT LIMESTONE

(B) Describe any record evidence, monument evidence, occupational evidence, testimonial evidence or any other material evidence you considered, and whether the monument was found or placed.

1833 MULLETT ORIGINAL GOVERNMENT SURVEYOR. FIELD NOTES - NORTH ON EAST SIDE OF SECTION 24 PLYMOUTH TOWNSHIP. 2620.2 STREAM 75 C SE. 2640 SET QUARTER SECTION POST IN CREEK.

1868 LOCKE PLYMOUTH TOWNSHIP REMONUMENTATION PROJECT. NORTH ON EAST LINE OF SECTION 24. AT 2640 SET TEMPORARY 1/4 CORNER. CORNER LOST. 1363.89 TO CENTER OF R/R TRACKS. SET PERMANENT 1/4 CORNER 7.92' NORTH AND 3.63' WEST OF TEMPORARY CORNER. CORNER ABOUT 2 RODS EAST AND 2 RODS NORTH OF CREEK. SURROUND MONUMENT WITH MOUND OF TUSSACKS. VAR 7-30. PLACED CUT LIMESTONE.

1883 LEE VOL 2 PG 365 FOUND STONES AND STAKE AT EAST SIDE OF BASS CREEK.

1892 BLEEDORN. VOL 2 PG 466 FOUND MONUMENT. SHOWS 2665.08 TO CENTER OF SECTION 24 PLYMOUTH TOWNSHIP AND 2645.28 TO SE CORNER OF SECTION 24.

1982 BARNES VOL 6 PG 282 SHOWS RECORD DISTANCES.

DUG AND FOUND CUT LIMESTONE AT CENTER OF PAVEMENT. STONE IS 5' DEEP AND JUST BELOW OLD ROAD BED. PLACED MAGNET BY LIMESTONE. BROKE TOP OF THE STONE OFF WITH BACKHOE. THE STONE IS 5.16 EAST OF A LINE BETWEEN THE SW AND NW CORNERS OF SECTION 19.

(C) Was the corner restored through acceptance of (1) an obliterated evidence location, or, (2) a found perpetuated location?

ACCEPTED FOUND PERPETUATED LOCATION.

(D) Describe any material discrepancy between the location of the corner as restored or reestablished and the location of that corner as previously restored or reestablished by distance and direction. Show the discrepancy on the plan view drawing under (a), above. Show the distances between the corner as previously restored or reestablished and (1) the corner as restored or reestablished, and (2) to at least 4 of the witness monuments shown on the drawing in (a), above.

(E) Was the corner reestablished through lost corner proportionate methods? If so, show the method, including the directions and distances to other public land survey corners used as evidence or used for proportioning the corner location.

I, Donald Barnes, hereby certify that the corner points as identified by the corner code index were, in a field survey on, October 2, 1990, established, re-established, monumented, re-monumented, recovered or restored as expressed below and in conformance with the regulations and rules as required in the current manual of survey instructions of the United States Department of Interior, Bureau of Land Management.

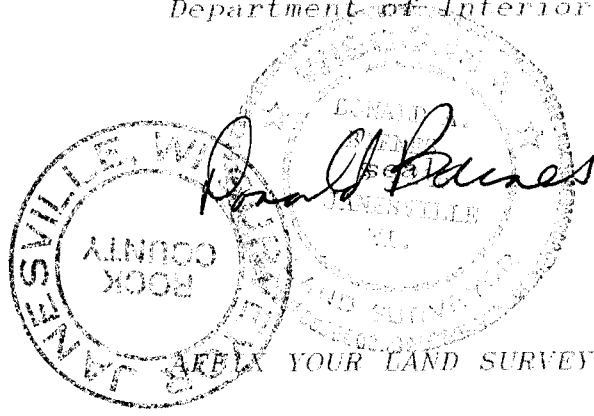

COUNTY SURVEYOR FILING DATA

Date of computer entry _____

Date microfilmed _____

Number of included sheets 1
CORNER CODE

P25